

**SOIL/SITE EVALUATION**  
**for ON-SITE WASTEWATER SYSTEM**

Owner: GALT Applicant:

Address: 129 Mahogany Ct

Proposed Facility: SFD

Location of Site:

Water Supply:

Evaluation Method:  Auger Boring

Type of Wastewater:

Date Evaluated:

Design Flow (.1949): 480 GPD

Property Recorded:

- Public  Individual  Well  Spring  Other  
 Pit  Cut  
 Industrial Process  Mixed

Property Size:

P R O F I L E #	.1940 Landscape Position/ Slope %	Horizon Depth (In.)	SOIL MORPHOLOGY .1941		OTHER PROFILE FACTORS				Profile Class & LTAR
			.1941 Structure/ Texture	.1941 Consistence Mineralogy	.1942 Soil Wetness/ Color	.1943 Soil Depth (IN.)	.1956 Sapro Class	.1944 Restr Horiz	
1	L	0-30	LS	Fr	10YR6/1	>48"	—	—	S.4
	5-7%	30-48	SCI	Fi	≥36"				
2	L	0-24	LS	Fr	10YR6/1	>48"	—	—	S.4
	5-7%	24-48	SCI	Fi	≥38"				
3	L	0-20	LS	Fr	10YR6/1	>48"	—	—	S.4
	5-7%	20-48	SCI	Fi	≥36"				

Description	Initial System	Repair System	Other Factors (.1946): Site Classification (.1948): Evaluated By: <u>SMA REAS</u> Others Present:
Available Space (.1945)	<input checked="" type="checkbox"/>	<input checked="" type="checkbox"/>	
System Type(s)	<input checked="" type="checkbox"/>	<input checked="" type="checkbox"/>	
Site LTAR	.4	.4	

COMMENTS: \_\_\_\_\_

LANDSCAPE POSITIONS	GROUP	TEXTURES	.1955 LTAR	CONSISTENCE MOIST	WET
R-RIDGE	I	S-SAND LS-LOAMY SAND	1.2 - 0.8	VFR-VERY FRIABLE	NS-NON-STICKY
S-SHOULDER SLOPE	II	SL-SANDY LOAM L-LOAM	0.8 - 0.6	FR-FRIABLE	SS-SLIGHTLY STICKY
L-LINEAR SLOPE				FI-FIRM	S-STICKY
FS-FOOT SLOPE	III	SI-SILT SIL-SILT LOAM CL-CLAY LOAM SCL-SANDY CLAY LOAM	0.6 - 0.3	VFI-VERY FIRM	VS-VERY STICKY
N-NOSE SLOPE				EFI-EXTREMELY FIRM	NP-NON-PLASTIC
H-HEAD SLOPE					SP-SLIGHTLY STICKY
CC-CONCLAVE SLOPE	IV	SIC-SILTY CLAY C-CLAY SC-SANDY CLAY	0.4 - 0.1		P-PLASTIC
CV-CONVEX SLOPE					VP-VERY PLASTIC
T-TERRACE					
FP-FLOOD PLAN					

**STRUCTURE**  
 SG-SINGLE GRAIN  
 M-MASSIVE  
 CR-CRUMB  
 GR-GRANULAR  
 SBK-SUBANGULAR BLOCKY  
 ABK-ANGULAR BLOCKY  
 PL-PLATY  
 PR-PRISMATIC

**MINERALOGY**  
 SLIGHTLY EXPANSIVE  
 EXPANSIVE

Show profile locations and other site features (dimensions, references or benchmark, and North)

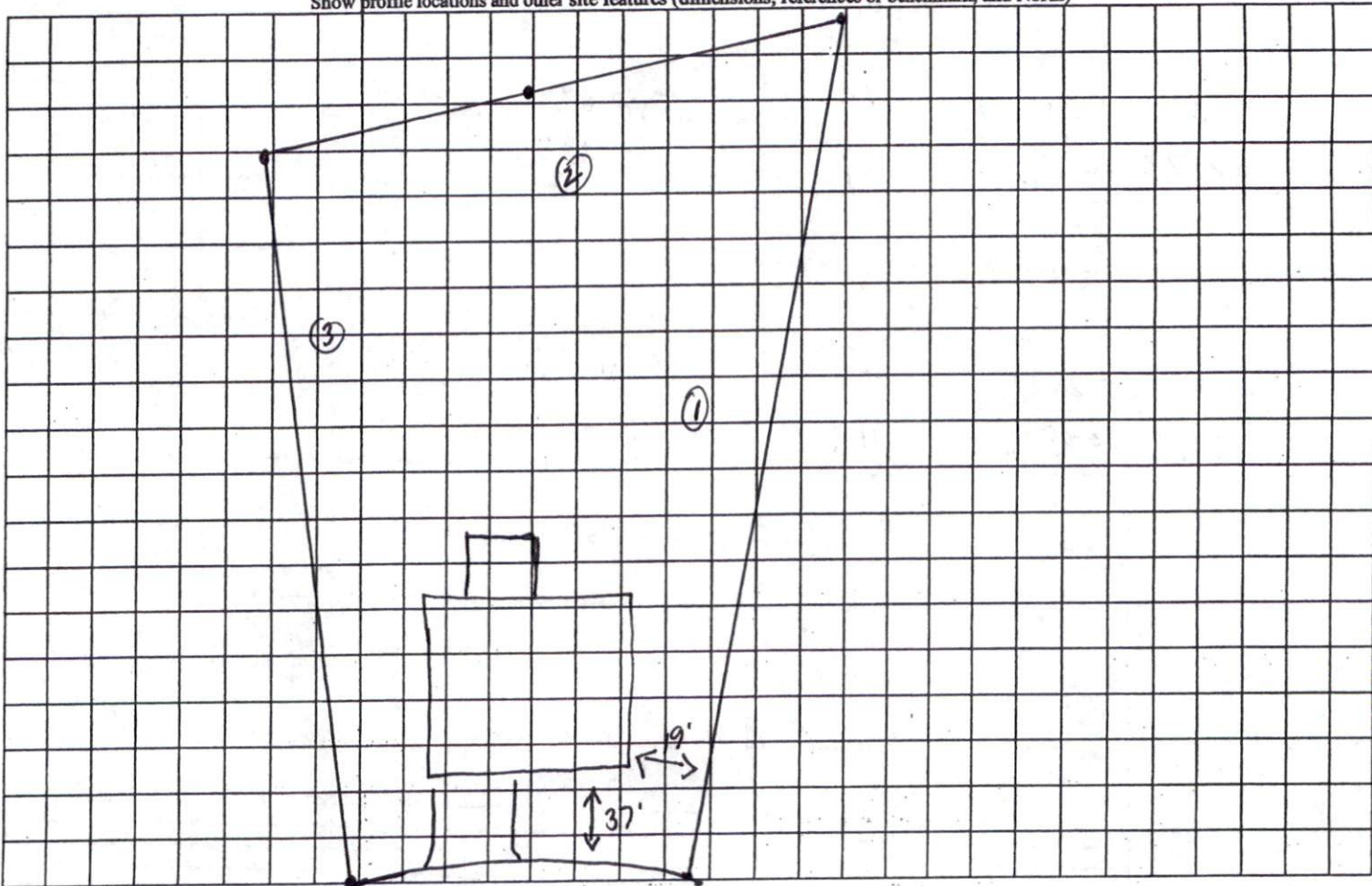

Mahogany Ct