

**PLOT PLAN FOR  
NEW HOME, INC.**  
490 DUNCAN CREEK ROAD  
LOT 154, DUNCAN'S CREEK, PHASE 1  
UPPER LITTLE CREEK TOWNSHIP, HARNETT COUNTY, NORTH CAROLINA

N\F  
JOSHUA E. & TERESA A. BRITTON  
D.B. 3662, PG. 343  
P.B. 2017, PG. 57

N\F  
JOSHUA E. & TERESA A. BRITTON  
D.B. 1479, PG. 124  
P.B. 2017, PG. 57

N\F  
DUNCANS CREEK DEVELOPMENT GROUP, LLC  
FUTURE PHASE 2  
D.B. 4183, PG. 973

B.M. 2022, PGS. 594-596

N 24°53'31" W 93.80'  
N 03°42'42" W 104.22'

154  
37,932 S.F.  
0.871 AC.

153

155

**LEGEND**

- ▣ AIR CONDITIONER
- ▣ BACK OF CURB
- ▣ BACK FLOW PREVENTER
- CLEANOUT
- ▣ CURB INLET
- DRILL HOLE SET
- ▣ EXISTING CONCRETE MONUMENT
- EXISTING DRILL HOLE
- EXISTING IRON STAKE
- EXISTING IRON PIPE
- ELECTRIC METER
- EXISTING PK NAIL
- ELECTRIC STUB
- FLARED END SECTION
- FIRE HYDRANT
- FIBER OPTIC PEDESTAL
- GAS METER
- GUY
- INVERT
- IRON PIPE SET
- IRON ROD SET
- LIGHT POLE
- MAGNETIC NAIL SET
- MANHOLE SANITARY SEWER
- MANHOLE STORM SEWER
- OVERHEAD WIRES
- PK NAIL SET
- POINT NOT SET
- RAIL ROAD SPIKE
- TELEPHONE PEDESTAL
- TRANSFORMER
- CABLE TV PEDESTAL
- UTILITY POLE
- WATER METER
- WATER VALVE
- YARD INLET
- ( ) FIELD MEASUREMENT

**SETBACK INFO**

FRONT: 35'  
REAR: 25'  
SIDES: 10'  
CORNER SIDE: 20'

**REFERENCES:**

B.M. 2022, PGS. 594-596



NOTES SCALE: 1" = 40'

1. THIS SURVEY SUBJECT TO ANY FACTS THAT MAY BE DISCLOSED BY A FULL AND ACCURATE TITLE SEARCH.
2. THIS MAP MAY NOT BE A CERTIFIED SURVEY AND HAS NOT BEEN REVIEWED BY A LOCAL GOVERNMENT AGENCY FOR COMPLIANCE WITH ANY APPLICABLE LAND DEVELOPMENT REGULATIONS AND HAS NOT BEEN REVIEWED FOR COMPLIANCE WITH RECORDING REQUIREMENTS FOR PLATS.

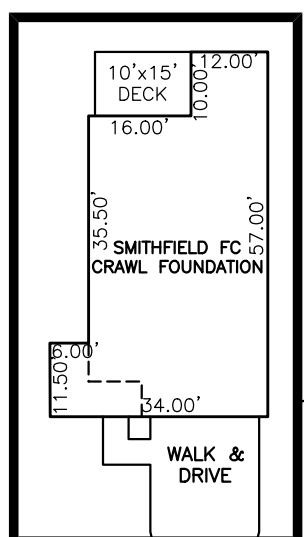

INSET SCALE: 1"=30'

| NUM | RADIUS  | ARC     | DELTA     | CHORD BRG     | CHORD   |
|-----|---------|---------|-----------|---------------|---------|
| C1  | 259.21' | 103.41' | 22°51'29" | S 13°21'47" E | 102.73' |

| IMPERVIOUS SURFACES | S.F.  |
|---------------------|-------|
| HOUSE               | 1,510 |
| WALK & DRIVE        | 600   |
| PORCH               | 150   |
| TOTAL               | 2,260 |
| PERCENT IMPERVIOUS  | 12.2% |

DUNCAN CREEK ROAD  
50' PUBLIC R/W

REV1: SEP. 23, 2024(2)  
DATE: SEP. 17, 2024

F.B. \_\_\_\_\_

**RWK, PA**  
ENGINEERING ~ SURVEYING  
CORPORATE LICENSE: C-1771  
101 W. MAIN ST., SUITE 202  
GARNER, NC 27529  
PHONE (919) 779-4854  
FAX (919) 779-4056

PLOT PLAN  
PRELIMINARY PLAT- NOT FOR RECORDATION,  
CONVEYANCE OR SALES

REV CODE: 1.FLIP, 2.PLAN, 3.ROTATE, 4.MOVE, 5.SS  
6.SEVERAL OF ABOVE, 7.LAND FEATURE, 8. OTHER