

I, SAMUEL G. FIELDS JR., CERTIFY THAT THIS PLAT WAS DRAWN UNDER MY SUPERVISION FROM AN ACTUAL SURVEY MADE UNDER MY SUPERVISION (DEED DESCRIPTION RECORDED IN REFERENCES AS SHOWN); THAT THE BOUNDARIES NOT SURVEYED ARE CLEARLY INDICATED AS DRAWN FROM INFORMATION FOUND IN REFERENCES AS SHOWN; THAT THE RATIO OF PRECISION OR POSITIONAL ACCURACY AS CALCULATED IS +10,000; THAT THIS PLAT WAS PREPARED IN ACCORDANCE WITH G.S. 47-30 AS AMENDED. WITNESS MY ORIGINAL SIGNATURE, LICENSE NUMBER AND SEAL THIS 24th DAY OF JANUARY, A.D., 2025.

PRELIMINARY PLAT
NOT FOR RECORDATION
CONVEYANCES OR SALES

SAMUEL G. FIELDS JR. NCPLS L-5631

DATE

PROPOSED IMPERVIOUS AREA:

2,821 SF HOUSE
205 SF SCREENED PORCH
215 SF FRONT PORCH
129 SF SIDEWALK AND STEPS
1,120 SF DRIVEWAY
25,119 SF BOUNDARY
PROPOSED NEW IMPERVIOUS:
4,490 SF TOTAL (17.9%)
6,000 SF ALLOWED

ABBREVIATION LEGEND

R/W - RIGHT-OF-WAY
DB - DEED BOOK
PB - PLAT BOOK
BM - BOOK OF MAPS
PIN - PARCEL IDENTIFIER NUMBER
SF - SQUARE FEET
N/F - NOW OR FORMERLY
PG - PAGE
PCP - PROPOSED COVERED PORCH
PCD - PROPOSED CONCRETE DRIVEWAY
PCSW - PROPOSED CONCRETE SIDEWALK

N/F
SOUTHERN TIDE
HOMES LLC
DB 4200 PG 1504
PB 2023 PG 200
PIN 0643-36-4306

N/F
R.L JOHNSON FAMILY
LIMITED
PARTNERSHIP
DB 4290 PG 2536
PB 2008 PG 381
PIN 0643-55-0902

SOUTHERN TIDE
HOMES LLC
DB 4200 PG 1504
PB 2023 PG 200
PIN 0643-36-5217.000
0.58 ACRES
25,119 SF

N/F
REESE CONSTRUCTION
DB 3912 PG 977
PB 2023 PG 200
PIN 0643-36-6109

(DRAINAGE, MAINTENANCE
& ACCESS EASEMENT)

THIS DOCUMENT IS FOR
REVIEW PURPOSES ONLY AND
SHOULD NOT BE CONSIDERED
A CERTIFIED PLAT. THIS
DOCUMENT SHOULD NOT BE
USED FOR CONVEYANCE OF
TITLE OR ANY OTHER
TRANSACTIONS.

LINE LEGEND

PROPERTY LINE
ADJOINING PROPERTY LINE
RIGHT-OF-WAY LINE
ROAD CENTER LINE
BUILDING
CONCRETE DRIVEWAY
CONCRETE SIDEWALK
SETBACK LINE

SYMBOL LEGEND

CORNER FOUND (AS NOTED)
COMPUTED POINT

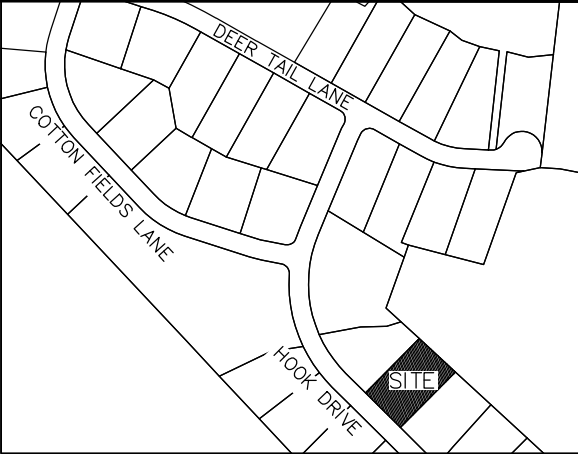
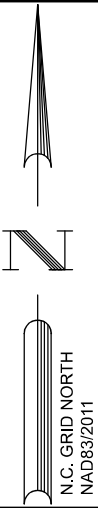

VICINITY MAP -NOT TO SCALE

INSET
1"=20'

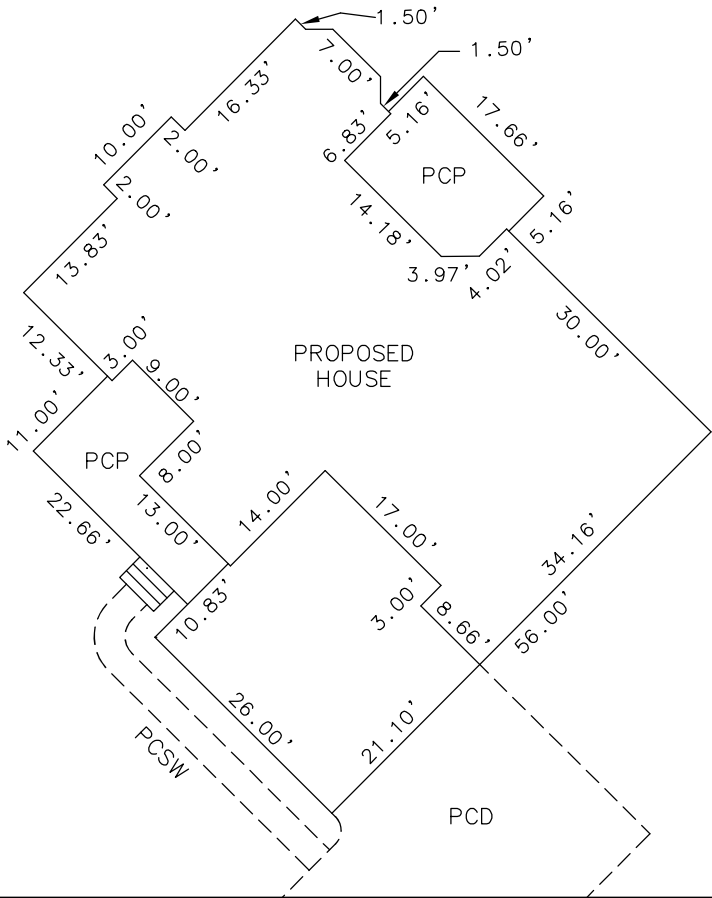

REFERENCE :

DB 4200 PG 1504
PB 2023 PG 200
PIN 0643-36-5217.000

NOTES:

- THIS IS A SITE PLAN FOR BUILDING PERMITTING ONLY.
- SUBJECT PROPERTY IS IN ZONE X PER FEMA FIRM MAP NUMBER 3720064200J
LAST REVISED MARCH 10, 2006.
- HORIZONTAL AND VERTICAL CONTROL ESTABLISHED WITH GPS USING NCGS VRS
HORIZONTAL DATUM - NCSPCS (NAD 83/2011)
VERTICAL DATUM - NAVD 88.
- ALL DISTANCES ARE HORIZONTAL GROUND DISTANCES.
- AREAS BY COORDINATE METHOD.
- THIS SURVEY WAS PREPARED WITHOUT THE BENEFIT OF A TILE REPORT. THIS SURVEY IS SUBJECT TO ANY FACTS AND EASEMENTS WHICH MAY BE DISCLOSED BY A FULL AND ACCURATE TITLE SEARCH.

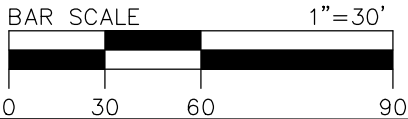

SCALE: 1"=30'
DRAWN BY: AS
REVIEWED BY: SF

FIELDS
SURVEYING PLLC
98 E. DEPOT ST.
ANGIER, NC
27501
PHONE:
919-639-2133
NC LICENSE
#P-3105



FIELDS
SURVEYING.COM

SURVEY FOR:
REESE
CONSTRUCTION

LOCATED AT:
173 HOOK DR,
FUQUAY-VARINA,
NC 27526

SITE PLAN
FOR
SOUTHERN TIDE
HOMES LLC
HECTOR'S CREEK TWP, HARNETT COUNTY,
NORTH CAROLINA

PROJECT#: 25-1175
FILE NAME: 25-1175
DATE: 11/06/2025

SHEET 1 OF 1