



**ECS Southeast, LLC**

6151 Raeford Road, Suite A  
Fayetteville, NC 28304  
9104013288  
9103230539

**LETTER OF TRANSMITTAL**

November 01, 2024  
Precision Custom Homes

Raeford, NC 28376  
ATTN: Shaun Gardner

RE: **Magnolia Hills Subdivision - Lot 10**  
ECS Job # **33:7095-B**

Permits:  
Location: **Pomogranate Circle**  
**Cameron, NC 28326**

Field Reports       For your use       As requested

CC: Precision Custom Homes - Allen Peterson      Precision Custom Homes - Lauren Ceruti

ENCL: Field Report # 1      10/31/2024



**NOV 01 2024**

Jack Cowser, P.E.  
Office Manager

Aaron Kyle Adair  
CMT Senior Project Coordinator

*Disclaimer*

1. This report (and any attachments) shall not be reproduced except in full without prior written approval of ECS.
2. The information in this report relates only to the activities performed on the report date.
3. Where appropriate, this report includes statements as to compliance with applicable project drawings, and specifications for the activities, performed on this report date.
4. Incomplete or non-conforming work will be reported for future resolution.
5. The results of samples and/or specimens obtained or prepared for subsequent laboratory testing will be presented in separate reports/documents.



ECS Southeast, LLC  
6151 Raeford Road, Suite A  
Fayetteville, NC 28304  
(910) 401-3288 [Phone]  
(910) 323-0539 [Fax]

## FIELD REPORT

Project **Magnolia Hills Subdivision - Lot 10**  
Location **Cameron, NC**  
Client **Precision Custom Homes**  
Contractor **Precision Custom Homes**

Project No. **33:7095-B**  
Report No. **1**  
Day & Date **Thursday 10/31/2024**  
Weather **64 °/ Sunny**  
On-Site Time **1.25**  
Lab Time **0.00**  
Travel Time\* **0.00**  
Total **1.25**  
Re Obs Time **0.00**

Remarks

Trip Charges*	Tolls/Parking*	Mileage*	Time of Arrival	Departure
Chargeable Items			<b>9:30A</b>	<b>10:45A</b>

\* Travel time and mileage will be billed in accordance with the contract.

**Summary of Services Performed (field test data, locations, elevations & depths are estimates) & Individuals Contacted.**

ECS Representative arrived on site, as requested, to check the bearing capacity of soils via hand auger/DCP method (ASTM STP-399) for monolithic slab. Please see the attached sketch and data sheet for details.

A total of 4 hand auger/DCP evaluations were performed to a depth of approximately 4 feet below the current footing sub grade elevation. Test results indicated that the materials in place (at the locations and elevations tested) did appear to be suitable to support the design bearing capacity of 2,000 psf.

ECS will return, as requested, for additional services.

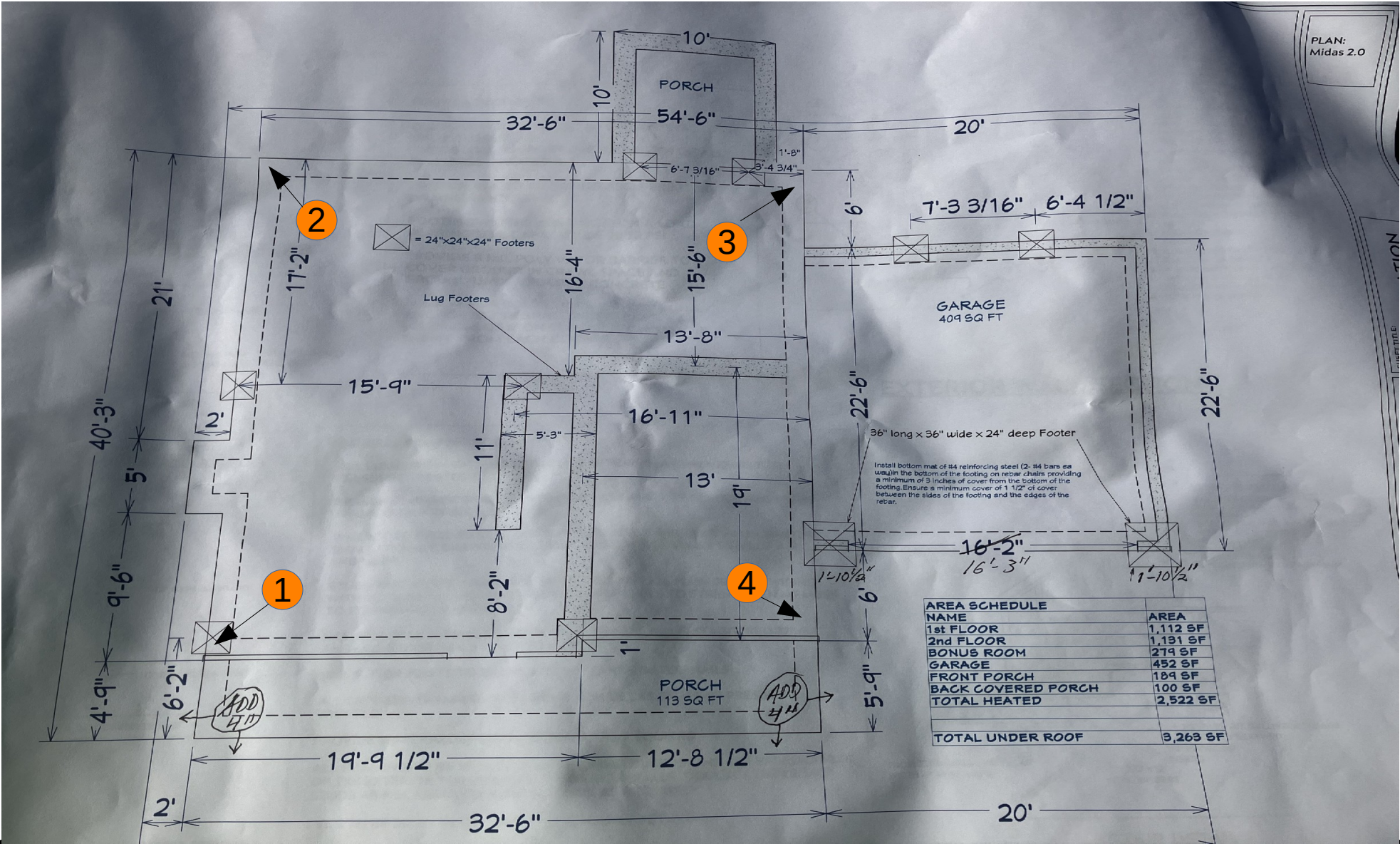

Izayah Rutledge  
 October 31, 2024  
 Magnolia Hills Lot 10  
 P: 7095-B  
 WO: 80684

**Key (NTS)**  
 DCP Locations

#



NORTH



## Report of Spread Footing - Foundation Observations

Project: Magnolia Hills Subdivision - Lot 10  
 Location: Pomogranate Circle  
Cameron - Harnett - NC - 28326  
 Contractor: Precision Custom Homes

Project No.: 33:7095-B  
 Day/Date: 10/31/2024

Footing Number	Location	Size (W x H x L)		Footing Bottom Elevation		Description of Steel Placed	Description of Subgrade Material	Required Blow Counts	Design Bearing Pressure
		Design	Actual	Design **	Depth of Undercut (in)			# of Blows / Increment	
1	Southwest Corner	x x	x x	N/A	N/A		-1:Red Clayey Sand [Offest by 3']> -2:Red Clayey Sand -3,-4:Brown Sand	6 -1:4,3,11 -2:11,11,11 -3:11,8,7 -4:9,5,6	2000
2	Northwest Corner	x x	x x	N/A	N/A		-1,-2:Red Clayey Sand -3,-4:Brown Sand	6 -1:6,6,7 -2:7,7,7 -3:5,4,3 -4:4,2,3	2000
3	Northeast Corner	x x	x x	N/A	N/A		-1:Red Brown Sand -2,-3:Brown Sand -4:Tan Sand	6 -1:7,5,6 -2:6,5,5 -3:7,6,5 -4:8,6,6	2000
4	Southeast Corner	x x	x x	N/A	N/A		-1:Red Gray Sand -2,-3,-4:Brown Sand	6 -1:9,8,7 -2:8,7,7 -3:7,6,5 -4:8,6,8	2000

\*\* SGE: Subgrade Elevation to be determined by surveyor.

By: Izayah MoReil Rutledge

ECS Southeast, LLC

WO: 80684



# Attachments



2024-Oct-31 (10)

Figure 1



2024-Oct-31 (9)

Figure 2



# Attachments



2024-Oct-31 (8)

Figure 3



2024-Oct-31 (7)

Figure 4



# Attachments



2024-Oct-31 (6)

Figure 5



2024-Oct-31 (5)

Figure 6