

Mark E. Jones, PE
Structural Engineering and Design

December 6, 2024

Christie Yarbrough Enterprises LLC
2117 Sheriff Johnson Rd.
Lillington, NC 27546

Ref: Site Observations and Analysis
471 Wade Stewart Circle
Lillington, NC
Permit No. SFD2409-0087
Project No: 24-214

To Whom it may concern;

The above referenced site was observed on December 6, 2024 to address the following structural concerns:

1. Provide engineering on EGR truss point loads with no enlarged footing.

Based on observations and analysis, the conclusions regarding the structure are:

1. The builder shall modify the wall framing at each end of the installed EGR truss as shown on the attached drawing. These modifications will result in distribution of the point loads at each end to be adequately supported by the existing footings.

Thank you for this opportunity to assist you. If you have any questions or need any further assistance, please do not hesitate to call.

Respectfully,



Mark E. Jones, PE

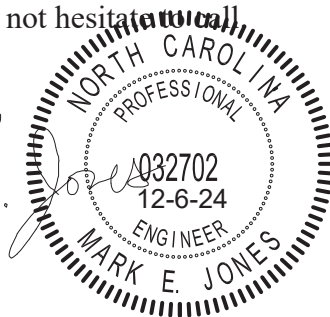

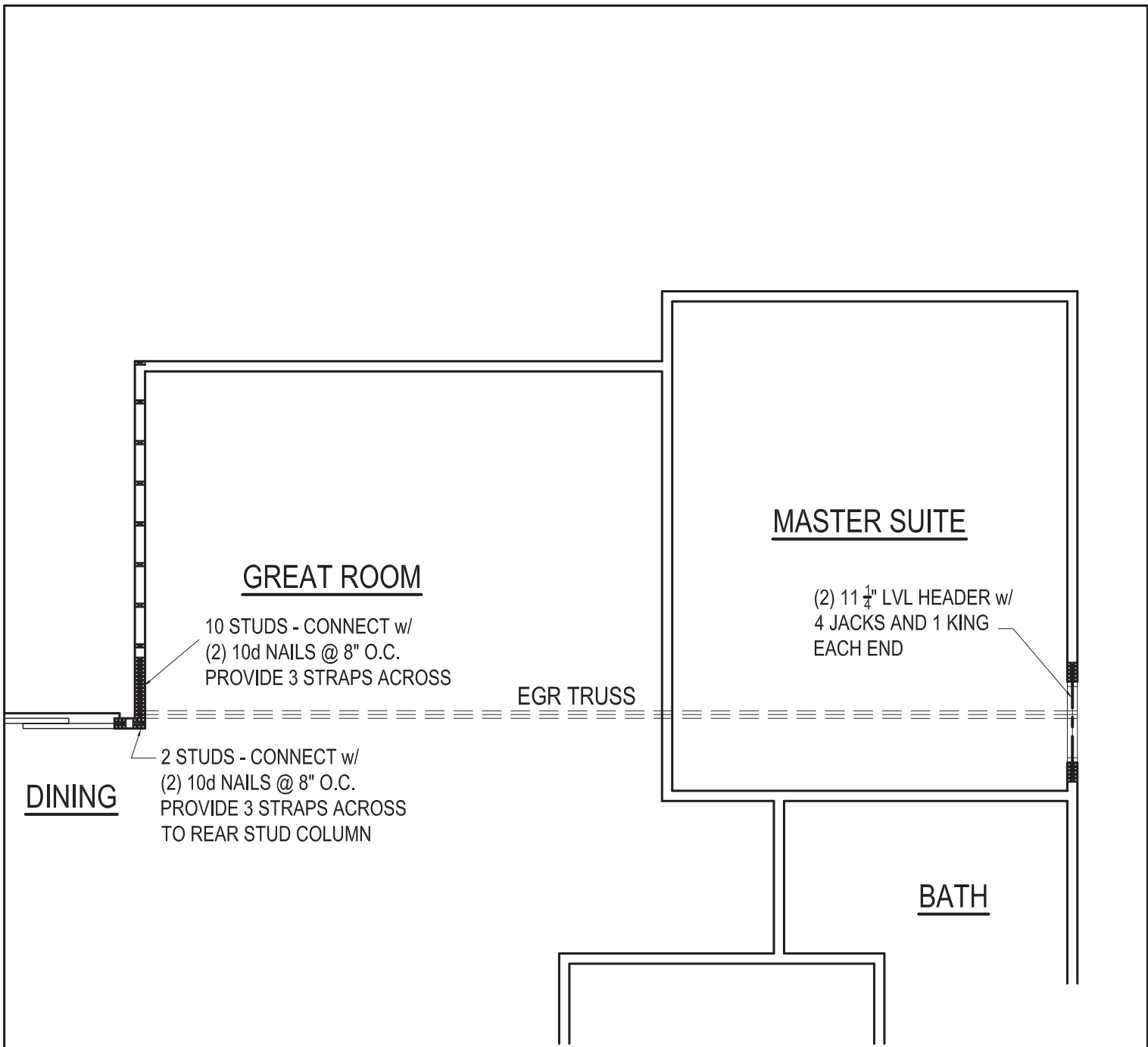

ROOF TRUSS EGR SUPPORT DETAILS



Mark E. Jones

Mark E. Jones, PE

6425 GLEN DEAN COURT
RALEIGH, NC 27603
PHONE: (919) 395-5618

PROJECT	24-214 CHRISTIE YARBROUGH ENTERPRISES LLC		
LOCATION	471 WADE STEWART CIRCLE LILLINGTON, NC		
DESIGNED BY	MEJ	DATE	12/6/24
SCALE	NTS	PAGE	2 OF 2