



ECS Southeast, LLC
6151 Raeford Road, Suite A
Fayetteville, NC 28304
T 910.401.3288
F 910.323.0539

LETTER OF TRANSMITTAL

December 26, 2024
Ascot Group

Southern Pines, NC 28388

ATTN: Jay Carroll

RE: **Oakmont Subdivision Lot 371**
ECS Job # **33:6935-D**

Permits:
Location: **24 Tackett Ct**
Lillington, NC 27546

Field Reports For your use As requested

CC:

ENCL: Field Report # 1 12/23/2024



DEC 26 2024

Jack Cowsert, P.E.
Office Manager

Aaron Kyle Adair
CMT Senior Project Coordinator

Disclaimer

1. This report (and any attachments) shall not be reproduced except in full without prior written approval of ECS.
2. The information in this report relates only to the activities performed on the report date.
3. Where appropriate, this report includes statements as to compliance with applicable project drawings, and specifications for the activities, performed on this report date.
4. Incomplete or non-conforming work will be reported for future resolution.
5. The results of samples and/or specimens obtained or prepared for subsequent laboratory testing will be presented in separate reports/documents.



ECS Southeast, LLC
6151 Raeford Road, Suite A
Fayetteville, NC 28304
T 910.401.3288
F 910.323.0539

FIELD REPORT

Project **Oakmont Subdivision Lot 371**
Location **Lillington, NC**
Client **Ascot Group**
Contractor **Ascot Group**

Project No. **33:6935-D**
Report No. **1**
Day & Date **Monday 12/23/2024**
Weather **25 °/ Sunny**
On-Site Time **1.00**
Lab Time **0.00**
Travel Time* **0.00**
Total **1.00**
Re Obs Time **0.00**

Remarks

| | | | | |
|------------------|----------------|----------|-----------------|--------------|
| Trip Charges* | Tolls/Parking* | Mileage* | Time of Arrival | Departure |
| Chargeable Items | | | 8:00A | 9:00A |

* Travel time and mileage will be billed in accordance with the contract.

Summary of Services Performed (field test data, locations, elevations & depths are estimates) & Individuals Contacted.

ECS arrived on site, as requested, to check the bearing capacity of soils via hand auger/DCP method (ASTM STP-399) for stem wall backfill. Please see the attached sketch and data sheet for details.

A total of 3 hand auger/DCP evaluations were performed to a depth of approximately 4 feet below the current footing sub grade elevation. Test results indicated that the materials in place (at the locations and elevations tested) did appear to be suitable to support the design bearing capacity of 2,000 psf.

ECS will return, as requested, for additional services.

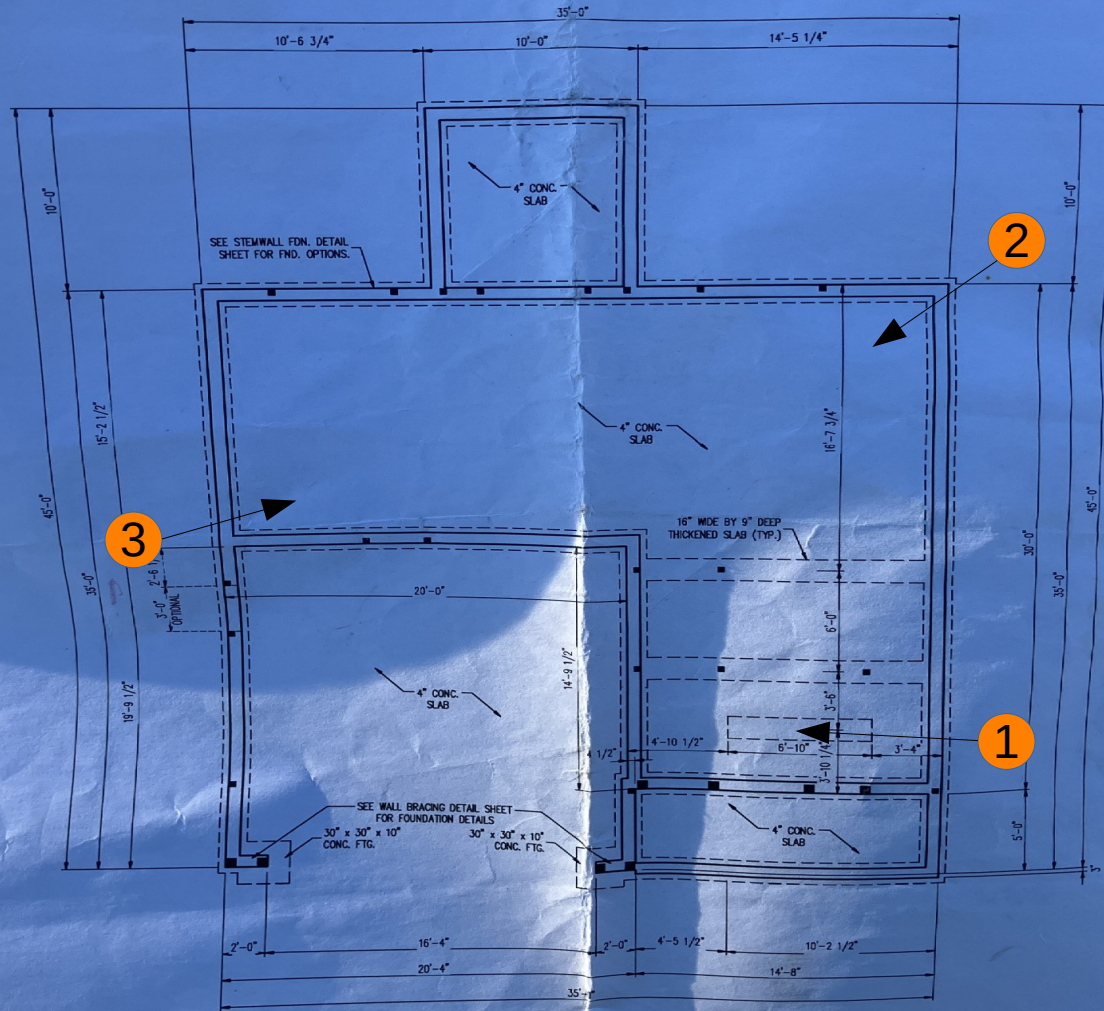

- 150. M
- 1. ENGR
- 2. COMR
- 3. SPT
- 4. ACQ
- 5. SPT
- 6. SPT
- 7. SPT
- 8. SPT
- 9. SPT
- 10. SPT
- 120. L
- 1. ENGR
- 2. COMR
- 3. SPT
- 4. ACQ
- 5. SPT
- 6. SPT
- 7. SPT
- 8. SPT
- 9. SPT
- 10. SPT

Izayah Rutledge
 December 23, 2024
 Oakmont Sub. Lot 371
 P: 6935-D
 WO: 81766

Key (NTS)
 DCP Locations



NORTH





Report of Foundation Observations

Project: Oakmont Subdivision Lot 371
 Location: 24 Tackett Ct
Lillington - Harnett - NC - 27546

ECS Project No. : 33:6935-D
 Date: 12/23/2024

General Location: _____
 Footing Type: _____

Design Bearing Pressure: 2000

| Test No. | Location | Size | | | Footing Bottom Elevation | | Depth of Undercut | Description of Steel Placed | Description of Foundation Subgrade Material | Depth of Test* | Increment for blow count |
|----------|-----------|------|--------|--------|--------------------------|----------|-------------------|-----------------------------|--|----------------|--------------------------|
| | | | Design | Actual | Design | Actual** | | | | | |
| 1 | SW Corner | W | 0' 0" | 0' 0" | | | 0' 0" | | -1:Gray Sand -2:Gray Brown Sand -3:Brown Sand -4:Brown Clayey Sand | | |
| | | D | 0' 0" | 0' 0" | | | | | | | |
| | | L | 0' 0" | 0' 0" | | | | | | | |
| 2 | NW Corner | W | 0' 0" | 0' 0" | | | 0' 0" | | -1,-2,-3:Gray Sand - 4:Gray Brown Sand | | |
| | | D | 0' 0" | 0' 0" | | | | | | | |
| | | L | 0' 0" | 0' 0" | | | | | | | |
| 3 | SE Corner | W | 0' 0" | 0' 0" | | | 0' 0" | | -1:Gray Sand -2:Gray Brown Sand -3,-4:Brown Sand | | |
| | | D | 0' 0" | 0' 0" | | | | | | | |
| | | L | 0' 0" | 0' 0" | | | | | | | |

* Depth of DCP, or other methods of determining the soil stiffness
 ** Subgrade elevation reported by any means the contractor provided

By: Izayah MoRell Rutledge

 ECS Southeast, LLC

 WO: 81766

Attachments

PERMIT NUMBER
1802409-0078

DO NOT REMOVE
Details, Appointment of Lias Agent
Form 1 - 1/1/2018

Project No. 6935-D
Day/Date Dec 23, 2024
Temp./Weather 35°
Arrive 0800
Depart 0900
On-Site Time 1hr
Lab/Office Time
Reinspection Time
No. of Trips
Total Mileage
Design Bearing Capacity (psf) 2000
Pass
Fail

ECS Carolina, LLP
6311 Piedmont Road, Suite A
Raleigh, NC 27606
(919) 401-3288 Office
(919) 323-0539 Fax

FIELD REPORT

Project: Command Sub Lot 371
Location: 24 Tarzetti Ct
Client: Asent Group

PROJECT MANAGER REMARKS:

2024-Dec-23 (6)

Figure 1



2024-Dec-23 (5)

Figure 2

Attachments



2024-Dec-23 (4)

Figure 3



2024-Dec-23 (3)

Figure 4

Attachments



2024-Dec-23 (2)

Figure 5



2024-Dec-23 (1)

Figure 6