



ECS Southeast, LLC

6151 Raeford Road, Suite A
Fayetteville, NC 28304
9104013288
9103230539

LETTER OF TRANSMITTAL

October 09, 2024
W.S. Wellons Realty
PO Box 766
Spring Lake, NC 28390
ATTN: Jason Wellons

RE: **Onslow Court- lot 10**
ECS Job # **33:7062-B**

Permits:
Location: **102 Onslow Ct**
Spring Lake, NC 28390

Field Reports For your use As requested

CC:

ENCL: Field Report # 1 10/8/2024



OCT 09 2024

Jack Cowser, P.E.
Office Manager

Robert T. Harrigan
Team Leader

Disclaimer

1. This report (and any attachments) shall not be reproduced except in full without prior written approval of ECS.
2. The information in this report relates only to the activities performed on the report date.
3. Where appropriate, this report includes statements as to compliance with applicable project drawings, and specifications for the activities, performed on this report date.
4. Incomplete or non-conforming work will be reported for future resolution.
5. The results of samples and/or specimens obtained or prepared for subsequent laboratory testing will be presented in separate reports/documents.



ECS Southeast, LLC
 6151 Raeford Road, Suite A
 Fayetteville, NC 28304
 (910) 401-3288 [Phone]
 (910) 323-0539 [Fax]

FIELD REPORT

Project **Onslow Court- lot 10**
 Location **Spring Lake, NC**
 Client **W.S. Wellons Realty**
 Contractor **None Listed**

Project No. **33:7062-B**
 Report No. **1**
 Day & Date **Tuesday 10/8/2024**
 Weather **57 °/ Sunny**
 On-Site Time **1.75**
 Lab Time **0.00**
 Travel Time* **0.00**
 Total **1.75**
 Re Obs Time **0.00**

Remarks

Trip Charges*	Tolls/Parking*	Mileage*	Time of Arrival	Departure
Chargeable Items			8:15A	10:00A

* Travel time and mileage will be billed in accordance with the contract.

Summary of Services Performed (field test data, locations, elevations & depths are estimates) & Individuals Contacted.

ECS Representative arrived on site, as requested, to check the bearing capacity of soils via hand auger/DCP method (ASTM STP-399) for foundation footings. Please see the attached sketch and data sheet for details.

A hand auger was used to advance the boreholes to different depths noted on the boring logs. Dynamic Cone Penetrometer (DCP) test were performed in the hand auger boreholes by a 1.5 inch diameter cone driven into the soil by a 15 pound ring weight with a free fall of 20 inches. The number of blows required to drive the cone into the soil a distance of 1.75 inches is termed the DCP Value and is indicated for each test on the hand auger.

A total of 5 hand auger/DCP evaluations were performed to a depth of approximately 3 feet below the current footing sub grade elevation. It is to the opinion of ECS that the materials in place (at the locations and elevations tested) did appear to be suitable to support the design bearing capacity 2000 psf.

ECS will return, as requested, for additional services.

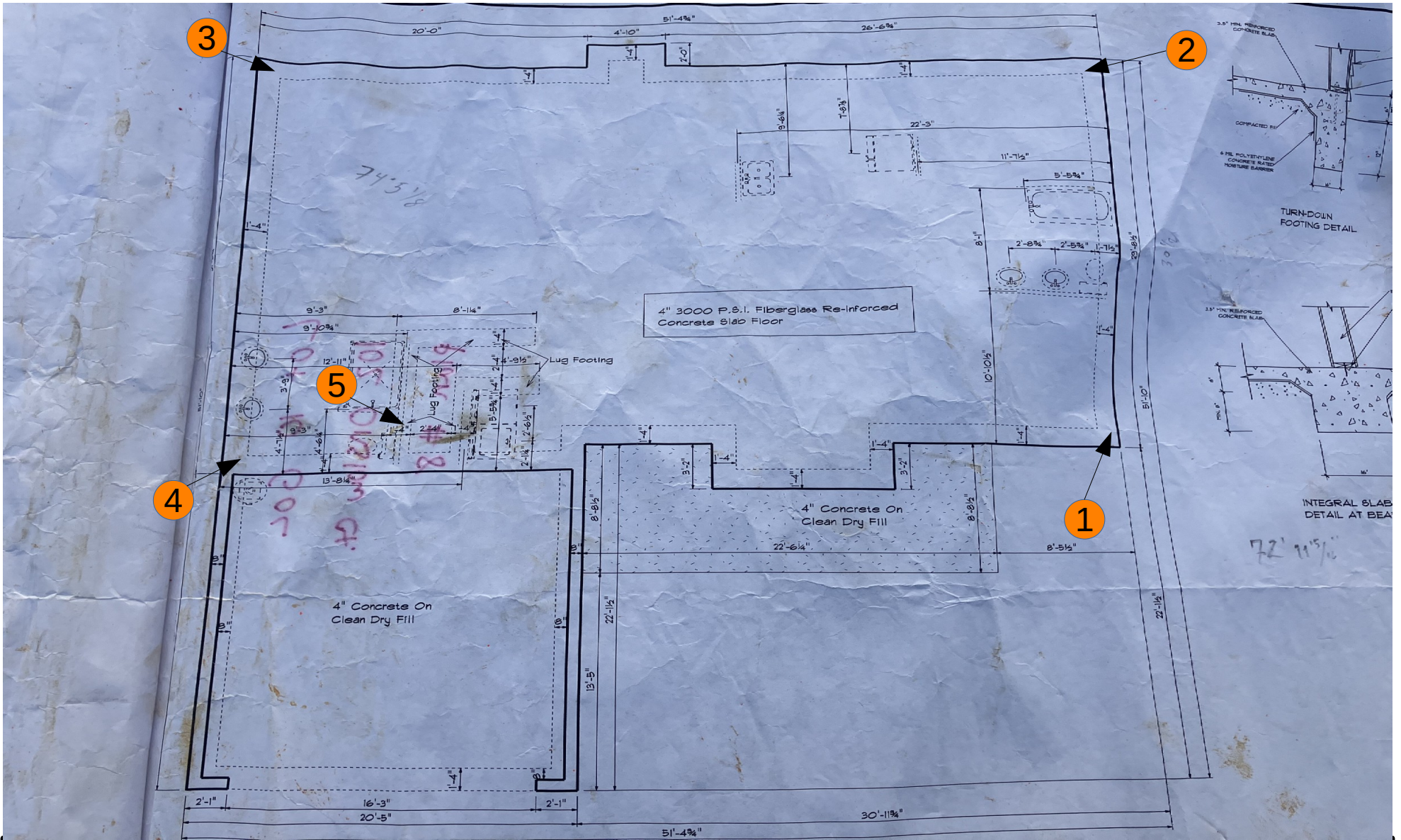

Izayah Rutledge
 October 8, 2024
 Onslow Ct Lot 10
 P: 7062-B
 WO: 80094

Key (NTS)
 DCP Locations

#



NORTH



Report of Spread Footing - Foundation Observations

Project: Onslow Court- lot 10
 Location: 102 Onslow Ct
Spring Lake - Cumberland - NC - 28390
 Contractor: None Listed

Project No.: 33:7062-B
 Day/Date: 10/8/2024

Footing Number	Location	Size (W x H x L)		Footing Bottom Elevation		Description of Steel Placed	Description of Subgrade Material	Required Blow Counts	Design Bearing Pressure
		Design	Actual	Design **	Depth of Undercut (in)			# of Blows / Increment	
1	Southeast Corner	x x	x x	N/A	N/A		0:Orange Silty Sand -1:Orange Gray Sandy Clay -2:Gray Orange Sandy Clay -3:Gray Orange Sand	6	2000
								0:15+ -1:8,8,7 -2:15+ -3:15+	
2	Northeast Corner	x x	x x	N/A	N/A		0:Orange Silty Sand -1:Orange Gray Sand -2:Gray Orange Sandy Clay -3:Gray Orange Sand	6	2000
								0:15+ -1:15+ -2:13,11,11 -3:15+	
3	Northwest Corner	x x	x x	N/A	N/A		0:Tan Orange Silty Sand -1:Tan Sand -2:Brown Sand -3:Brown Clayey Sand	6	2000
								0:4,6,6 -1:14,15+ -2:12,14,15 -3:15+	
4	Southwest Corner	x x	x x	N/A	N/A		0:Tan Orange Silty Sand -1:Tan Sand -2:Brown Clayey Sand -3:Brown Gray Sand	6	2000
								0:4,4,5 -1:10,10,14 -2:11,10,12 -3:15+	
5	Lug Footer	x x	x x	N/A	N/A		0:Brown Orange Sand -1:Tan Sand -2:Brown Clayey Sand -3:Brown Orange Clayey Sand	6	2000
								0:7,10,9 -1:15+ -2:12,13,13 -3:15+	



Report of Spread Footing - Foundation Observations

Project: Onslow Court- lot 10
Location: 102 Onslow Ct
Spring Lake - Cumberland - NC - 28390
Contractor: None Listed

Project No.: 33:7062-B
Day/Date: 10/8/2024

** SGE: Subgrade Elevation to be determined by surveyor.

By: Izayah MoReil Rutledge

ECS Southeast, LLC

WO: 80094

Attachments



2024-Oct-8 (10)

Figure 1



2024-Oct-8 (9)

Figure 2

Attachments



2024-Oct-8 (8)

Figure 3



2024-Oct-8 (7)

Figure 4

Attachments



2024-Oct-8 (6)

Figure 5



2024-Oct-8 (5)

Figure 6

Attachments



2024-Oct-8 (4)

Figure 7



2024-Oct-8 (2)

Figure 8

Attachments



2024-Oct-8 (1)

Figure 9