

I, MICHAEL P. GRIFFIN, certify that under my direction and supervision this map was drawn from an actual field survey that the error of closure of the survey as calculated by coordinates is 1:10,000+; that the area shown hereon was calculated by coordinates. Dashed lines shown hereon were not surveyed.

Witness my hand and seal this 4TH day of OCTOBER 2024.

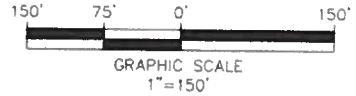

Michael P. Griffin



- TRWELL MORRILL DB 4194.PG 822 MAP NO. 2000-191A (82)
- LONGWATER PHELPS DB 3740.PG 400 MAP NO. 2000-191A (81)
- ROHARD HOFERSON DB 3084.PG 424 MAP NO. 2000-191A (80)
- JAMES JAMES DB 3000.PG 828 MAP NO. 2000-191A (79)
- TRIMBLE REAL ESTATE INVESTMENTS & ASSOCIATES LLC DB 3843.PG 173 MAP NO. 2000-191A (78)
- MCO DB MAP

SECRETARIATE CIRCLE
60' PRIVATE EASEMENT

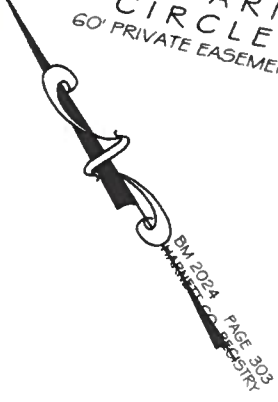

MARTIN OGDENRE, JR.
DB 745.PG 533

NICHOLAS UNCS
DB 3913.PG 01
MAP NO. 2016-282

JAMES STROCKLAND
DB 4182.PG 2804

SETBACKS
FRONT 35'
REAR 25'
SIDE 10'

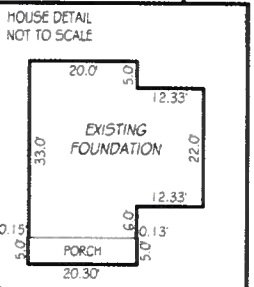
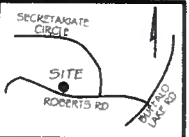

- L1 S 53°13'20"E 79.48'
- L2 S 83°06'34"E 10.52'
- L3 N 36°48'24"W 81.11'
- L4 N 35°15'54"W 14.88'
- L5 S 32°35'48"W 40.70'
- L6 S 32°35'17"W 35.93'

LEGEND

EIP	EXISTING IRON PIPE	FES	FLARED END SECTION
ISS	IRON STAKE SET	WM	WATER METER
R/W	RIGHT OF WAY	CO	CLEAN OUT
N/F	NOW OR FORMERLY	FH	FIRE HYDRANT
EIS	EXISTING IRON STAKE	CB	CATCH BASIN

THIS PROPERTY IS NOT LOCATED IN THE 100 YEAR FLOOD ZONE.



GRIFFIN LAND SURVEYING, INC.
P.O. BOX 148
FUQUAY-VARINA, NC 27526
(919) - 567-1963
FIRM LIC.# C-1345

FOUNDATION SURVEY FOR
SBM HOMES LLC
ROBERT'S ROAD MINOR
LOT 3
ROBERTS ROAD
SANFORD, N.C.
HARNETT COUNTY BARBECUE TOWNSHIP

DRAWN BY KDF

DATE 10/4/24

CHECKED BY MPG

SCALE 1" = 150'