

**LOT INFORMATION:**

PIN: 9681-60-0071  
 REFERENCE: DB, 4248, PGS. 428-430  
 TOTAL LOT AREA = 0.459 AC = 20,000 SF  
 FOUNDATION = 2,364 SF  
 EXISTING IMPERVIOUS = 2,364 SF  
 PERCENT IMPERVIOUS = 11.82%

BK. 2024, PG. 373



**BUILDING SETBACKS**  
 FRONT - 35'  
 REAR - 25'  
 SIDE - 10'  
 CORNER SIDE - 20'

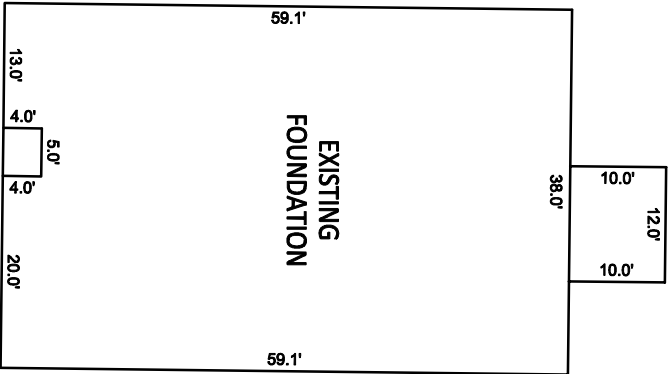

INSET SCALE: 1"=20'

**NOTES:**

1. THIS SURVEY WAS PREPARED BY BATEMAN CIVIL SURVEY CO., UNDER THE SUPERVISION OF STEVEN P. CARSON, PLS.
2. THIS PLAN HAS BEEN PREPARED FOR LAYOUT AND PERMITTING PURPOSES ONLY.
3. PROPERTY LINES SHOWN WERE TAKEN FROM EXISTING FIELD EVIDENCE, EXISTING DEEDS AND PLATS OF PUBLIC RECORD, AND INFORMATION SUPPLIED TO THE SURVEYOR BY THE CLIENT.
4. ALL DISTANCES ARE HORIZONTAL GROUND DISTANCES AND ALL BEARINGS ARE NORTH CAROLINA STATE PLANE COORDINATE SYSTEM UNLESS OTHERWISE SHOWN.
5. THIS MAP IS NOT FOR RECORDATION AND SHOULD BE REVIEWED BY A LOCAL GOVERNMENT AGENCY FOR COMPLIANCE WITH ANY APPLICABLE LAND DEVELOPMENT REGULATIONS.
6. THE BASIS OF NORTH AND ALL EASEMENTS, RIGHTS-OF-WAYS, BUFFERS, SETBACKS AND ADJOINERS, ETC. REFERENCED IN TITLE BLOCK.
7. NO INVESTIGATION INTO THE EXISTENCE OF JURISDICTIONAL WETLANDS, FLOOD ZONES OR RIPARIAN BUFFERS PERFORMED BY THIS FIRM. ALL LINES SHOWN, IF ANY, ARE SCALED FROM THE RECORDED PLAT.
8. SURVEYOR HAS MADE NO INVESTIGATION OR INDEPENDENT SEARCH FOR EASEMENTS OF RECORD, ENCUMBRANCES, RESTRICTIVE COVENANTS, OWNERSHIP TITLE EVIDENCE OR ANY OTHER FACTS THAT AN ACCURATE AND CURRENT TITLE SEARCH MAY DISCLOSE.
9. ZONING IS RA-20.
10. BUILDER/DEVELOPER: SMITH DOUGLAS HOMES  
 3412 APEX PEAKWAY  
 APEX, NC 27502

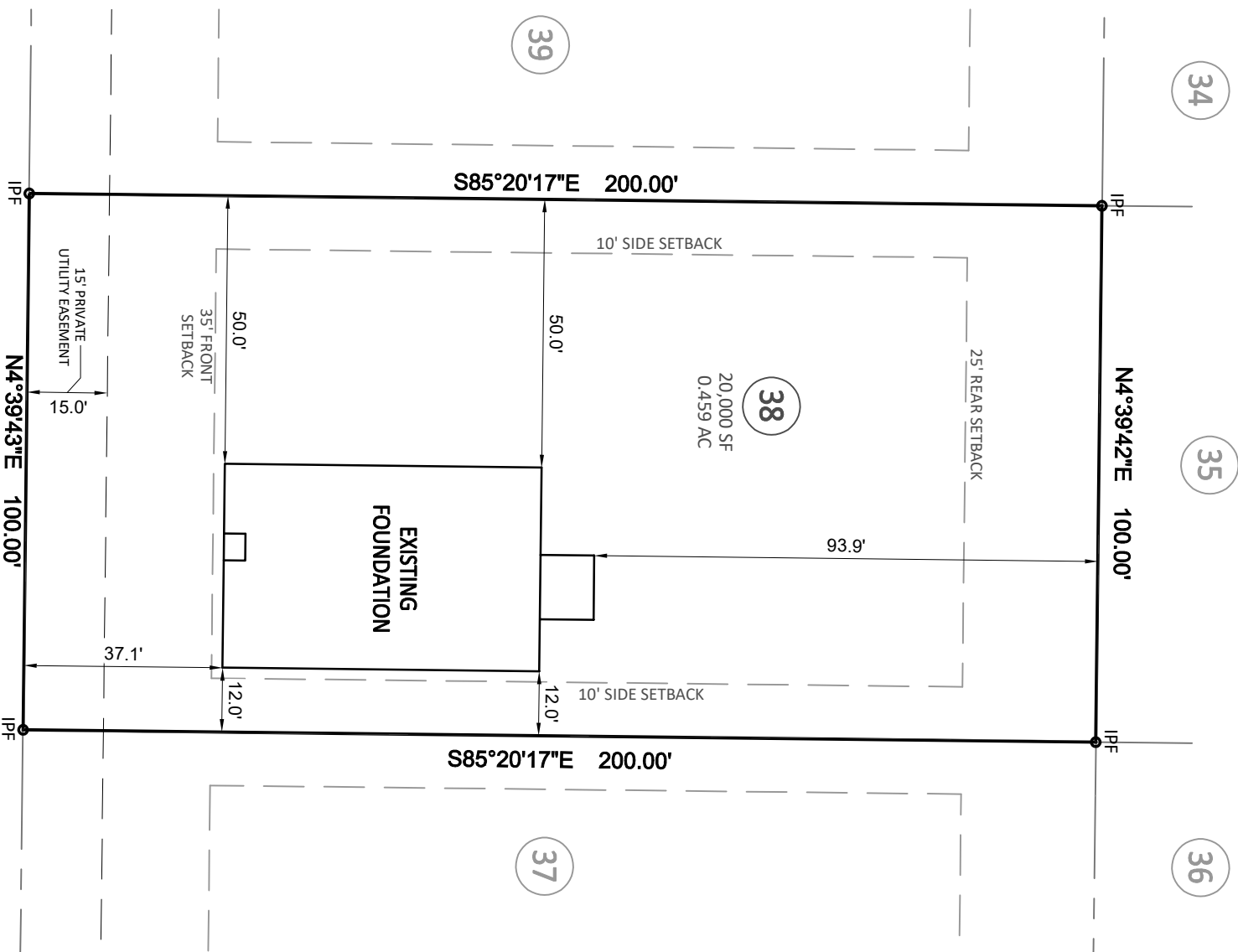

VILI DRIVE  
 PUBLIC 60' R/W

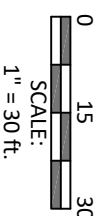

**Bateman Civil Survey Company**

Engineers • Surveyors • Planners  
 2524 Reliance Avenue, Apex, NC 27539 Ph: 919.577.1080 Fax: 919.577.1081  
 www.batemancivilsurvey.com info@batemancivilsurvey.com  
 NCBELS Firm No. C-2978

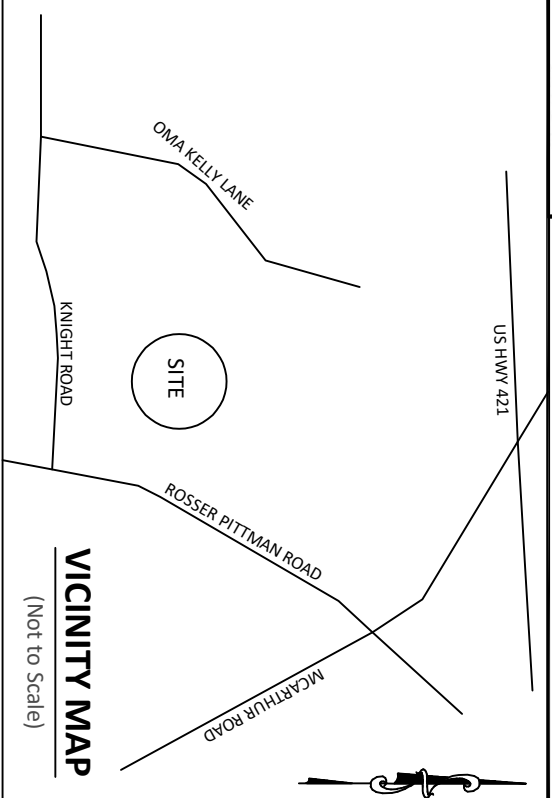

**VICINITY MAP**

(Not to Scale)

**LEGEND**

- PO = COVERED FRONT PORCH DRAWN UNDER MY DIRECT SUPERVISION FROM A SP = SCREENED PORCH/PATIO SURVEY MADE UNDER MY SUPERVISION (PLAT BOOK CP = COVERED PORCH/PATIO REFERENCED IN TITLE BLOCK); THAT THE BOUNDARY NOT SURVEYED ARE CLEARLY INDICATED AS DRAWN FROM INFORMATION LISTED UNDER REFERENCES; THAT THE RATIO OF PRECISION AS CALCULATED IS 1:10,000+; AND THAT THIS MAP MEETS THE REQUIREMENTS OF THE STANDARD OF PRACTICE FOR LAND SURVEYING IN NORTH CAROLINA. L-4752 DATED:
- = IRON PIPE FOUND (IPF)
- = DRILL HOLE FOUND
- ⊙ = WATER METER
- ⊕ = CLEAN OUT
- ⊖ = AIR CONDITIONER
- ⊗ = SEWER MANHOLE
- ⊘ = ELECTRIC BOX
- ⊙ = CABLE BOX
- ⊙ = TELEPHONE PEDESTAL
- ⊙ = CATCH BASIN
- ⊙ = IRRIGATION CONTROLLER
- ⊙ = LIGHT POLE
- ⊙ = UTILITY POLE
- ⊙ = FIRE HYDRANT
- ⊙ = DRAIN INLET
- ⊙ = WATER VALVE
- ⊙ = STREET SIGN
- ⊙ = YARD INLET
- ⊙ = GAS METER
- ⊙ = ELECTRIC METER

STEVEN P. CARSON  
 NORTH CAROLINA PROFESSIONAL SURVEYOR  
 9/17/24

This map is of an existing parcel of land and is only intended for the parties and purposes shown. This map not for recordation. No title report provided.

**FOUNDATION SURVEY**  
 FOR  
**SMITH DOUGLAS HOMES**

**HARRINGTON PLACE - PHASE 2 - LOT 38**

44 VILI DRIVE, BROADWAY, NC  
 UPPER LITTLE RIVER TOWNSHIP, HARNETT COUNTY

DATE: 9/17/24 DRAWN BY: SLA CHECKED BY: SPC

REFERENCE: BK. 2024, PG. 373

BCS# 230119

SCALE: 1" = 30'