

T-2
17.40 Acres
PC#F, Slide 476-B

Scale:
1" = 300'

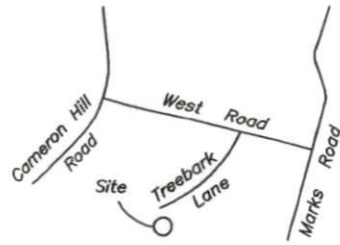

Plot Plan for:
Landry Homes, LLC
Johnsonville Township
Harnett County North Carolina
December 2, 2024

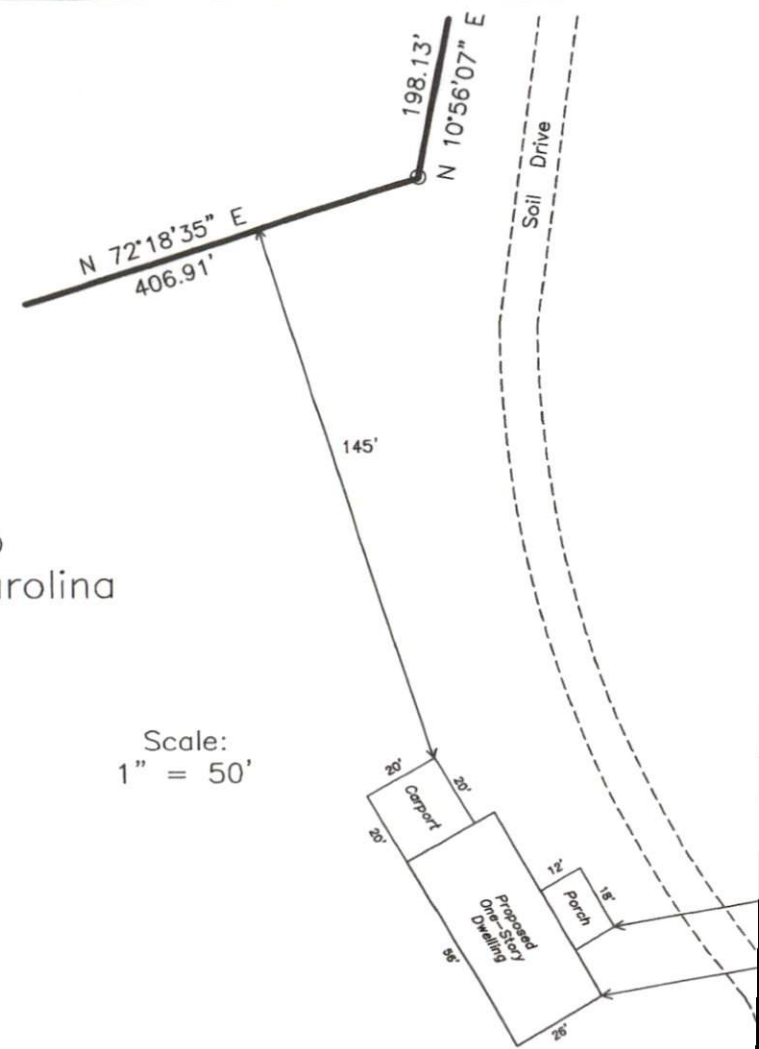

Scale:
1" = 50'

I, William B. Snively, certify that this map was drawn by me from an actual field survey made by me, that the ratio of precision as calculated by computer exceeds 1: 10000. This map does not conform to GS 47-30 as amended and is not intended for recordation nor should a copy of this map be attached to a deed as an exhibit to be recorded per GS 89C-26.

William B. Snively & Associates, PLLC, Surveyors
7595 Boyce's Landing Road
Wade, North Carolina 28395
Ph 910 483-3863 License No. P-0463



Tax Parcel I.D. No.:
9564-92-3028-

Property Address
470 Treebark Lane
Cameron, N.C. 28326



House Plan:
GCP Designs
LH-1456