

SOIL/SITE EVALUATION
 for ON-SITE WASTEWATER SYSTEM

Owner: *Michael Wilder*
 Applicant:

Address: *2357 E 110th Blvd* Date Evaluated:
 Proposed Facility: Design Flow (.1949): *360*

Location of Site: *SFD* Property Recorded:
 Water Supply: Public Individual Well Spring Other
 Evaluation Method: Auger Boring Pit Cut
 Type of Wastewater: Sewage Industrial Process Mixed

P R O F I L E #	.1940 Landscape Position/ Slope %	Horizon Depth (In.)	SOIL MORPHOLOGY .1941		OTHER PROFILE FACTORS				Profile Class & LTAR
			.1941 Structure/ Texture	.1941 Consistence Mineralogy	.1942 Soil Wetness/ Color	.1943 Soil Depth (IN.)	.1956 Sapro Class	.1944 Restr Horiz	
1	<i>L</i> <i>2-5%</i>	<i>0-14</i>	<i>LS</i>	<i>Fr</i>	<i>10YR 6/1</i>	<i>>48"</i>	<i>-</i>	<i>-</i>	<i>S.4</i>
		<i>14-48</i>	<i>SCI</i>	<i>Fi</i>	<i>≥ 34"</i>				
2	<i>L</i> <i>2-5%</i>	<i>0-16</i>	<i>LS</i>	<i>Fr</i>	<i>10YR 6/1</i>	<i>>48"</i>	<i>-</i>	<i>-</i>	<i>S.4</i>
		<i>16-48</i>	<i>SCI</i>	<i>Fi</i>	<i>≥ 36"</i>				
3	<i>L</i> <i>2-5%</i>	<i>0-16</i>	<i>LS</i>	<i>Fr</i>	<i>10YR 6/1</i>	<i>>48"</i>	<i>-</i>	<i>-</i>	<i>S.4</i>
		<i>16-48</i>	<i>SCI</i>	<i>Fi</i>	<i>≥ 36"</i>				
4	<i>L</i> <i>2-5%</i>	<i>0-16</i>	<i>LS</i>	<i>Fr</i>	<i>10YR 6/1</i>	<i>>48"</i>	<i>-</i>	<i>-</i>	<i>S.4</i>
		<i>16-48</i>	<i>SCI</i>	<i>Fi</i>	<i>≥ 38"</i>				

Description	Initial System	Repair System	Other Factors (.1946): Site Classification (.1948): Evaluated By: <i>SMA REAS</i> Others Present:
Available Space (.1945)	<i>✓</i>	<i>✓</i>	
System Type(s)	<i>.4</i>	<i>.4</i>	
Site LTAR	<i>.4</i>	<i>.4</i>	

COMMENTS: _____

LANDSCAPE POSITIONS	GROUP	TEXTURES	.1955 LTAR	CONSISTENCE MOIST	WET
R-RIDGE	I	S-SAND	1.2 - 0.8	VFR-VERY FRIABLE	NS-NON-STICKY
S-SHOULDER SLOPE		LS-LOAMY SAND		FR-FRIABLE	SS-SLIGHTY STICKY
L-LINEAR SLOPE	II	SL-SANDY LOAM	0.8 - 0.6	FI-FIRM	S-STICKY
FS-FOOT SLOPE		L-LOAM		VFI-VERY FIRM	VS-VERY STICKY
N-NOSE SLOPE	III	SI-SILT	0.6 - 0.3	EFI-EXTREMELY FIRM	NP-NON-PLASTIC
H-HEAD SLOPE		SIL-SILT LOAM		SP-SLIGHTLY STICKY	
CC-CONCLAVE SLOPE		CL-CLAY LOAM		P-PLASTIC	
CV-CONVEX SLOPE		SCL-SANDY CLAY LOAM		VP-VERY PLASTIC	
T-TERRACE	IV	SIC-SILTY CLAY	0.4 - 0.1		
FP-FLOOD PLAN		C-CLAY			
		SC-SANDY CLAY			

STRUCTURE
 SG-SINGLE GRAIN
 M- MASSIVE
 CR-CRUMB
 GR-GRANULAR
 SBK-SUBANGULAR BLOCKY
 ABK-ANGULAR BLOCKY
 PL-PLATY
 PR-PRISMATIC

MINERALOGY
 SLIGHTLY EXPANSIVE
 EXPANSIVE

Show profile locations and other site features (dimensions, references or benchmark, and North)

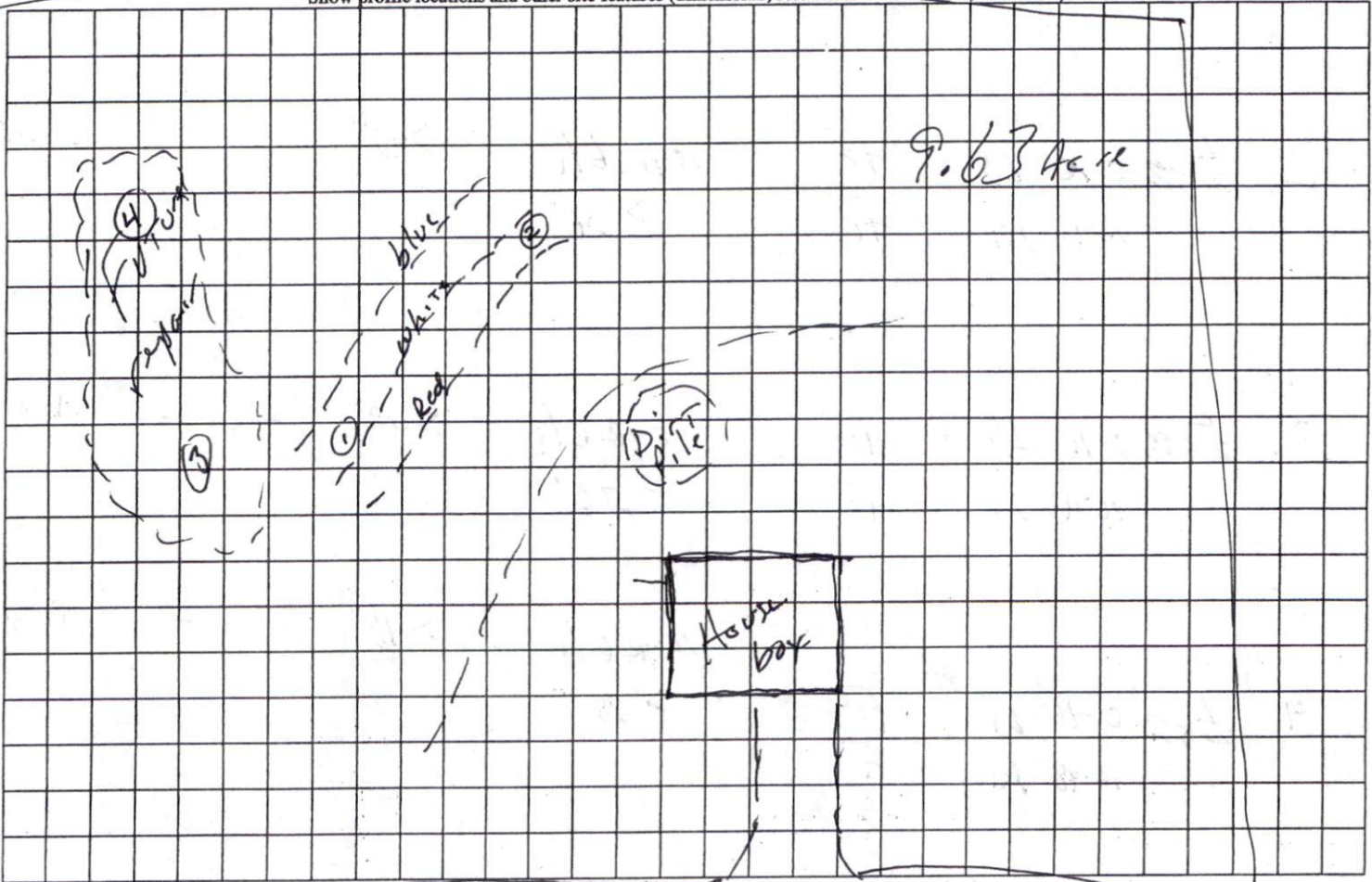

ELLIOTT Bridge Rd