

Harnett County Environmental Health

File/Permit Number: SFD2407-0084

IMPROVEMENT PERMIT

County: Harnett
PIN/Lot Identifier: 0642-96-0376.000
Owner: KB Home Applicant: _____
Property Location: 102 Robert Howe
Subdivision (if applicable) Birchwood Grove Lot #: 48 Block: _____ Section: _____
New Expansion System Relocation Change of Use
Facility Type: SFD (51'x50')
Number of bedrooms: 3 Number of Occupants: 6 Other: _____
Design Wastewater Strength: Domestic High Strength Industrial Process Wastewater
Proposed Design Daily Flow: 360 GPD Proposed LTAR (Initial): .35 Proposed LTAR (Repair): .35
Proposed Wastewater System Type*: Accepted System (Initial) Pump Required: Yes No May be required
Proposed Wastewater System Type*: Accepted System (Repair) Pump Required: Yes No May be required
**Please include system classification for proposed wastewater system types in accordance with Rule .1301 Table XXXII*
Effluent Standard: DSE HSE NSF/ANSI 40 TS-I TS-II RCW
Saprolite System (Initial): Yes No Saprolite System (Repair): Yes No
Fill System (Initial): Yes No If yes, specify: New Existing (when adding more than 6 inches of fill to system area provide a fill plan)
Fill System (Repair): Yes No If yes, specify: New Existing (when adding more than 6 inches of fill to system area provide a fill plan)
Usable Depth to LC (Initial)*: 42 Usable Depth to LC (Repair)*: 32 * **Limiting Condition**
Max. Trench Depth (Initial)*: 28 Max. Trench Depth (Repair)*: 18 * **Measured on the downhill side of the trench**
Artificial Drainage Required: Yes No If yes, please specify details: _____
Type of Water Supply: Private well Public well Shared well Municipal Supply Spring Other: _____
Drainfield location meets requirements of Rule .0508: Yes No Drainfield location meets requirements of Rule .0601: Yes No
Permit valid for: Five years [site plan submitted pursuant to GS 130A-334(13a)] No expiration [plat submitted pursuant to GS 130A-334(7a)]

Permit conditions:

Authorized Agent's Printed Name: Oliver Tolksdorf REHS Expiration Date: 9/17/29
Authorized Agent's Signature: _____ Date: 9/17/24

See attached site sketch

The issuance of this permit in no way guarantees the issuance of other permits. The permit holder is responsible for checking with appropriate governing bodies in meeting their requirements. This permit is subject to revocation if the site plan, plat, or the intended use changes. The Improvement Permit shall not be affected by a change in ownership of the site. This permit is subject to compliance with the provisions of 15A NCAC 18E and to the conditions of this permit.

Harnett County Environmental Health

File/Permit Number: SFD2407-0084

CONSTRUCTION AUTHORIZATION

County: Harnett PIN/Lot Identifier: 0642-96-0376.000
Owner: KB Home Applicant: _____
Property Location: 102 Robert Howe
Facility Type: SFD (51'x50')

Number of bedrooms: 3 Number of Occupants: 6 Other: _____

New Expansion Repair System Relocation Change of Use
Basement? Yes No Basement Fixtures? Yes No
Crawl Space? Yes No Slab Foundation? Yes No
Type of Wastewater System* Accepted (Initial) Accepted (Repair)

*Please include system classification for proposed wastewater system types in accordance with Rule .1301 Table XXXII

Design Daily Flow: 360 GPD Wastewater Strength: Domestic High Strength Industrial Process Wastewater

Rule .0403(e) Engineering Design Utilizing Low-flow Fixtures and Low-flow Technologies (S.L. 2013-413 and 2014-120)? Yes No
(if yes, please provide engineering documentation)

Effluent Standard: DSE HSE NSF/ANSI 40 TS-I TS-II RCW

Type of Water Supply: Private well Public well Shared well Municipal Supply Spring Other: _____

Installation Requirements/Conditions

Septic Tank Size: 1000 gallons Total Trench/Bed Length: 257 feet Trench/Bed Spacing: 9 feet on center
Trench/Bed Width: 3 inches LTAR: .35 gpd/ft² Usable Depth to LC (Initial)*: 42 ^{*Limiting condition}
Soil Cover: 16 inches Slope Corrected Maximum Trench/Bed Depth†: 28 inches ^{† Measured on the downhill side of the trench}

Pump Tank Size (if applicable): 1000 gallons Requires more than one pump? Yes No

Pump Requirements: _____ ft. TDH vs. _____ GPM Grease Trap Size (if applicable): _____ gallons

Distribution Method: Serial D-Box or Parallel Pressure Manifold(s) LPP Other: _____

Artificial Drainage Required: Yes No If yes, please specify details: _____

Legal Agreements (If the answer is "Yes" to any type of legal agreements, please attach a copy of the agreement.)

Multi-party Agreement Required [Rule .0204(g)]: Yes No

Easement, Right-of-Way, or Encroachment Agreement Required [Rule .0204(d)]: Yes No

Declaration of Restrictive Covenants: Yes No Pre-Construction Conference Required: Yes No

Management Entity Required: Yes No Minimum O&M Requirements: _____

Conditions: _____

The requirements of 15A NCAC 18E are incorporated by reference into this permit and shall be met. Systems shall be installed in accordance with the attached site sketch. This Construction Authorization is subject to revocation if the site plan, plat, or the intended use changes. The Construction Authorization shall not be affected by a change in ownership of the site. This Construction Authorization is subject to compliance with the provisions of 15A NCAC 18E, or 15A NCAC 18A .1900, as applicable, and to the conditions of this permit.

Authorized Agent's Printed Name: Oliver Tolksdorf REHS Expiration Date: 9/17/29
Authorized Agent's Signature: _____ Date: 9/17/24



See attached site sketch

SITE SKETCH

SFD2407-0084

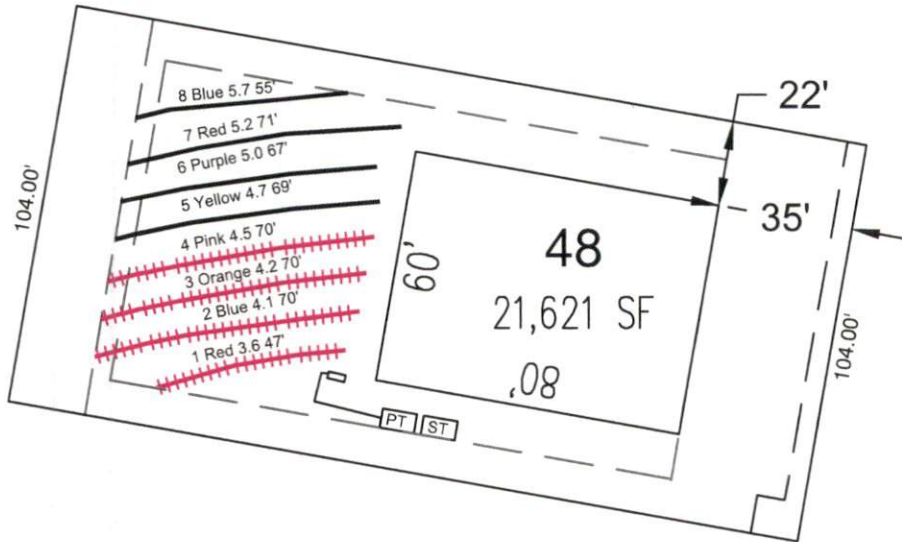
06/15



System: 
 Repair: 

System: Pressure Manifold Lines: 1-4, (257') Ezflow or Chambers 25% 0.35 Soil LTAR 28" Trench Bottom
Repair: Pressure Manifold Lines: 5-8, (262') Accepted Status System 0.35 Soil LTAR 18" Trench Bottom

- *Keep tanks and drain lines 10' from property lines.
- *Not a survey.
- *Not a guarantee of a septic permit.
- *Keep supply lines >5' from property lines.
- *Some lines are flagged longer in the field than lengths indicate.
- *No grading septic area.

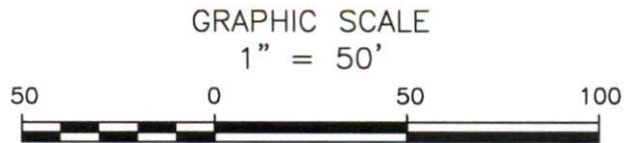

Central Carolina Soil Consulting, PLLC
 1900 South Main Street, Suite 110
 Wake Forest, North Carolina 27587
 Phone (919)569-6704 Fax (919)569-6703

3-Bedroom Septic Layout
 Lot 48, Birchwood Grove Subdivision
 Harnett County, North Carolina

Job# : 3753
Drawn By : LW
Date : 01/09/2024
Revision: