



**ECS Southeast, LLC**  
6151 Raeford Road, Suite A  
Fayetteville, NC 28304  
T 910.401.3288  
F 910.323.0539

# LETTER OF TRANSMITTAL

February 25, 2025  
Mike Bayer & Angie Lyon

Cameron, NC 28326  
ATTN: Angie Lyon

RE: **Bayer-Lyon Home**  
ECS Job # **33:7226**

Permits:  
Location: **1710 Ponderosa Road**  
**Cameron, NC 28326**

Field Reports       For your use       As requested

CC:

ENCL: Field Report # 1      2/25/2025

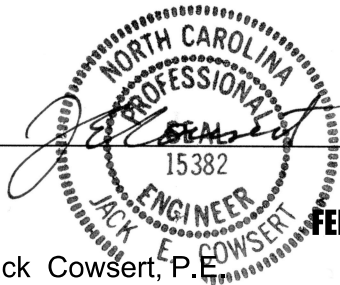

Jack Cowsert, P.E.  
Office Manager

Aaron Kyle Adair  
CMT Senior Project Coordinator

**Disclaimer**

1. This report (and any attachments) shall not be reproduced except in full without prior written approval of ECS.
2. The information in this report relates only to the activities performed on the report date.
3. Where appropriate, this report includes statements as to compliance with applicable project drawings, and specifications for the activities, performed on this report date.
4. Incomplete or non-conforming work will be reported for future resolution.
5. The results of samples and/or specimens obtained or prepared for subsequent laboratory testing will be presented in separate reports/documents.



**ECS Southeast, LLC**  
6151 Raeford Road, Suite A  
Fayetteville, NC 28304  
T 910.401.3288  
F 910.323.0539

# FIELD REPORT

Project **Bayer-Lyon Home**  
Location **Cameron, NC**  
Client **Mike Bayer & Angie Lyon**  
Contractor **None Listed**

Project No. **33:7226**  
Report No. **1**  
Day & Date **Tuesday 2/25/2025**  
Weather **48 °/ Sunny**  
On-Site Time **1.50**  
Lab Time **0.00**  
Travel Time\* **0.00**  
Total **1.50**  
Re Obs Time **0.00**

Remarks

Trip Charges*	Tolls/Parking*	Mileage*	Time of Arrival	Departure
Chargeable Items			<b>10:30A</b>	<b>12:00P</b>

\* Travel time and mileage will be billed in accordance with the contract.

**Summary of Services Performed (field test data, locations, elevations & depths are estimates) & Individuals Contacted.**

The undersigned arrived on site, as requested, to check the bearing capacity of soils via hand auger/DCP method (ASTM STP-399) for the stem wall foundation. Please see the attached sketch and data sheet for details.

A total of 3 hand auger/DCP evaluations were performed to the depth of design soil sub grade elevation. It is to the opinion of that the materials in place (at the locations and elevations tested) did appear to be suitable to support a design bearing capacity of 2,000 psf.

ECS will return, upon request, to perform additional services.

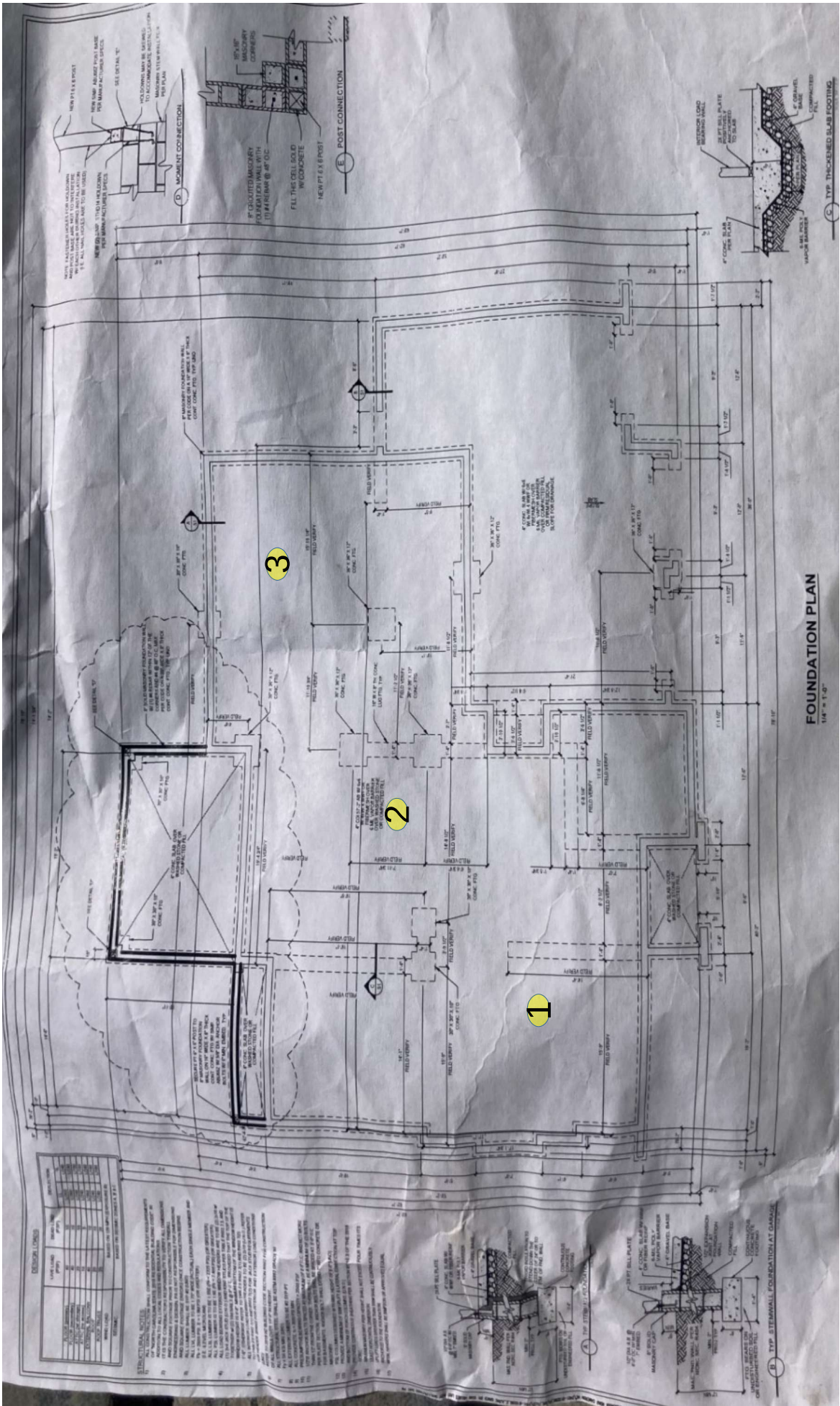

**Key (NTS)**  
DCP / Hand Auger Boring  
Test Locations --- #

Todd T. Davis  
02/25/2025  
Bayer-Lyon Home  
Proj #: 7226  
W/O # 82689



Todd T. Davis  
02/25/2025  
Bayer-Lyon Home  
Proj #: 7226  
W/O # 82689

**Key (NTS)**

View of Bayer-Lyon Home Lot --  
1710 Ponderosa Road





Todd T. Davis  
02/25/2025  
Bayer-Lyon Home  
Proj #: 7226  
W/O # 82689

**Key (NTS)**

View of Bayer-Lyon Home Lot --  
1710 Ponderosa Road





Todd T. Davis  
02/25/2025  
Bayer-Lyon Home  
Proj #: 7226  
W/O # 82689

**Key (NTS)**

View of Bayer-Lyon Home Lot --  
1710 Ponderosa Road



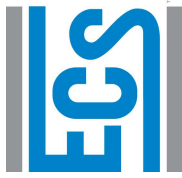

# Report of Foundation Observations

Project: Bayer-Lyon Home  
 Location: 1710 Ponderosa Road  
 Cameron - Harnett - NC - 28326  
 ECS Project No. : 33:7226  
 Date: 2/25/2025

General Location: \_\_\_\_\_  
 Footing Type: \_\_\_\_\_  
 Design Bearing Pressure: 2000

Test No.	Location	Size		Footing Bottom Elevation		Depth of Undercut	Description of Steel Placed	Description of Foundation Subgrade Material	Depth of Test*	Number of Blows
		Design	Actual	Design	Actual**					
1	See Attached Drawing	W	0' 0"			0' 0"		(0) Tan-Orange Silty Sand (1-2) Tan-Grey Silty Sand (3) Tan Silty Sand	0 to -3'	(0)6,7,9 (1)
		D	0' 0"							
		L	0' 0"							
2	See Attached Drawing	W	0' 0"			0' 0"		(0-2) Tan-Orange Silty Sand (3) Tan-Grey Silty Sand	0 to -3'	(0)10,12,15 (1)
		D	0' 0"							
		L	0' 0"							
3	See Attached Drawing	W	0' 0"			0' 0"		(0-3) Tan-Orange Silty Sand	0 to 3'	(0)6,7,8 (1)
		D	0' 0"							
		L	0' 0"							

\* Depth of DCP, or other methods of determining the soil stiffness

\*\* Subgrade elevation reported by any means the contractor provided

By: Todd Davis  
 ECS Southeast, LLC  
 WO: 82689