

THIS LETTER IS INTENDED SOLELY FOR THE CLIENT LISTED AND ADDRESS. THE PURPOSE OF THIS LETTER IS TO PROVIDE A RECORD OF AN INSPECTION.

**FOUNDATION PLAN:
POINTLOADS FOR ENGINEERED BEAM**
SCALE: $\frac{1}{4}" = 1'-0"$

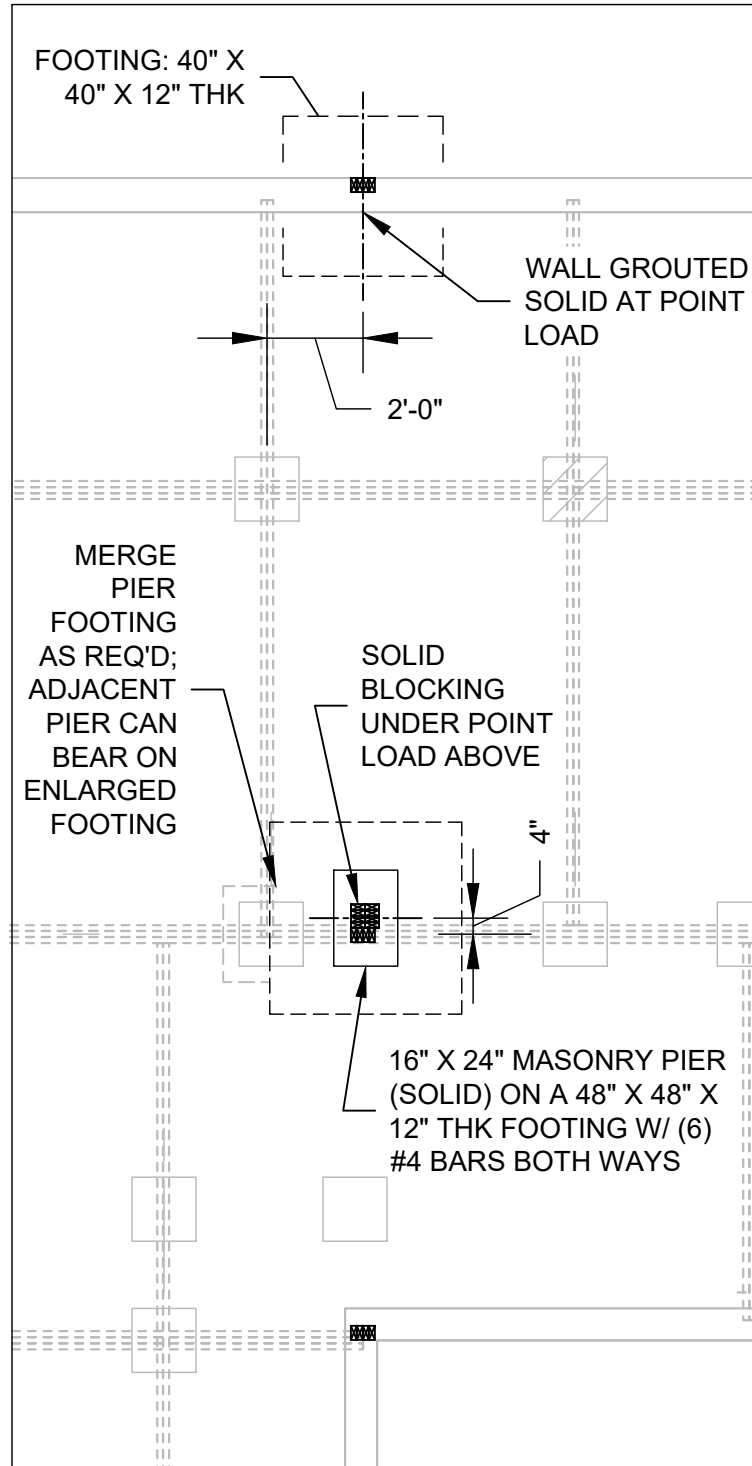

**ENDURE
ENGINEERING**

ENDURE ENGINEERING, PLLC (P-2662)
2309 FURLONG PL., EASTOVER, NC 28312
(910) 850-4043
www.endureengineering.com



PROJECT DETAILS

CLIENT: R AND E HOME BUILDERS

CLIENT EMAIL:

SCOPE OF WORK: STRUCTURAL LETTER

ADDRESS: 117 Knight Road

Harnett County NC

DATE: 11/14/2024

ENG: CLH

PROJECT #

24-1-5-106

SHEET #

S1

THIS LETTER IS INTENDED SOLELY FOR THE CLIENT LISTED AND ADDRESS. THE PURPOSE OF THIS LETTER IS TO PROVIDE A RECORD OF AN INSPECTION.

1ST FLOOR CEILING / WALL PLAN:
POINTLOADS FOR ENGINEERED BEAM
SCALE: $\frac{1}{4}" = 1'-0"$

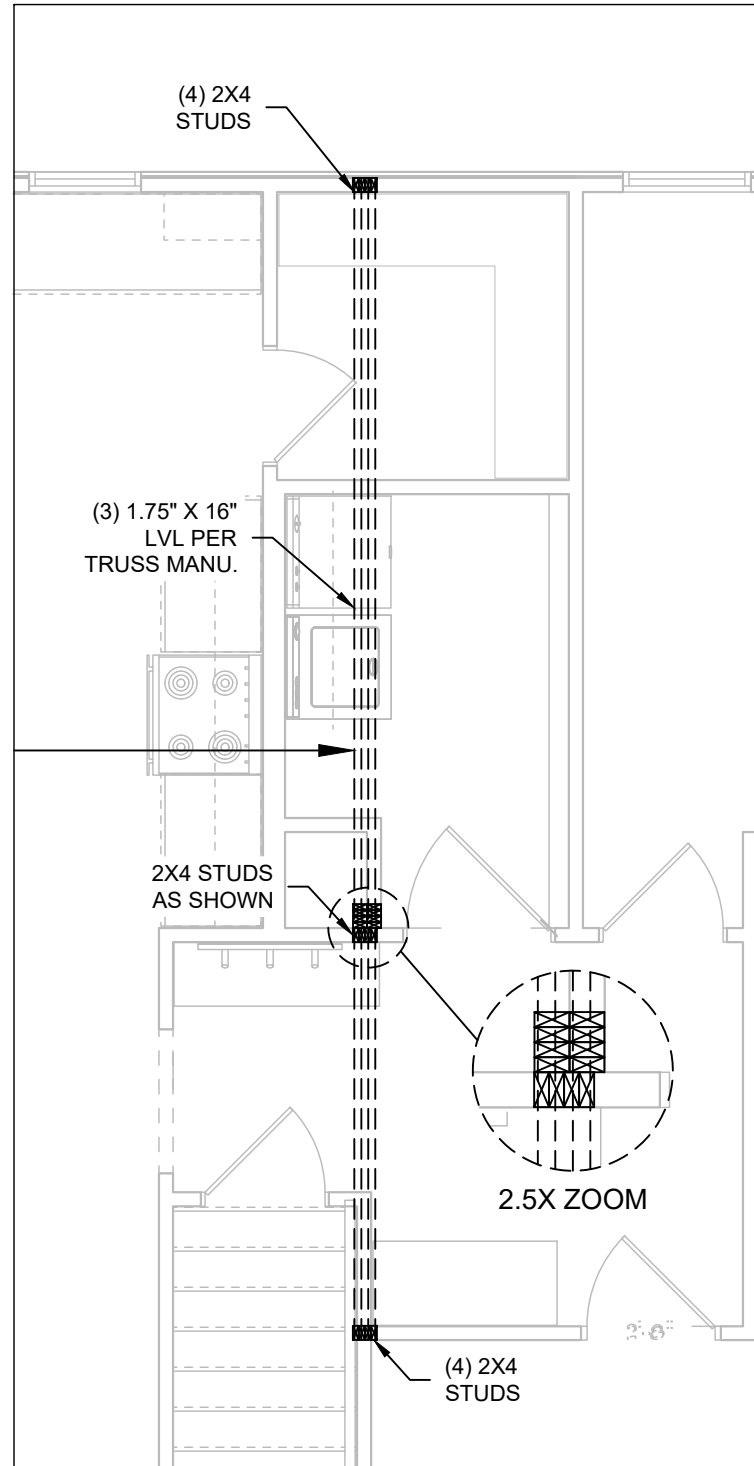

ENDURE ENGINEERING

ENDURE ENGINEERING, PLLC (P-2652)
2309 FURLONG PL., EASTOVER, NC 28312
(910) 850-4043
www.endureengineering.com

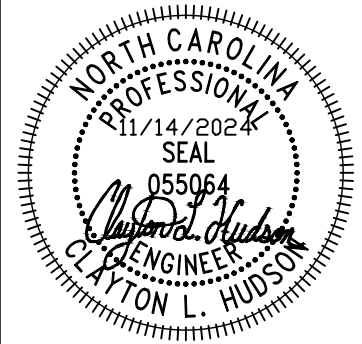

PROJECT DETAILS

CLIENT: R AND E HOME BUILDERS
CLIENT EMAIL:
SCOPE OF WORK: STRUCTURAL LETTER
ADDRESS: 117 Knight Road
Harnett County NC
DATE: 11/14/2024
ENG: CLH

PROJECT #

24-1-5-106

SHEET #

S2