





System: 
 Repair: 

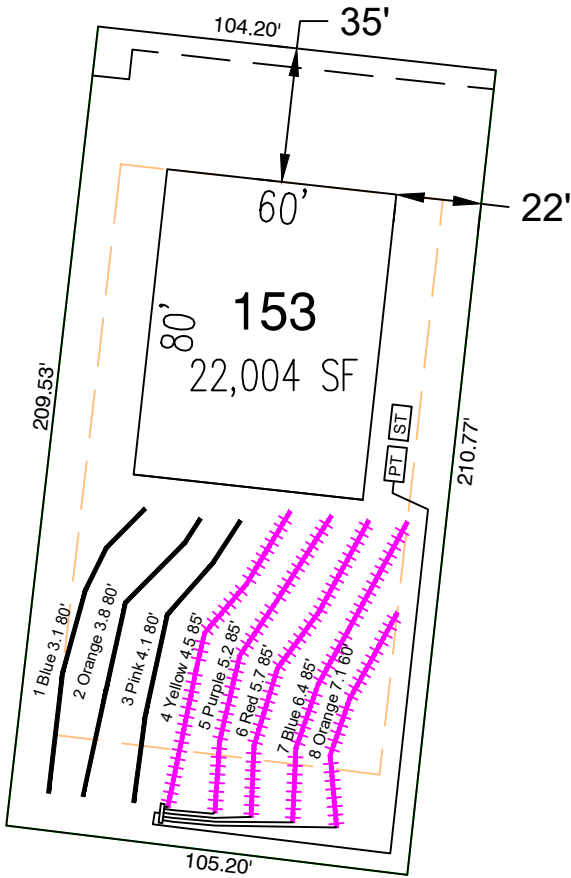

- *Keep tanks and drain lines 10' from property lines.
- *Not a survey.
- *Not a guarantee of a septic permit.
- *Keep supply lines >5' from property lines.
- *Some lines are flagged longer in the field than lengths indicate.
- *No grading septic area.

| |
|---|
| System: Pressure Manifold Lines: 4-8, (400') Accepted Status System 0.35 Soil LTAR 18" Trench Bottom |
| Repair: Pressure Manifold Lines: 1-3, (240') T&J Panel 50% Reduction 0.35 Soil LTAR 18" Trench Bottom |

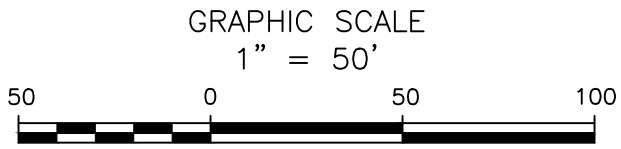

Central Carolina Soil Consulting, PLLC
 1900 South Main Street, Suite 110
 Wake Forest, North Carolina 27587
 Phone (919)569-6704 Fax (919)569-6703

4-Bedroom Septic Layout
 Lot 153, Birchwood Grove Subdivision
 Harnett County, North Carolina

| |
|-------------------|
| Job# : 3753 |
| Drawn By : LW |
| Date : 01/09/2024 |
| Revision: |