

4-Bedroom Septic Plan
 Lot #66 – Duncan’s Crossing
 Harnett County
 Smith Douglas Homes

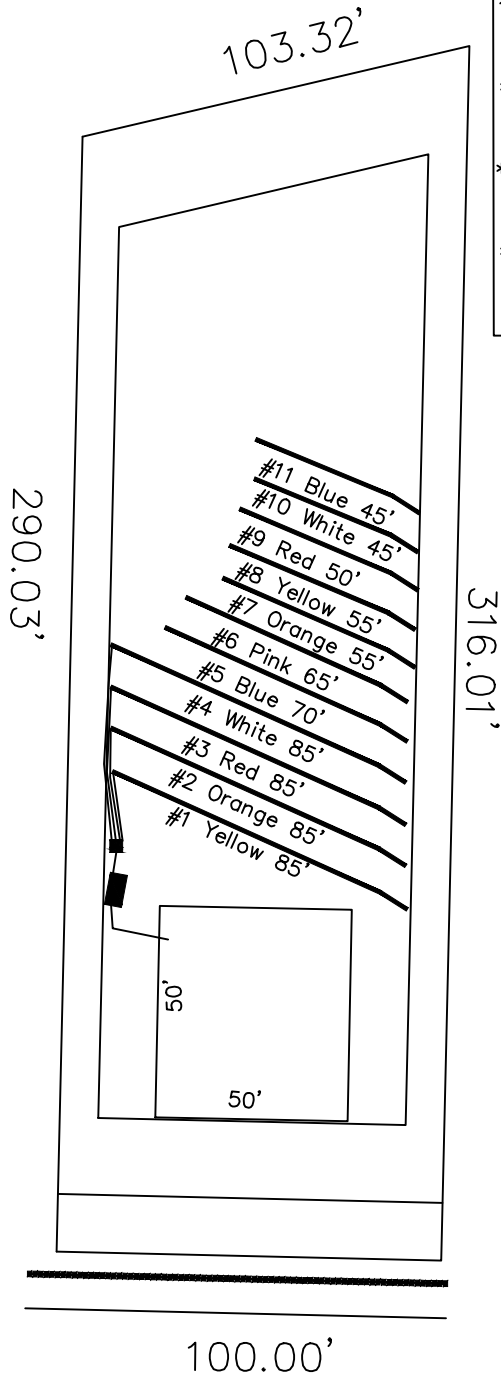

- *House footprint to be field staked by surveyor and system verified prior to any construction
- **Septic area must not be altered by construction activities.
- ***No cuts of 2' or greater within 15' of septic area
- **** Recommend protective barrier around septic field during construction.

66

30,312 SF
 (0.70 AC)

*If plumbing is not sufficient a pump tank will be required to septic field.

System: Gravity to D-Box
 Lines: Lines 1-4 (340')
 0.4 LTAR
 24" Max Trench Bottom
 Accepted Status System
 Repair: Serial Dist.
 Lines: Lines 5-11 (360+)
 0.35 LTAR
 18" Trench Bottom
 Accepted Status System

DOUBLE BARRELL STREET
 50' R/W (PUBLIC & UTILITY ACCESS)

GRAPHIC SCALE
 1" = 50'



Adams
 Soil Consulting
 919-414-6761
 Job #1146