



ECS Southeast, LLC

6151 Raeford Road, Suite A
Fayetteville, NC 28304
9104013288
9103230539

LETTER OF TRANSMITTAL

July 17, 2024
PoP Homes - RDU, LLC

Clayton, NC 27520
ATTN: Robert Whitfield

RE: **Wondertown Lots**
ECS Job # **33:6748-A**

Permits:
Location: **607, 611, and 613 Wondertown Dr**
Erwin, NC 28339

Field Reports For your use As requested

CC:

ENCL: Field Report # 3 7/15/2024

Jack Cowsert, P.E.
Office Manager

Aaron Kyle Adair
CMT Senior Project Coordinator

Disclaimer

1. This report (and any attachments) shall not be reproduced except in full without prior written approval of ECS.
2. The information in this report relates only to the activities performed on the report date.
3. Where appropriate, this report includes statements as to compliance with applicable project drawings, and specifications for the activities, performed on this report date.
4. Incomplete or non-conforming work will be reported for future resolution.
5. The results of samples and/or specimens obtained or prepared for subsequent laboratory testing will be presented in separate reports/documents.



ECS Southeast, LLC
6151 Raeford Road, Suite A
Fayetteville, NC 28304
(910) 401-3288 [Phone]
(910) 323-0539 [Fax]

FIELD REPORT

Project **Wondertown Lots**
Location **Erwin, NC**
Client **PoP Homes - RDU, LLC**
Contractor **PoP Homes - RDU, LLC**

Project No. **33:6748-A**
Report No. **3**
Day & Date **Monday 7/15/2024**
Weather **90 °/ Sunny**
On-Site Time **2.00**
Lab Time **0.00**
Travel Time* **0.00**
Total **2.00**
Re Obs Time **0.00**

Remarks

Trip Charges*	Tolls/Parking*	Mileage*	Time of Arrival	Departure
Chargeable Items			9:30A	11:30A

* Travel time and mileage will be billed in accordance with the contract.

Summary of Services Performed (field test data, locations, elevations & depths are estimates) & Individuals Contacted.

ECS Representative arrived on site, as requested, to check the bearing capacity of soils via hand auger/DCP method (ASTM STP-399) for monolithic slab for lot 613. Please see the attached sketch and data sheet for details.

A total of 4 hand auger/DCP evaluations were performed to a depth of approximately 4 feet below the current slab subgrade elevation. Test results indicated that the materials in place (at the locations and elevations tested) did appear to be suitable to support the design bearing capacity of 2,000 psf.

ECS will return upon request to provide additional services.

- EXTERIOR DIMENSIONS ARE TO FACE OF SHEATHING
- INTERIOR DIMENSIONS ARE TO FACE OF STUD

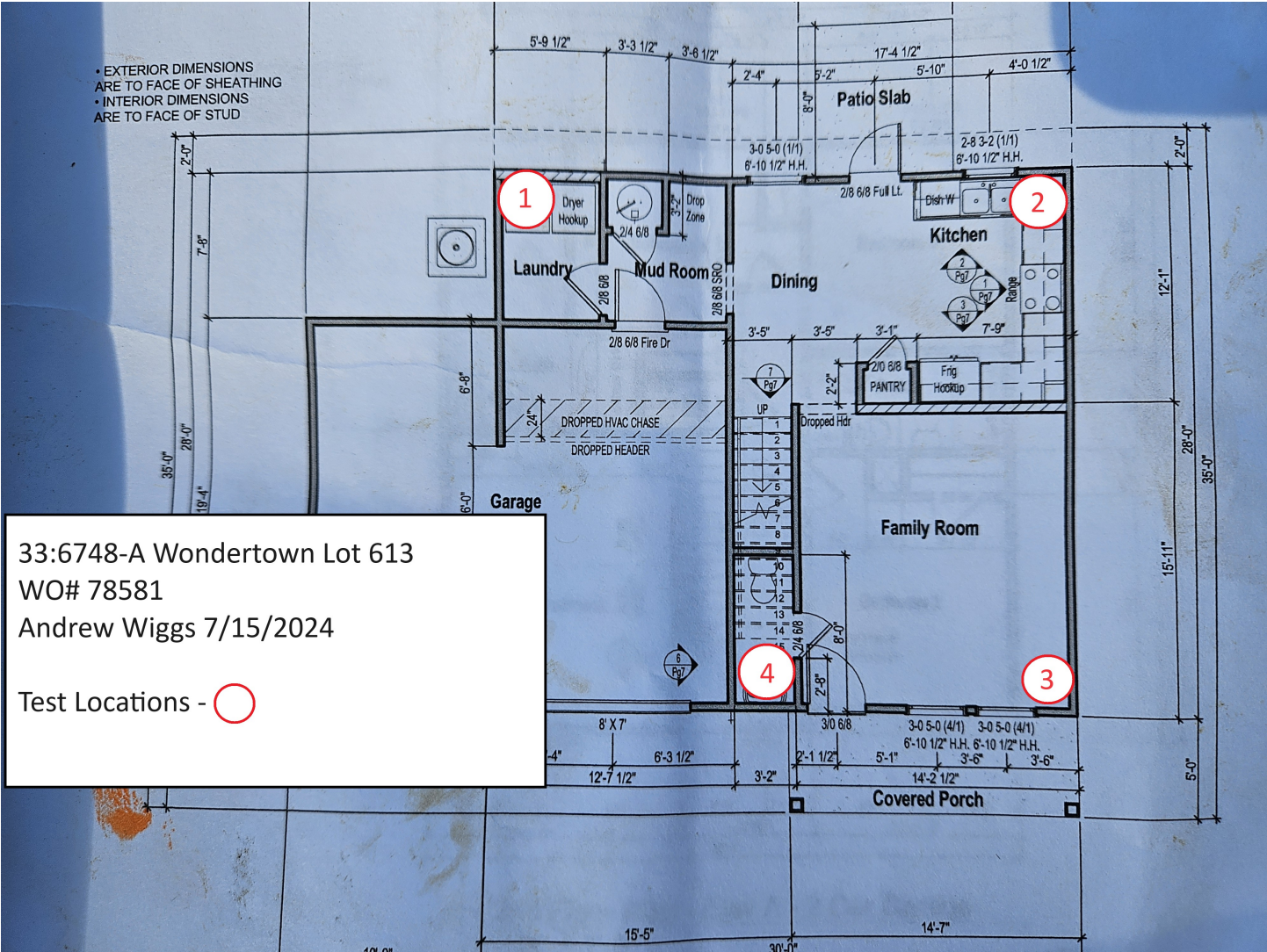

33:6748-A Wondertown Lot 613
 WO# 78581
 Andrew Wiggs 7/15/2024

Test Locations - ○



Report of Spread Footing - Foundation Observations

Project: Wondertown Lots
 Location: 607, 611, and 613 Wondertown Dr
Erwin - Cumberland - NC - 28339
 Contractor: PoP Homes - RDU, LLC

Project No.: 33:6748-A
 Day/Date: 7/15/2024

Footing Number	Location	Size (W x H x L)		Footing Bottom Elevation		Description of Steel Placed	Description of Subgrade Material	Required Blow Counts	Design Bearing Pressure
		Design	Actual	Design **	Depth of Undercut (in)			# of Blows / Increment	
1	NW Corner	x x	x x	0.0			(0) tan silty sand (-1/-3) brown silty sand	6 (0)5,4,5;(-1)4,5,5;(-2)6,6,7;(-3)8,10,13	2000
2	NE Corner	x x	x x	0.0			(0/-3) brown silty sand	6 (0)6,4,5;(-1)3,6,6;(-2)10,10,12;(-3)11,12,13	2000
3	SE Corner	x x	x x	0.0			(0) gray silty sand (-1/-3) brown silty sand	6 (0)4,6,7;(-1)8,10,13;(-2)12,25+;(-3)10,8,6	2000
4	SW Corner	x x	x x	0.0			(0/-3) brown silty sand	6 (0)6,9,6;(-1)3,4,4;(-2)3,5,8;(-3)8,8,8	2000

** SGE: Subgrade Elevation to be determined by surveyor.

By: Andrew Wiggs

ECS Southeast, LLC

WO: 78581

Attachments



Lot 613

Figure 1