

NOTES:  
1. ALL FINAL MATERIALS ARE TO BE CHOSEN BY THE HOME OWNER.  
2. FINAL NUMBER OF EXTERIOR STEPS WILL BE DETERMINED ON SITE BY GRADE.  
3. CONTRACTOR MUST MEET OR EXCEED ALL APPLICABLE LOCAL, STATE AND FEDERAL REQUIREMENTS.  
4. CONTRACTOR ASSUMES NO RESPONSIBILITY FOR CHANGES TO DRAWINGS BY OTHERS DURING CONSTRUCTION.  
5. ALL STRUCTURAL INFO SHOWN ON PLANS ARE FOR INFORMATION ONLY. CONTRACTOR SHALL OBTAIN ALL NECESSARY STRUCTURAL ENGR. REVIEW AND DESIGN ALL STRUCTURAL ELEMENTS.

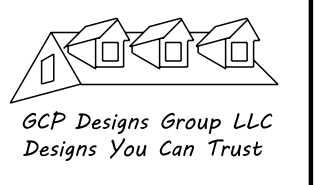

DATE: 6-26-2024  
SUBDIVISION:  
BUILDER:

**SOUTHEASTERN CONSTRUCTION  
HOMES & DEVELOPMENT**

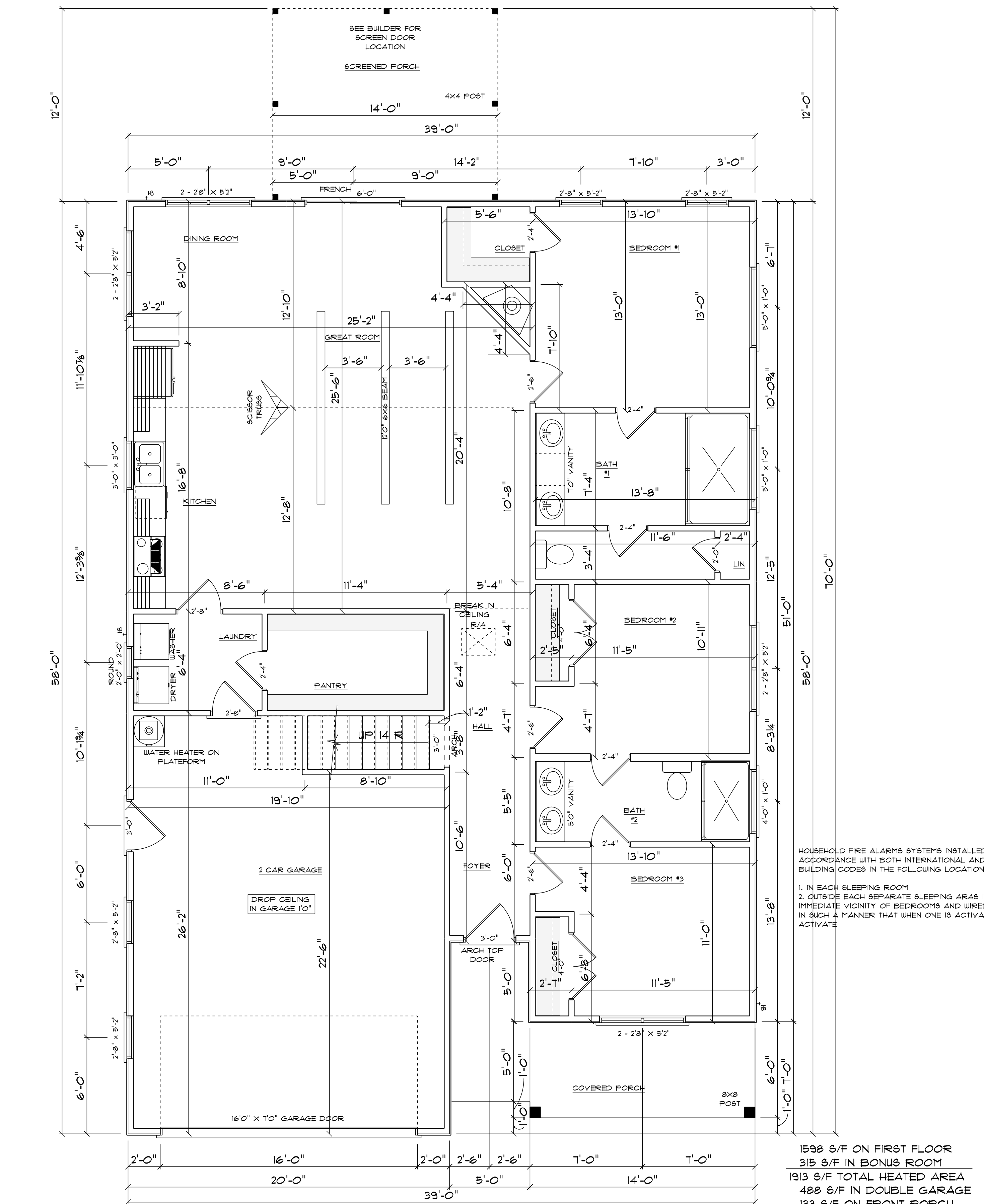

HOUSING D FIRE ALARMS SYSTEMS INSTALLED IN ACCORDANCE WITH BOTH INTERNATIONAL AND LOCAL BUILDING CODES IN THE FOLLOWING LOCATIONS:  
1. IN EACH SLEEPING ROOM  
2. OUTSIDE EACH SEPARATE SLEEPING AREAS IN THE IMMEDIATE VICINITY OF BEDROOMS AND WIRING TOGETHER IN SUCH A MANNER THAT WHEN ONE IS ACTIVATED ALL SHALL ACTIVATE

8'0" FINISHED CEILING HEIGHT ON FIRST FLOOR  
6'8" WINDOW HEADER HEIGHT ON FIRST FLOOR  
8'0" FINISHED CEILING HEIGHT ON SECOND FLOOR  
6'8" WINDOW HEADER HEIGHT ON SECOND FLOOR  
CANTILEVER ALL ROOF TRUSSES  
DROP CEILING IN GARAGE 1'0"

**FIRST FLOOR**  
SCALE: 1/4" = 1'0"

1598 S/F ON FIRST FLOOR  
315 S/F IN BONUS ROOM  
1913 S/F TOTAL HEATED AREA  
488 S/F IN DOUBLE GARAGE  
133 S/F ON FRONT PORCH  
168 S/F ON REAR PORCH

ELECTRICAL CONTRACTOR TO CONFIRM LOCATION OF OUTLET AND FIXTURES, SEE HOME OWNER FOR TYPE AND STYLE OF ELECTRICAL FIXTURES

NOTE:  
BUILDING CONTRACTOR TO MEET LOCAL WIND LOADS PER LOCAL CODE AS IT PERTAINS TO LOCATION OF HOUSE (ICC, IBC, IRC, IFC, IFBC, IFPC)