



ECS Southeast, LLC

6151 Raeford Road, Suite A
Fayetteville, NC 28304
9104013288
9103230539

LETTER OF TRANSMITTAL

October 21, 2024
Carolina Construction Commercial & Residential of
Fayetteville
404 Hope Mills Road Suite B1
Fayetteville, NC 28304
ATTN: Ronnie Smith

RE: **Ray Road - Lot 5**
ECS Job # **33:7054-B**

Permits:
Location: **5011 Ray Road**
Spring Lake, NC 28390

CC: Carolina Construction Commercial & Residential of
Fayetteville - Samantha Hitchings

Carolina Construction Commercial & Residential of
Fayetteville - Walter Miller

ENCL: Field Report # 1 10/18/2024



OCT 21 2024

Jack Cowsert, P.E.
Office Manager

Ryan H. Parrish
CMT Group Supervisor

Disclaimer

1. This report (and any attachments) shall not be reproduced except in full without prior written approval of ECS.
2. The information in this report relates only to the activities performed on the report date.
3. Where appropriate, this report includes statements as to compliance with applicable project drawings, and specifications for the activities, performed on this report date.
4. Incomplete or non-conforming work will be reported for future resolution.
5. The results of samples and/or specimens obtained or prepared for subsequent laboratory testing will be presented in separate reports/documents.



ECS Southeast, LLC
 6151 Raeford Road, Suite A
 Fayetteville, NC 28304
 (910) 401-3288 [Phone]
 (910) 323-0539 [Fax]

FIELD REPORT

Project **Ray Road - Lot 5**
 Location **Spring Lake, NC**
 Client **Carolina Construction Commercial & Residential**
 Contractor **Carolina Construction Commercial & Residential**

Project No. **33:7054-B**
 Report No. **1**
 Day & Date **Friday 10/18/2024**
 Weather **80 °/ Sunny**
 On-Site Time **1.00**
 Lab Time **0.00**
 Travel Time* **0.00**
 Total **1.00**
 Re Obs Time **0.00**

Remarks

Trip Charges*	Tolls/Parking*	Mileage*	Time of Arrival	Departure
Chargeable Items			10:45A	11:45A

* Travel time and mileage will be billed in accordance with the contract.

Summary of Services Performed (field test data, locations, elevations & depths are estimates) & Individuals Contacted.

ECS arrived on site, as requested, to check the bearing capacity of soils via hand auger/DCP method (ASTM STP-399) for stem wall backfill. Please see the attached sketch and data sheet for details.

A total of 3 hand auger/DCP evaluations were performed to a depth of approximately 3 feet below the current backfill sub grade elevation. Test results indicated that the materials in place (at the locations and elevations tested) did appear to be suitable to support the design bearing capacity of 2,000 psf.

ECS will return upon request to provide additional services.

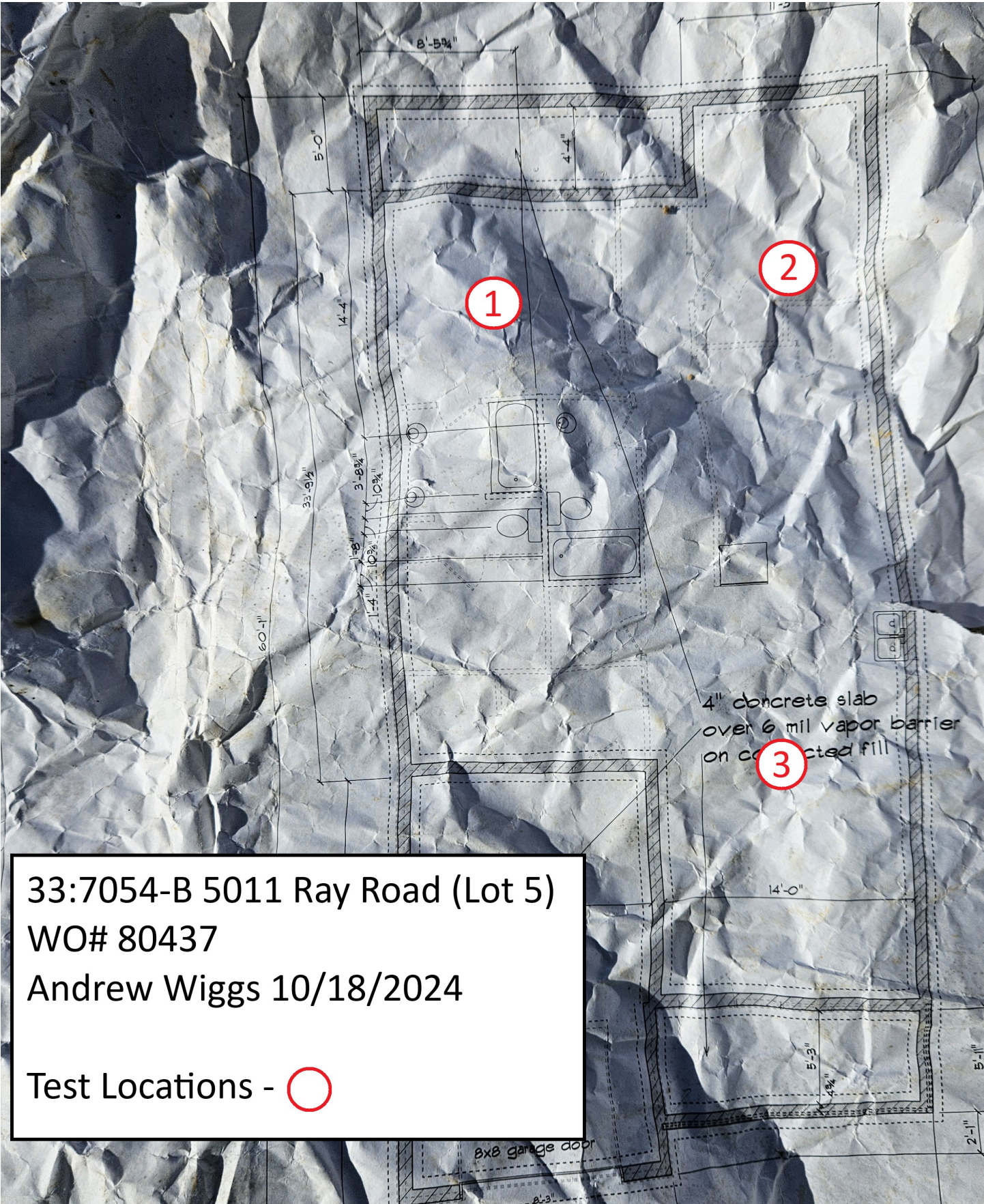

33:7054-B 5011 Ray Road (Lot 5)
WO# 80437
Andrew Wiggs 10/18/2024

Test Locations - ○



ECS Southeast, LLC
 Fayetteville, NC
 Phone: 910-401-3288

DYNAMIC CONE PENETROMETER TEST REPORT

Project: 5011 Ray Road (Lot 5)								Design Bearing Capacity: 2000 psf
Project No: 7054-B								Stem Wall Backfill
Technician: Andrew Wiggs								
Date: 10/18/2024								
Test Location	Water Table Depth	Test Depth	Footing Dimensions	Penetrometer Blow Counts				Remarks/Soil Descriptions
				1 3/4"	1 3/4"	1 3/4"	Average	
1		0		6	11	9	10	Brown Clayey Sand
1		-1		6	10	9	9.5	Gray Sand
1		-2		6	8	9	8.5	Gray Sand
1		-3		10	13	15	14	Gray Sand
2		0		6	10	8	9	Brown Clayey Sand
2		-1		6	8	10	9	Brown Clayey Sand
2		-2		6	7	13	10	Gray Sand
2		-3		11	11	12	11.5	Gray Sand
3		0		12	10	13	11.5	Brown Clayey Sand
3		-1		7	10	12	11	Brown Clayey Sand
3		-2		7	7	10	8.5	Gray Sand
3		-3		4	7	7	7	Gray Sand

Attachments



overview

Figure 1