

1. All bracing, blocking, beams, purlins @ 2'0" o.c., ledger, etc. provided by others.
2. Roof truss to roof truss connections provided by Riverside Roof Truss.
3. Truss to building connections provided by others.

Refer to Sealed drawings for connection detail of multiple ply trusses.

NOT ALL TRUSSES ARE SYMMETRICAL AND MAY NOT PERFORM CORRECTLY IF INSTALLED BACKWARDS. PLEASE REFER TO SEALS WHILE SETTING TRUSSES TO ENSURE TRUSSES ARE ORIENTED CORRECTLY

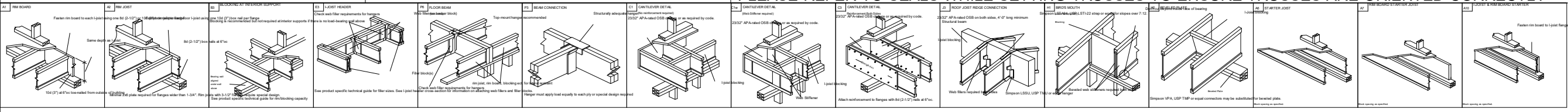

SHOP DRAWING APPROVAL
 THIS LAYOUT IS THE SOLE SOURCE FOR FABRICATION OF TRUSSES AND VOIDS ALL PREVIOUS ARCHITECTURAL OR OTHER TRUSS LAYOUTS. REVIEW AND APPROVAL OF THIS LAYOUT MUST BE RECEIVED BEFORE ANY TRUSSES WILL BE BUILT. VERIFY ALL CONDITIONS TO INSURE AGAINST CHANGES THAT WILL RESULT IN EXTRA CHARGES TO YOU.

REVIEWED BY: _____ APPROVED BY: _____ DATE: _____

Products					
Net Qty	Plies	Product	Length	PlotID	
4	2	1 3/4" x 9 1/4" (2.0E 3100) LVL	8-00-00	WHBM22	
2	2	1 3/4" x 9 1/4" (2.0E 3100) LVL	6-00-00	BM30	
2	2	1 3/4" x 9 1/4" (2.0E 3100) LVL	6-00-00	WHBM20	
2	2	1 3/4" x 11 7/8" (2.0E 3100) LVL	22-00-00	GDH BM23	
2	2	1 3/4" x 11 7/8" (2.0E 3100) LVL	12-00-00	GDH BM29	
2	2	1 3/4" x 11 7/8" (2.0E 3100) LVL	10-00-00	WHBM21	
2	2	1 3/4" x 14" (2.0E 3100) LVL	10-00-00	WHBM17	

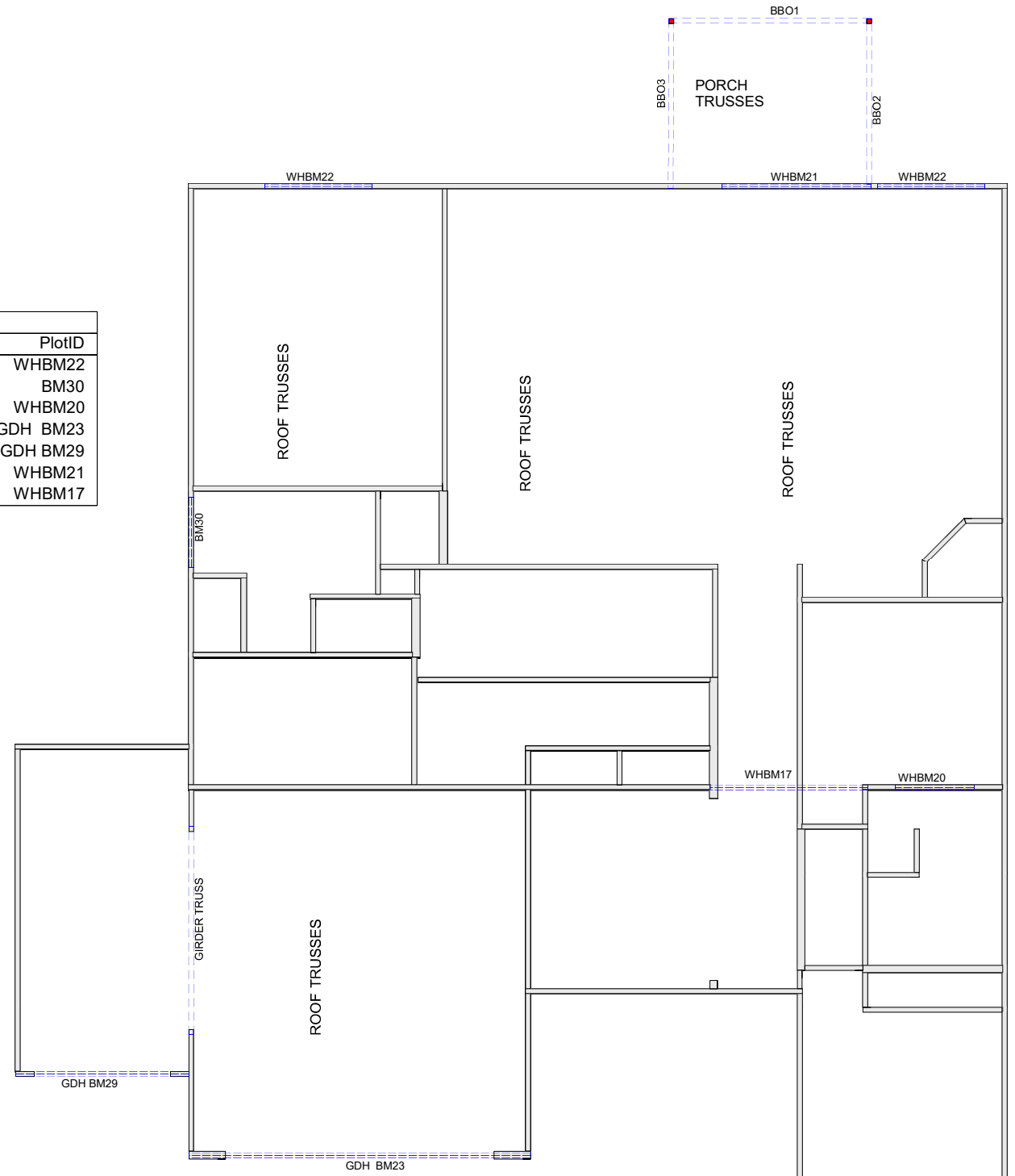

Hanger Conversion Chart

USP	Simpson
JUS26	LUS26
THD26	HUS26
THD26-2	HHUS26-2
HJC26	THJA26
MSH422	THA422

Client: **MATTAMY HOMES**
 Job Name: **CLEARWATER - FRENCH COUNTRY**
 Model: **1ST FLOOR HEADERS**
 Lot #: **8**
 Order #: **24-3350-B** Designer: **R S** Date: **5/30/2024**
 Sales Rep: **C Walden**

733 RIVER PARK DRIVE DANVILLE, VA 24540 (434) 793-0217 FAX: (434) 799-8767

RIVERSIDE ROOF TRUSS, LLC

Roof Surface Area: **0 ft²** Sq. Ft.
 Floor Surface Area: **3137 ft²** Sq. Ft.

