

# Harnett County Department of Public Health

PERMIT # SFD 2406-0058

## Operation Permit

☒ New Installation ☒ Septic Tank ☒ Nitrification Line ☐ Repair ☐ Expansion

PROPERTY LOCATION: 226 Hawksmoore Ln

Name: (owner) DR. Horton SUBDIVISION McKay Place LOT # 28

System Installer: Jason Matthews

Basement with plumbing: ☐ Garage ☒ Number of Bedrooms 4 (8 people)

Type of Water Supply: ☐ Community ☒ Public ☐ Well Distance from well \_\_\_\_\_ feet

System Type: Type III g Types V and VI Systems expire in 5 years.

(In accordance with Table V a)

Owner must contact Health Department 6 months prior to expiration for permit renewal.

This system has been installed in compliance with applicable North Carolina General Statutes, Rules for Sewage Treatment and Disposal, and all conditions of the Improvement Permit and Construction Authorization.

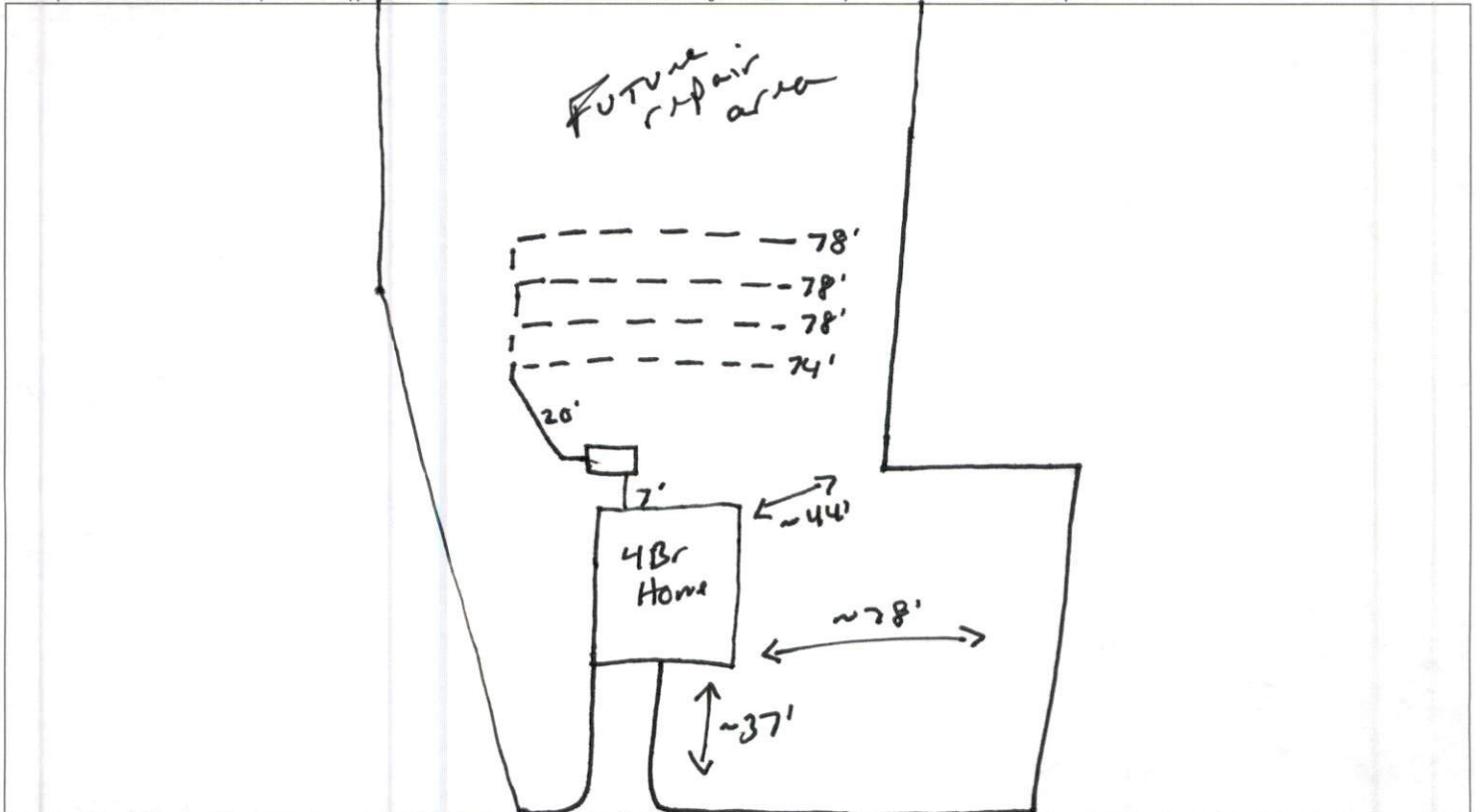

### PERMIT CONDITIONS:

- I. Performance: System shall perform in accordance with Rule .1961.
- II. Monitoring: As required by Rule .1961.
- III. Maintenance: As required by Rule .1961. Other: \_\_\_\_\_  
 Subsurface system operator required? Yes ☐ No ☒  
 If yes, see attached sheet for additional operation conditions, maintenance and reporting.

IV. Operation: \_\_\_\_\_

V. Other: \_\_\_\_\_

☐ D-Box ☐ Pump ☐ Alarm ☐ H2O Line ☐ PWR Line

Following are the specifications for the sewage disposal system on the above captioned property.

Type of system: ☐ Conventional ☒ Other 25% reduction I & Q4 Septic Tank: 1000 gallons Pump Tank: \_\_\_\_\_ gallons

Subsurface No. of exact length width of depth of  
 Drainage Field ditches 1 of each ditch 308 feet ditches 3 feet ditches 20 inches

French Drain Required: \_\_\_\_\_ Linear feet

Authorized State Agent Mel H. REHS Date 7-25-25

# Mckay Place Lot 28 "As Built" Revision approved by Alex Adams Harnett County

\*House footprint to be field staked by surveyor and system verified prior to any construction

\*\*Septic area must not be altered by construction activities.

\*\*\*No cuts of 2' or greater within 15' of septic area

\*\*\*\* Recommend protective barrier around septic field during construction.

\*If plumbing is not sufficient a pump tank will be required to septic field.

INITIAL:  
Lines 1-4 (308")  
Accepted Status  
Gravity Serial  
REPAIR:  
Lines 6-8 (270")  
PPBPS  
Gravity Parallel

Adams  
Soil Consulting  
919-414-6761

