

Harnett County Department of Public Health

PERMIT # SFD2406-0089

Operation Permit

New Installation
 Septic Tank
 Nitrification Line
 Repair
 Expansion

PROPERTY LOCATION: 275 THISTLE CT

Name: (owner) WEAVER HOMES SUBDIVISION WEST PRESERVE LOT # 11

System Installer: YELLOW DOG

Basement with plumbing: Garage Number of Bedrooms 3

Type of Water Supply: Community Public Well Distance from well _____ feet

System Type: IIIg Types V and VI Systems expire in 5 years.

(In accordance with Table V a) Owner must contact Health Department 6 months prior to expiration for permit renewal.

This system has been installed in compliance with applicable North Carolina General Statutes, Rules for Sewage Treatment and Disposal, and all conditions of the Improvement Permit and Construction Authorization.

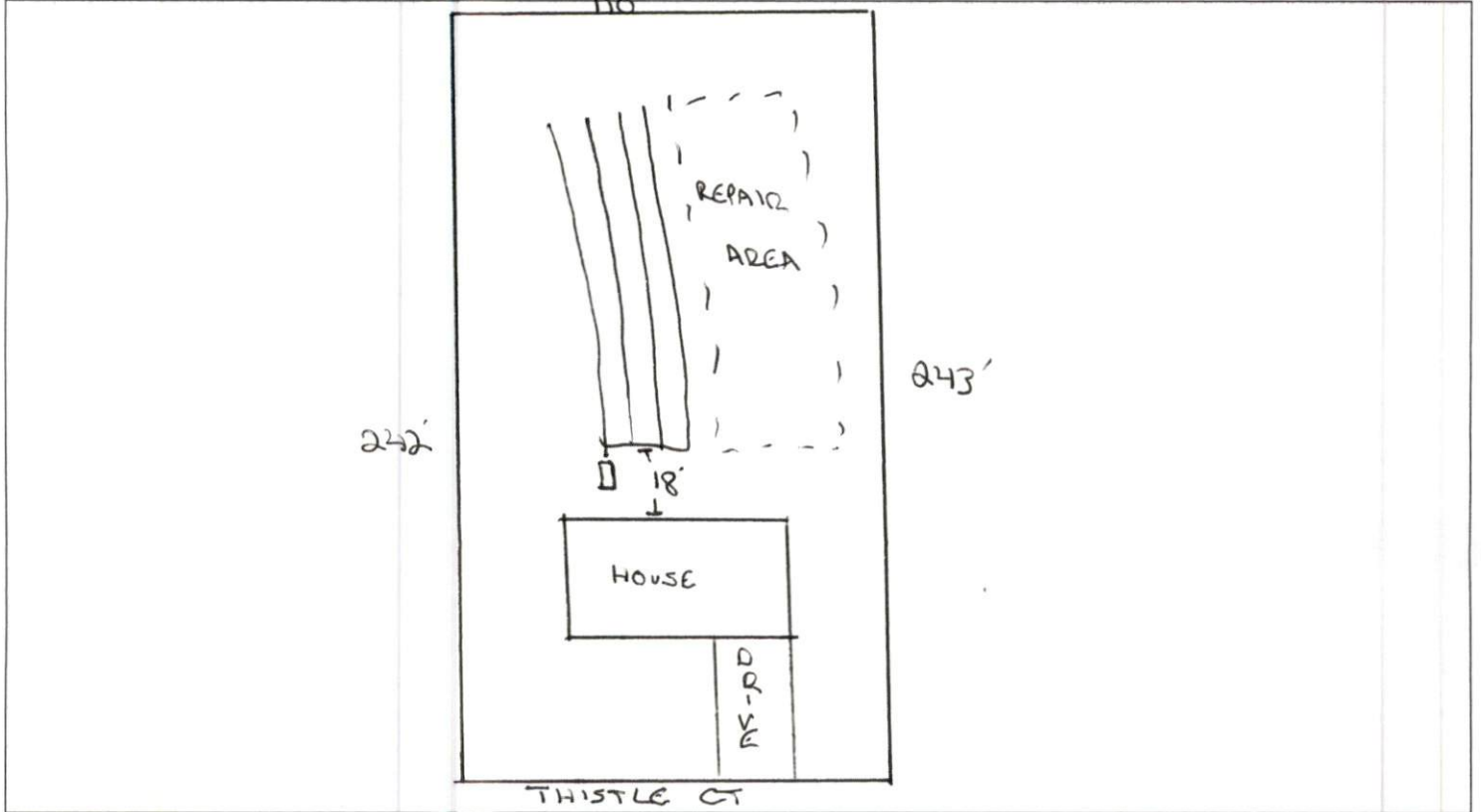

PERMIT CONDITIONS:

I. Performance: System shall perform in accordance with Rule .1961.

II. Monitoring: As required by Rule .1961.

III. Maintenance: As required by Rule .1961. Other: _____

Subsurface system operator required? Yes No

If yes, see attached sheet for additional operation conditions, maintenance and reporting.

IV. Operation: _____

V. Other: _____

D-Box Pump Alarm H2O Line PWR Line

Following are the specifications for the sewage disposal system on the above captioned property.

Type of system: Conventional Other CHAMBER (24) Septic Tank: 1000 gallons Pump Tank: _____ gallons

Subsurface Drainage Field: No. of ditches 1 exact length of each ditch 225 feet width of ditches 3 feet depth of ditches 20 inches

French Drain Required: _____ Linear feet

Authorized State Agent: REHS Date: 10/16/24