

SURVEY FOR
FAMILY BUILDING COMPANY

LOT 27, CAPTAIN'S LANDING SUBDIVISION
KEELBOAT LANE
PIN# 0623-07-0342.000
D.B. 3877, PAGE 718
B.M. 21, PAGE 52
BUCKHORN TOWNSHIP
HARNETT COUNTY, NORTH CAROLINA
MARCH 5, 2024
REVISED MARCH 27, 2024

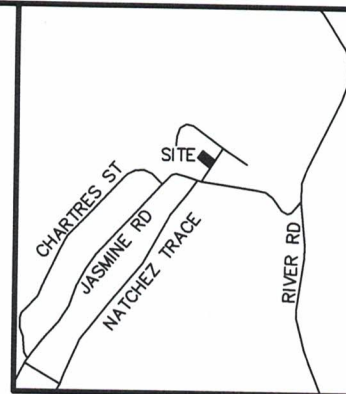

VICINITY MAP

LEGEND:

- EIP - EXISTING IRON PIPE
- EIB - EXISTING IRON BAR
- BEIP - BENT IRON PIPE
- BEIB - BENT IRON BAR
- CM - CONCRETE MONUMENT
- EPK - EXISTING PK NAIL
- SPK - SET PK NAIL
- NIP - NEW IRON PIPE SET
- R/W - RIGHT OF WAY
- CATV - CABLE TV BOX
- EB - ELECTRIC BOX
- TEL - TELEPHONE PEDESTAL
- PP - POWER POLE
- OHL - OVERHEAD LINE
- LP - LIGHT POLE
- WM - WATER METER
- WV - WATER VALVE
- CO - SEWER CLEAN-OUT

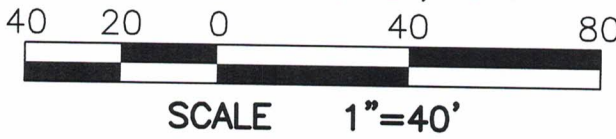

ADOPTED FROM B.M. 21, PAGE 52

LOT 24M
N/F
JAMIE LEE SPRAGUE
D.B. 4225, PAGE 2837
PIN# 0623-07-0535

(25M)
N/F
KATHY GILES
D.B. 1966, PAGE 502
PIN# 0623-07-0477

(26M)
N/F
KATHY GILES
D.B. 1966, PAGE 502
PIN# 0623-07-1452

LOT 19M
N/F
THOMAS RING SR.
D.B. 2183, PAGE 177
PIN# 0613-97-8369

EIB UNKNOWN ORIGIN

(27)
20,124 S.F.
0.462 AC.

(28)
N/F
FAMILY BUILDING COMPANY II LLC
D.B. 4191, PAGE 2464
PIN# 0613-97-9283

EIP

R/W

KEELBOAT LANE 60' PUBLIC R/W

IMPERVIOUS SURFACE TABLE

HOUSE	1,499 S.F.
PATIO	150 S.F.
DRIVEWAY/SIDEWALK	672 S.F.
MISC/UTILITIES	18 S.F.
TOTAL IMPERVIOUS AREA	2,339 S.F.
TOTAL LOT AREA	20,124 S.F.
PERCENTAGE OF IMPERVIOUS AREA	11.62 %

LINE TABLE

LINE	BEARING	DISTANCE
L-1	N 40°28'43" E	146.48'
L-2	N 30°27'00" E	57.43'

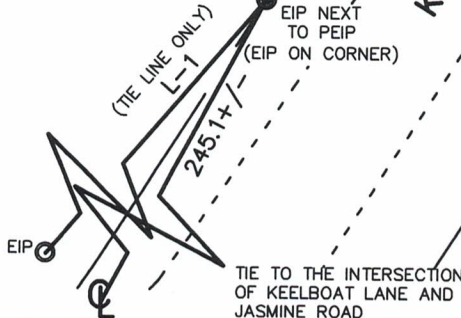

CMP

CAWTHORNE, MOSS
& PANCIERA, P.C.

Professional Land Surveyors
C-1525

333 S. White Street
Post Office Box 1253
Wake Forest, N.C. 27588
(919)556-3148

I DECLARE THAT THIS SURVEY COMPLIES WITH THE NORTH CAROLINA STANDARDS OF PRACTICE FOR SURVEYING, (SECTION 1600) FOR CLASS A SURVEYS AND THAT THE CALCULATED RATIO OF PRECISION BEFORE ADJUSTMENTS IS 1:10,000+. FURTHERMORE, PROPERTY CORNERS SHOWN ARE PRIMARY CONTROL MONUMENTATION FOR THE RE-ESTABLISHMENT OF PROPERTY CORNERS IN THE ABSENCE OF GRID MONUMENTS AND OTHER SUBDIVISION PROPERTY CORNERS. THIS SURVEY IS NOT TO BE RECORDED WITHOUT THE WRITTEN AUTHORIZATION OF THE SURVEYOR.

3/21/2024
PROFESSIONAL LAND SURVEYOR L-3835

