

CURVE	LENGTH	RADIUS	CHORD	CHORD BEARING
C1	60.89'	50.00'	57.20'	S84°49'02"E

NOTE : CONTRACTOR TO LOCATE UTILITY TIE-INS AND CONTACT LOCAL REGULATORY AGENCY PRIOR TO PAVING OVER WITH DRIVEWAY.

ELIZABETH PARKER  
MATTHEWS  
P.I.N. 0514-62-1617  
D.B. 3847, PG. 195

NOTE : CONTRACTOR TO VERIFY ALL BUILDING SETBACKS PRIOR TO CONSTRUCTION.

SETBACKS (FROM OLD UDO):
FRONT - 35'
REAR - 25'
SIDE - 10'
SIDE STREET - 20'

VICINITY MAP  
(NO SCALE)

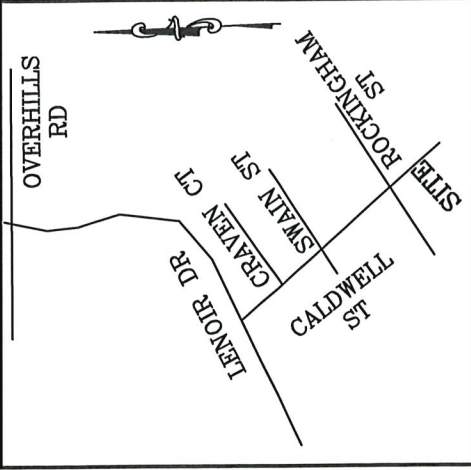

OWEN DRIVE  
50 FT. PUBLIC R/W

5  
0.60 ACRES  
26,237 SQ. FT.

4  
OVERHILLS CREEK  
SECTION 8  
P.B. 2023,  
PG. 443

20' SEWER UTILITY EASEMENT  
N47°29'36"E 210.43'

N87°01'54"W 299.51'

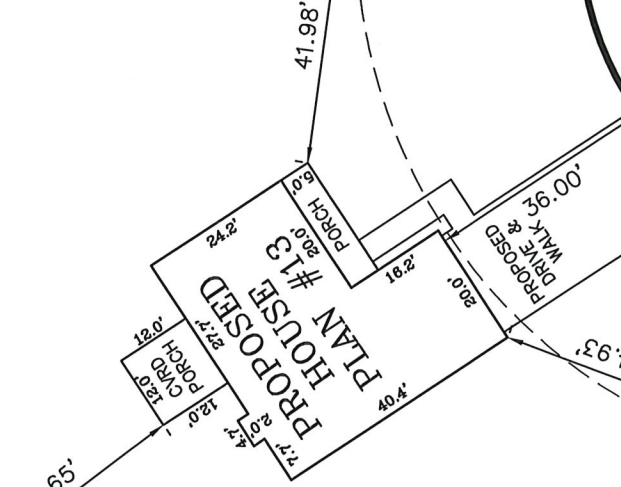

PROPOSED HOUSE #13  
PORCH 12.0'  
24.2'  
27.7'  
20.0'  
36.00'  
PROPOSED DRIVE & SIDEWALK  
20.0'  
34.93'

20' DRAINAGE EASEMENT  
S29°42'15"E 175.60'

6  
OVERHILLS CREEK  
SECTION 8  
P.B. 2023, PG. 443

CALDWELL STREET  
50 FT. PUBLIC R/W

IMPERVIOUS AREA:  
HOUSE, PORCHES 1,545 SQ. FT.  
DRIVEWAY, SIDEWALK 748 SQ. FT.  
TOTAL 2,293 SQ. FT.

PLOT PLAN

PLOT PLAN FOR: WELLONS CONSTRUCTION  
ADDRESS: CALDWELL STREET  
CITY OF: SPRING LAKE, NC  
COUNTY OF: HARNETT

TOWNSHIP OF: ANDERSON CREEK  
DATE: MARCH 22ND, 2024  
SCALE: 1" = 30'  
REFERENCE: LOT 5  
OVERHILLS CREEK  
SECTION 8  
P.B. 2023, PG. 443



W. Larry King PLS 1339

W. LARRY KING, PLS - L-1339

Larry King & Associates, R.L.S., P.A.

P.O. Box 53787  
1333 Morganton Road, Suite 201  
Fayetteville, NC 28305  
Phone: (910)483-4300  
Fax: (910)483-4052  
www.lkanda.com

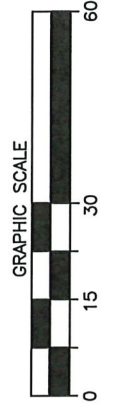

I, W. LARRY KING, CERTIFY THAT THIS MAP IS FOR THE PURPOSE OF PERMITTING ONLY. IT IS NOT A SURVEY AND NO RELIANCE MAY BE PLACED ON ITS ACCURACY. THE STRUCTURE SHOWN ON THIS PLOT PLAN IS PLACED ACCORDING TO THE INSTRUCTIONS GIVEN BY THE BUILDER. ALL DIMENSIONS AND SETBACKS SHOULD BE VERIFIED FOR COMPLIANCE WITH ZONING AND COVENANTS.

THE BOUNDARY AND LOT INFORMATION SHOWN ON THIS MAP IS TAKEN FROM THAT DOCUMENT DESCRIBED IN THE "REFERENCE" LINE SHOWN HEREON. THIS INFORMATION SHOULD BE CONFIRMED AS THE MOST CURRENT FOR THIS PROPERTY BEFORE ISSUANCE OF PERMITS OR COMMENCEMENT OF CONSTRUCTION. NO TITLE SEARCH WAS PERFORMED ON THIS PROPERTY BY THIS SURVEYOR.