

- All bracing, blocking, beams, purlins @ 2'0" o.c., ledger, etc. provided by others.
- Roof truss to roof truss connections provided by Riverside Roof Truss.
- Truss to building connections provided by others.

**Refer to Sealed drawings for connection detail of multiple ply trusses.**

**NOT ALL TRUSSES ARE SYMMETRICAL AND MAY NOT PERFORM CORRECTLY IF INSTALLED BACKWARDS. PLEASE REFER TO SEALS WHILE SETTING TRUSSES TO ENSURE TRUSSES ARE ORIENTED CORRECTLY**

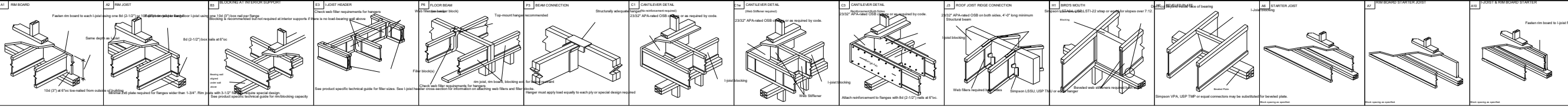

Products					
Net Qty	Plies	Product	Length	PlotID	
4	2	1 3/4" x 9 1/4" (2.0E 3100) LVL	8-00-00	WHBM22	
2	2	1 3/4" x 9 1/4" (2.0E 3100) LVL	6-00-00	WHBM20	
2	2	1 3/4" x 11 7/8" (2.0E 3100) LVL	10-00-00	WHBM21	
3	3	1 3/4" x 14" (2.0E 3100) LVL	22-00-00	GDH BM23	
2	2	1 3/4" x 14" (2.0E 3100) LVL	10-00-00	WHBM17	

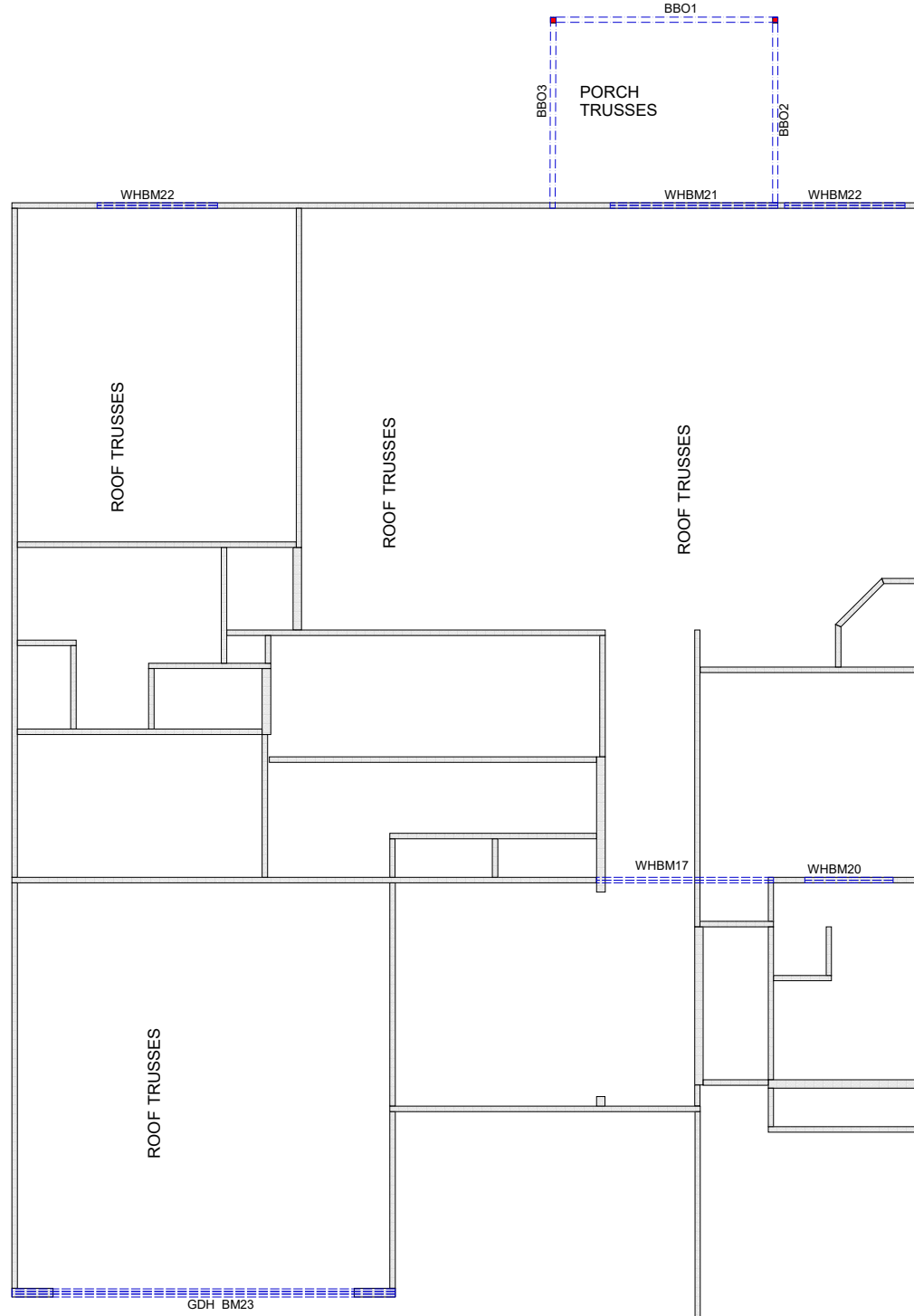

**SHOP DRAWING APPROVAL**  
 THIS LAYOUT IS THE SOLE SOURCE FOR FABRICATION OF TRUSSES AND VOIDS ALL PREVIOUS ARCHITECTURAL OR OTHER TRUSS LAYOUTS. REVIEW AND APPROVAL OF THIS LAYOUT MUST BE RECEIVED BEFORE ANY TRUSSES WILL BE BUILT. VERIFY ALL CONDITIONS TO INSURE AGAINST CHANGES THAT WILL RESULT IN EXTRA CHARGES TO YOU.

**THIS IS A TRUSS PLACEMENT DIAGRAM ONLY.** These trusses are designed as individual building components to be incorporated into the building design at the specification of the building designer. See individual design sheets for each truss identified on the placement drawing. The building designer is responsible for temporary and permanent bracing of the roof and floor system and for the overall structure. The design of the truss support structure including headers, beams, walls, columns, and sufficient blocking in floor cavity under point loads is the responsibility of the building designer. For general guidance regarding bracing, consult "Bracing of Wood Trusses" available from the Truss Plate Institute, 563 D'Onofrio Drive, Madison, WI 53179.

REVIEWED BY: \_\_\_\_\_ APPROVED BY: \_\_\_\_\_ DATE: \_\_\_\_\_

	<b>733 RIVER PARK DRIVE</b> <b>DANVILLE, VA 24540</b> <b>(434) 793-0217</b> <b>FAX: (434) 799-8767</b>		<b>Client:</b> MATTAMY HOMES <b>Job Name:</b> CLEARWATER - CRAFTSMAN <b>Model:</b> 1ST FLOOR HEADERS <b>Lot #:</b> 4 <b>Order #:</b> 24-2117-B <b>Subdivision:</b> RIVERFALL <b>Sales Rep:</b> C Walden <b>Designer:</b> R S <b>Date:</b> 4/8/2024												
	<b>Hanger Conversion Chart</b> <table border="1"> <tr> <td>USP</td> <td>Simpson</td> </tr> <tr> <td>JUS26</td> <td>LUS26</td> </tr> <tr> <td>THD26</td> <td>HUS26</td> </tr> <tr> <td>THD26-2</td> <td>HHUS26-2</td> </tr> <tr> <td>HJC26</td> <td>THJA26</td> </tr> <tr> <td>MSH422</td> <td>THA422</td> </tr> </table>		USP	Simpson	JUS26	LUS26	THD26	HUS26	THD26-2	HHUS26-2	HJC26	THJA26	MSH422	THA422	<b>Roof Surface Area: 0 ft² Sq. Ft.</b> <b>Floor Surface Area: 3137 ft² Sq. Ft.</b>
USP	Simpson														
JUS26	LUS26														
THD26	HUS26														
THD26-2	HHUS26-2														
HJC26	THJA26														
MSH422	THA422														

