

Truss Connector Total List		
Manuf	Product	Qty
Simpson	HTU28	13
Simpson	LUS26	11

▲ = LEFT END OF TRUSS

FOR PERMIT



Moncks Corner/Easley, SC (800) 475-3999  
Sparta, NC (336) 372-2226

REVISIONS:

Client: **MATTAMY HOMES-RALEIGH**  
 Job: **LOT 48 PROVIDENCE CREEK**  
 Plan Information: **SEQUOAI-CR**  
 NOT TO SCALE  
 Date: 03/27/24  
 Drawn By: MBB  
 Sales Rep: KYLE GIBSON  
 Phone: 24-2852-R01

**WARNING!** Long span trusses, 60' or greater in length, require extreme care and experience for proper and safe handling and installation. For general handling and installation guidance, see the "Guide to Good Practice for Handling, Installing, Restraining & Bracing of Metal Plate Connected Wood Trusses ("BCSI"), JOINTLY PRODUCED BY SBCA and TPI. For project specific guidance, consult with a registered design professional. ATLANTIC assumes no responsibility for the handling, installation or bracing of trusses.

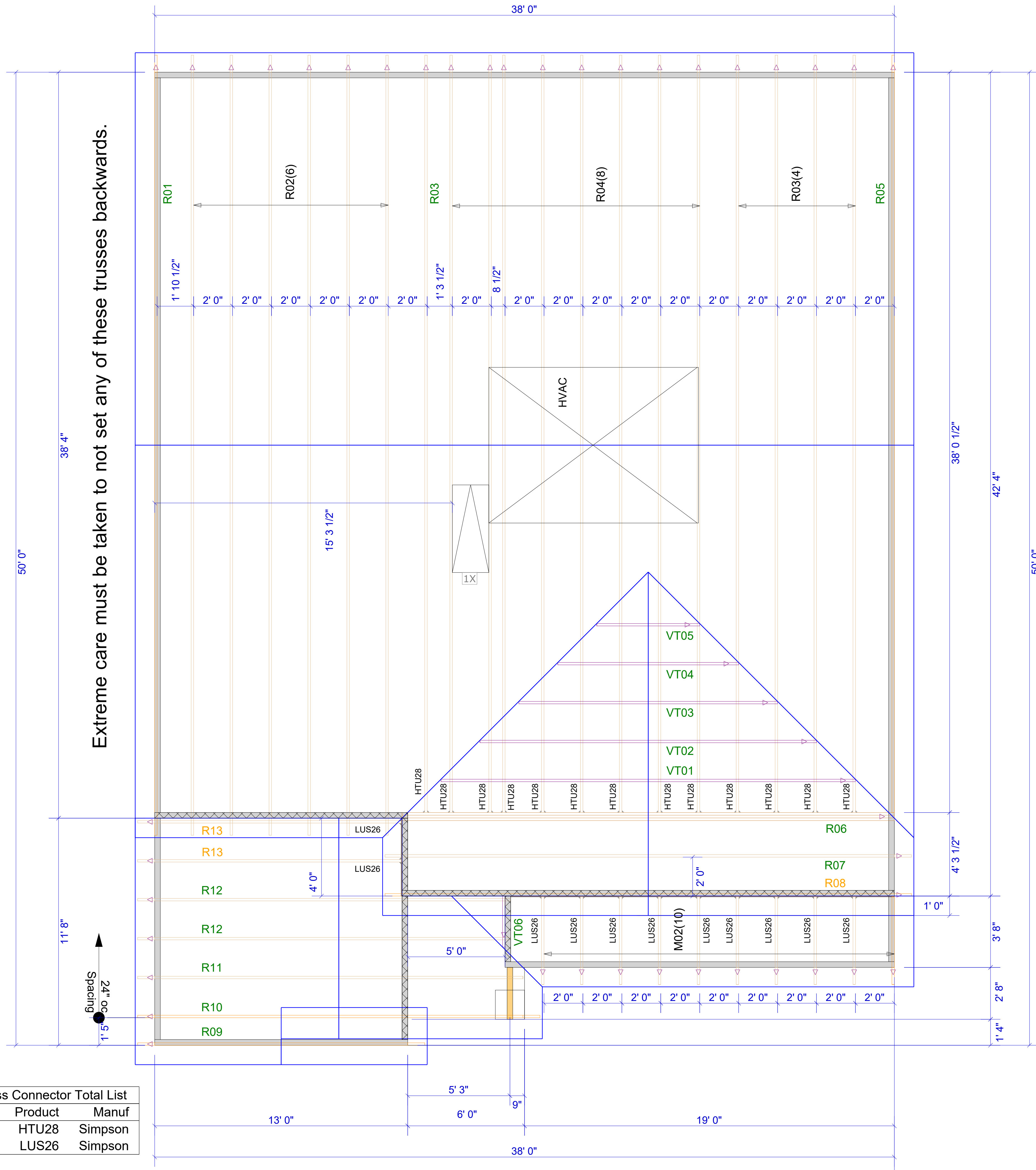

Truss Connector Total List		
Qty	Product	Manuf
13	HTU28	Simpson
11	LUS26	Simpson

▲ = LEFT END OF TRUSS

REVISIONS:



Moncks Corner/Easley, SC (800) 475-3999  
Sparta, NC (336) 372-2226

FOR PERMIT

Client: MATTAMY HOMES-RALEIGH

Job: LOT 48 PROVIDENCE CREEK

Plan Information:  
SEQUOAI-CR

ROOF

NOT TO SCALE

Drawn By: MBB

Date: 03/27/24

Job #: 24-2852-R01

Sales Rep: KYLE GIBSON  
Phone:

**WARNING!** Long span trusses, 60' or greater in length, require extreme care and experience for proper and safe handling and installation. For general handling and installation guidance, see the "Guide to Good Practice for Handling, Installing, Restraining & Bracing of Metal Plate Connected Wood Trusses ("BCSI"), JOINTLY PRODUCED BY SBCA and TPI. For project specific guidance, consult with a registered design professional. ATLANTIC assumes no responsibility for the handling, installation or bracing of trusses.