

60

25,343 SF
(0.58 AC)

3-Bedroom Septic Plan
Lot #60 – Duncan's Crossing
Harnett County
Smith Douglas Homes

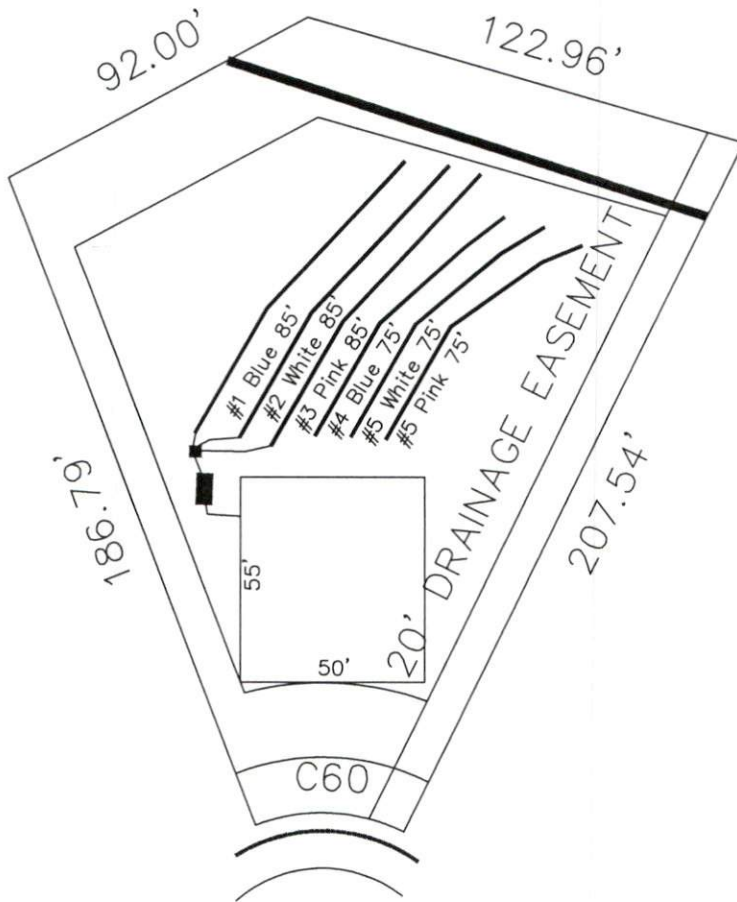

- *House footprint to be field staked by surveyor and system verified prior to any construction
- **Septic area must not be altered by construction activities.
- ***No cuts of 2' or greater within 15' of septic area
- **** Recommend protective barrier around septic field during construction.

*If plumbing is not sufficient a pump tank will be required to septic field.

System: Gravity to D-Box
 Lines: Lines 1-3 (255')
 0.4 LTAR
 18" Max Trench Bottom
 Accepted Status System
 Repair: Gravity to D-Box
 Lines: Lines 4-6 (225')
 0.4 LTAR
 24" Trench Bottom
 Accepted Status System

DOUBLE BARRELL STREET
50' R/W (PUBLIC & UTILITY ACCESS)

GRAPHIC SCALE
1" = 50'



Adams
 Soil Consulting
 919-414-6761
 Job #1146