

NOTES:

1. ALL DISTANCES ARE HORIZONTAL GROUND DISTANCES IN U.S. SURVEY FEET UNLESS OTHERWISE NOTED.
2. AREAS SHOWN HEREON WERE COMPUTED USING THE COORDINATE METHOD.
3. LINES NOT SURVEYED ARE SHOWN AS DASHED LINES FROM INFORMATION REFERENCED ON THE FACE OF THIS PLAT.
4. PROPERTY MAY BE SUBJECT TO ANY/ALL EASEMENTS AND RESTRICTIONS OF RECORD. THIS SURVEY IS A CORRECT REPRESENTATION OF THE LAND PLATTED AND OR DEEDED AND HAS BEEN PREPARED WITHOUT THE BENEFIT OF A LICENSED ATTORNEY-AT-LAW SHOULD BE CONSULTED REGARDING CORRECT OWNERSHIP, WIDTH AND LOCATION OF EASEMENTS, AND OTHER TITLE QUESTIONS REVEALED BY TITLE EXAMINATION.

EFFECTIVE DATE 10/03/2006
 SURVEY: N/F
 PANEL: 1600
 CID: 370558
 TOWN OF COATS
 FLOOD HAZARD AREA
 FLOOD MAP # 372016000K
 LOCATED IN THE SPECIAL
 THIS PROPERTY IS NOT

7
 N/F
 JULIO & JUANA
 MEDINA
 D.B. 3054, PG. 472

THIS MAP IS ONLY INTENDED FOR THE PARTIES AND PURPOSES SHOWN. THIS MAP IS NOT FOR RECORDATION NO TITLE REPORT PROVIDED. ANY VISUAL ENCROACHMENTS ARE SHOWN HEREON. THIS MAP MAY NOT BE A CERTIFIED SURVEY AND HAS NOT BEEN REVIEWED BY LOCAL GOVERNMENT AGENCY FOR COMPLIANCE WITH ANY APPLICABLE LAND DEVELOPMENT REGULATIONS AND HAS NOT BEEN REVIEWED FOR COMPLIANCE WITH RECORDING REQUIREMENTS FOR PLATS.

DATE: 3-9-22
 D.B. 3054, PG. 472

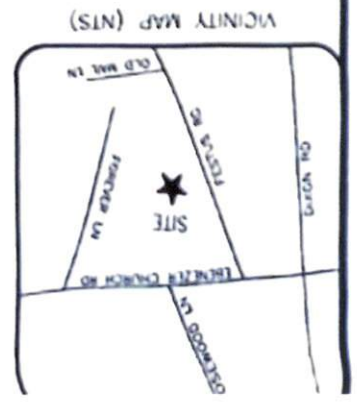

SETBACKS PER
 FB 2012, PG. 560
 35' FRONT
 25' REAR
 20' ZONING

5
 N/F
 LILIANA TLAZALO
 D.B. 3730, PG. 824

N/F
 MARIA & MARIO
 ROMERO
 D.B. 3435, PG. 211

1042 FESTUS RD

LEGEND

- DOT: DEPARTMENT OF TRANSPORTATION
- EDGE OF PAVEMENT
- POWER POLE
- R/W: RIGHT OF WAY
- O: EXISTING IRON PIPE (EIP)
- O: EXISTING IRON ROD (EIR)
- O: NEW IRON PIPE (NIP)
- AO: ABOVE GROUND
- BO: BELOW GROUND

GRANT ESMT TO
 CAROLINA POWER
 & LIGHT COMPANY
 DB 308, PG. 135

GRANT R/W
 AGREEMENT
 TO DOT
 DB 938, PG. 729

