

VICINITY MAP
Not To Scale

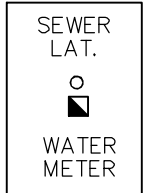

IMPERVIOUS SURFACE AREA	
DESCRIPTION	AREA
HOUSE w/ PORCH	1,352 S.F.
SC PORCH/HVAC	109 S.F.
DRIVEWAY & WALKS	403 S.F.
TOTAL (PROPOSED)=	1,864 S.F.
*TOTAL (ALLOWED)=	2,530 S.F.

*PB 2023 PG 356



SETBACKS: (PB 2023 PG 350)

- FRONT - 20'
- REAR - 20'
- SIDE - 4'
- CORNER YARD - 12'

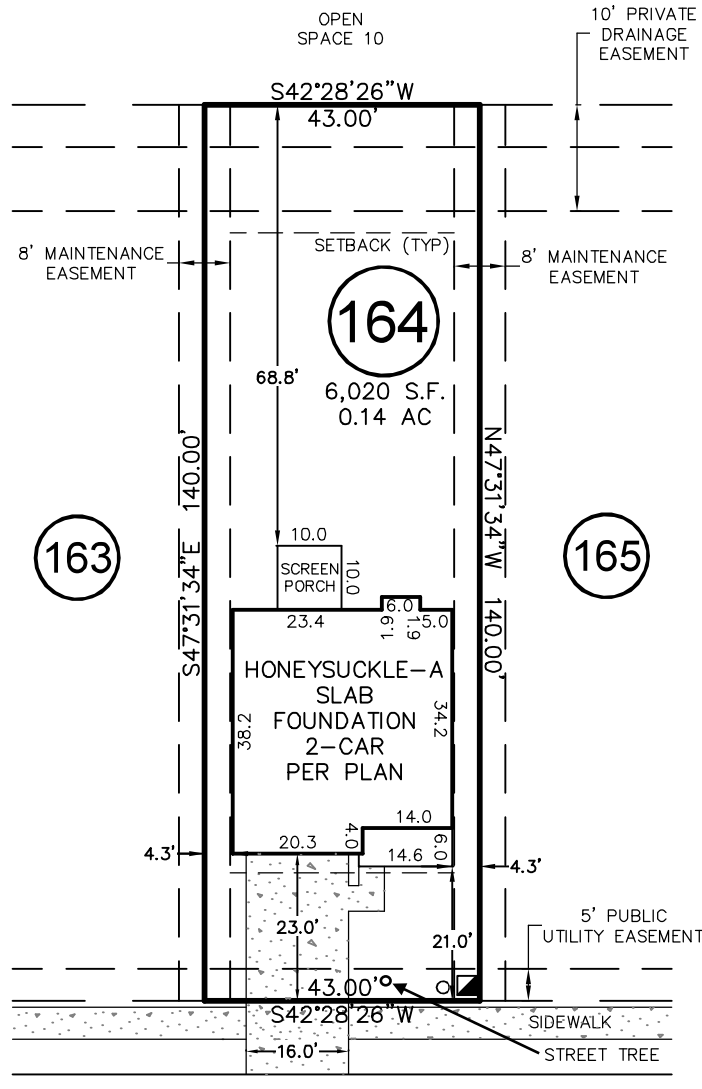

ASHBROOK COVE

50' PUBLIC R/W
& UTILITY

THIS DRAWING DOES NOT REFLECT AS-BUILT INFORMATION

PRELIMINARY PLAT
NOT FOR RECORDATION, CONVEYANCES, OR SALES.

THIS PROPERTY MAY BE SUBJECT TO ANY AND ALL APPLICABLE DEED RESTRICTIONS, EASEMENTS, RIGHT-OF-WAY, UTILITIES AND RESTRICTIVE COVENANTS WHICH MAY BE OF RECORD OR IMPLIED

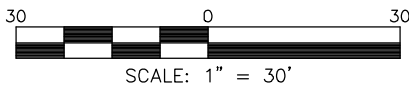

RESIDENTIAL LAND SERVICES, PLLC.

1917 Evans Road
Cary, North Carolina 27513
Phone (919) 378-9316
Firm License # P-0873

HOUSE LOCATION PLOT PLAN

FOR
#77 ASHBROOK COVE
LOT 164, SERENITY SUBDIVISION, PHASE 1D, 1E & 2G
(LOTS LESS THAN 9,000 SF) LOTS 144-167, & 248-272
Hector's Creek Township, Harnett County, North Carolina

PROPERTY OF: GARMAN HOMES
MAP BOOK 2023 PAGE 350-356 DEED REFERENCE _____

DRAWN: JLA | SURVEYED: N/A | CHECKED: DMR | DATE: FEBRUARY 27, 2024