

SOIL/SITE EVALUATION for ON-SITE WASTEWATER SYSTEM

(Complete all fields in full)

OWNER: GAIT DATE EVALUATED: _____
 ADDRESS: 497 Solomon Dr
 PROPOSED FACILITY: IFD PROPOSED DESIGN FLOW (.0400): 480 GPD PROPERTY SIZE: _____
 LOCATION OF SITE: same PROPERTY RECORDED: _____
 WATER SUPPLY: Public Single Family Well Shared Well Spring Other _____ WATER SUPPLY SETBACK: _____
 EVALUATION METHOD: Auger Boring Pit Cut TYPE OF WASTEWATER: Domestic High Strength IPWW

P R O F I L E #	.0502 LANDSCAPE POSITION/ SLOPE %	HORIZON DEPTH (IN.)	SOIL MORPHOLOGY		OTHER PROFILE FACTORS				.0509 PROFILE CLASS & LTAR*	.0503 SLOPE CORRE CTION
			.0503 STRUCTURE/ TEXTURE	.0503 CONSISTENCE/ MINERALOGY	.0504 SOIL WETNESS/ COLOR	.0505 SOIL DEPTH	.0506 SAPRO CLASS	.0507 RESTR HORIZ		
1	L 2-5%	0-8	LS	Fr/usp/oxp	10YR2.6/1 ≥ 36"	> 48"	—	—	S .4	
		8-48	SCI	Fi/ssp/oxp						
2	L 2-5%	0-8	LS	Fr/usp/oxp	10YR2.6/1 ≥ 36"	> 48"	—	—	S .4	
		8-48	SCI	Fi/ssp/oxp						
3	L 2-5%	0-9	LS	Fr/usp/oxp	10YR2.6/1 ≥ 34"	> 48"	—	—	S .4	
		9-48	SCI	Fi/ssp/oxp						
4										

DESCRIPTION	INITIAL SYSTEM	REPAIR SYSTEM	SITE CLASSIFICATION (.0509): <u>S</u> EVALUATED BY: _____ OTHER(S) PRESENT: <u>MU REHS</u>
Available Space (.0508)	✓	✓	
System Type(s)	✓ 256	✓ 502	
Site LTAR	.4	.4	
Maximum Trench Depth	18-22	18-22	

Comments: _____

LEGEND

LANDSCAPE POSITION	SOIL GROUP	SOIL TEXTURE	CONVENTIONAL LTAR (gpd/ft ²)	SAPROLITE LTAR (gpd/ft ²)	LPP LTAR (gpd/ft ²)	MINERALOGY/ CONSISTENCE		STRUCTURE	
						MOIST	WET		
CC (Concave slope)	I	S (Sand)	0.8 - 1.2	0.6 - 0.8	0.4 - 0.6	Mo	NS	SG (Single grain)	
CV (Convex Slope)		LS (Loamy sand)		0.5 - 0.7		Lo (Loose)	(Non-sticky)	M (Massive)	
D (Drainage way)	II	SL (Sandy loam)	0.6 - 0.8	0.4 - 0.6	0.3 - 0.4	VFR (Very friable)	SS (Slightly sticky)	GR (Granular)	
FP (Flood plain)		L (Loam)		0.2 - 0.4		FR (Friable)	S (Sticky)	SBK (Subangular blocky)	
FS (Foot slope)	III	SiL (Silt loam)	0.3 - 0.6	0.1 - 0.3	0.15 - 0.3	FI (Firm)	VS (Very sticky)	ABK (Angular blocky)	
H (Head slope)		SCL (Sandy clay loam)		0.05 - 0.15**		VFI (Very firm)	NP (Non-plastic)	PR (Prismatic)	
L (Linear Slope)		CL (Clay loam)		None		0.15 - 0.3	EVI (Extremely firm)	SP (Slightly plastic)	PL (Platy)
N (Nose slope)		SiCL (Silty clay loam)						P (Plastic)	
R (Ridge/summit)		Si (Silt)						VP (Very plastic)	
S (Shoulder slope)	IV	SC (Sandy clay)	0.1 - 0.4	0.05 - 0.2	SEXP (Slightly expansive)				
T (Terrace)		SiC (Silty clay)			EXP (Expansive)				
TS (Toe Slope)		C (Clay)							
		O (Organic)	None						

* Adjust LTAR due to depth, consistence, structure, soil wetness, landscape, position, wastewater flow and quality.

**Sandy clay loam saprolite can only be used with advanced pretreatment in accordance with 15A NCAC 18E .1200.

HORIZON DEPTH

In inches below natural soil surface

DEPTH OF FILL

In inches from land surface

RESTRICTIVE HORIZON

Thickness and depth from land surface

SAPROLITE

S(suitable) or U(unsuitable); Evaluation of saprolite shall be by pits.

SOIL WETNESS

Inches from land surface to free water or inches from land surface to soil colors with chroma 2 or less - record Munsell color chip designation

CLASSIFICATION

S (Suitable) or U (Unsuitable)

Show profile locations and other site features (dimensions, reference or benchmark, and North).

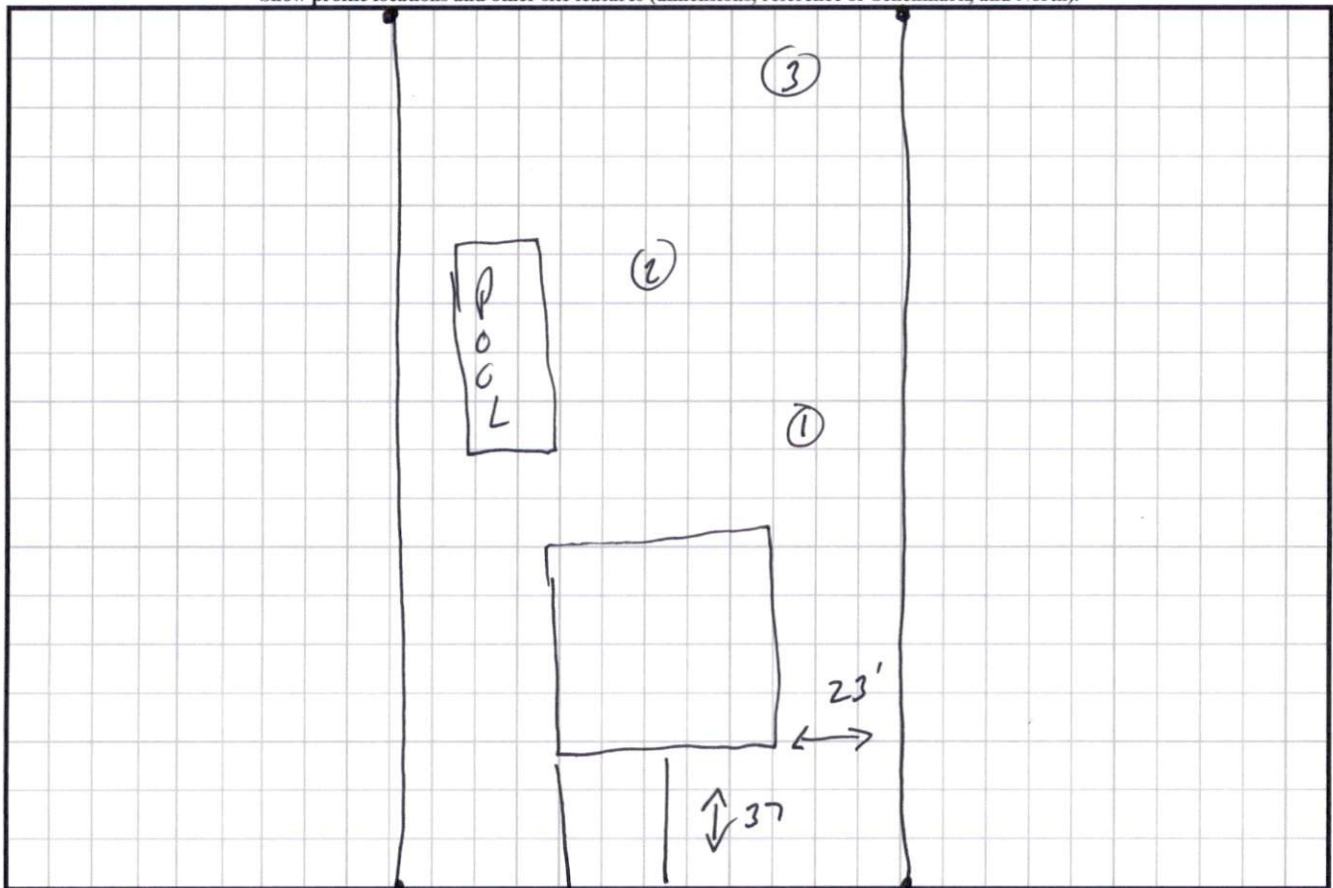

Solomon Dr