

- SYMBOLS & ABBREVIATIONS:**
- EIP/EIS... Existing Iron Pipe or Stake
 - ERB..... Existing ReBar Stake
 - ERRS... Existing Rail Road Spike
 - EPK..... Existing Parker-Kaylon Nail
 - EMN..... Existing Magnetic Nail
 - ECS..... Existing Cotton Picker Spindle
 - ECM..... Existing Concrete Monument
 - AG/BG..... Above/Below Ground Surface
 - △ CP..... Calculated Point (not set)
 - ⊙ CNTRL..... Control Point - Grid Coordinates
 - ISS..... Iron Stake Set (#4 rebar)
 - ⊙ MNS..... Magnetic Nail Set
 - ⊙ CSS..... Cotton Spindle Set
 - ◆ FH..... Fire Hydrant
 - ⊙ PP..... Power Pole
 - OHE..... Overhead Electric Lines
 - Land Hook (Property combined)
 - C/L..... Centerline of Road or Easement
 - R/W..... Right-of-Way
 - D.B..... Deed Book
 - P.B/P.C..... Plat Book / Plat Cabinet
 - M.B..... Map Book
 - NC_PIN..... Parcel Identifier Number
 - Ac..... Acres (Area of property)
 - SF..... Square Feet
 - [123]..... House Address

- SURVEY NOTES:**
- Iron Stakes (1/2" Re-bar) set at all new property corners unless labeled otherwise.
 - Magnetic Nails set at all points in paved road surfaces, unless otherwise indicated.
 - Areas determined by coordinate method.
 - All distances & dimensions are horizontal ground distances unless otherwise indicated.
 - No NC Geodetic Survey monuments or other such control monuments were found within 2,000 feet of the subject property unless otherwise shown hereon.
 - This survey is based upon the references shown as taken from County GIS records. No title search was provided for this survey. A complete title search by a licensed attorney may reveal other easements, restrictions, and title issues not made available to the surveyor.
 - No underground utilities were marked by providers prior to this survey. Call NC 811 prior to any excavation to locate any underground utilities.
 - Wetlands, soil conditions, or other environmental features were not delineated for this survey.

5" Existing Rebar
 NC Grid Coordinates:
 N: 579,169.16 sFT
 E: 2,097,557.15 sFT
 EL: 156.65'
 CSF: 0.99987158
 LAT: 35°20'27.3535"
 LON: 78°40'22.3091"

**Erwin ETJ - R-15
 Minimum Building
 Setback Requirements**

FRONT: 35' from R/W
 REAR: 35'
 SIDE: 10'
 MAXIMUM HEIGHT: 35'

- LINE LEGEND:**
- Subject Boundary Surveyed
 - Subject Boundary Not Surveyed
 - Adjacent Property Lines
 - Abandoned Property Lines
 - Right of Way Lines
 - Center of Right-of-Way
 - Easement Lines
 - Survey Tie Lines
 - Minimum Building Setback
 - Overhead Electric Lines
 - W --- Public Water Line
 - AE --- Flood Zone "AE" Limits
 - X --- Flood Zone "X" Limits

- The NC GRID coordinates were determined from an actual Class A GPS Survey using NC Geodetic Survey's Real Time Kinematic (VRS) Network.
 - Date of Survey: 1/2/24; 1/27/24; 2/15/24
 - Horizontal positional accuracy: 0.05 ft.
 - Horizontal Datum: NAD 83 (NSRS 2011)
 - Vertical positional accuracy: 0.15 ft.
 - Vertical positions are referenced to NAVD88
 - Combined Scale Factor (CSF): 0.99987158
 - Geoid Model: GEOID12 (conus)
 - Units: US Survey Feet (sFT)

References:
 Tract 1A
 -Map # 2024-103
 -Deed Book 4197, Pg. 1714
 -Map #2001-972 (Lot #1)

I hereby certify that the foundation location shown hereon is correct in relation to property lines of record.
 NOTE: The purpose of this survey is to locate the newly constructed foundation.
 Other features, fixtures, encumbrances and indications of use may be revealed by a complete site survey.

Note:
 Foundation Location based upon nails set in concrete footing for brick masons on October 30th, 2024. As-built dimensions of foundation confirmed on this date.

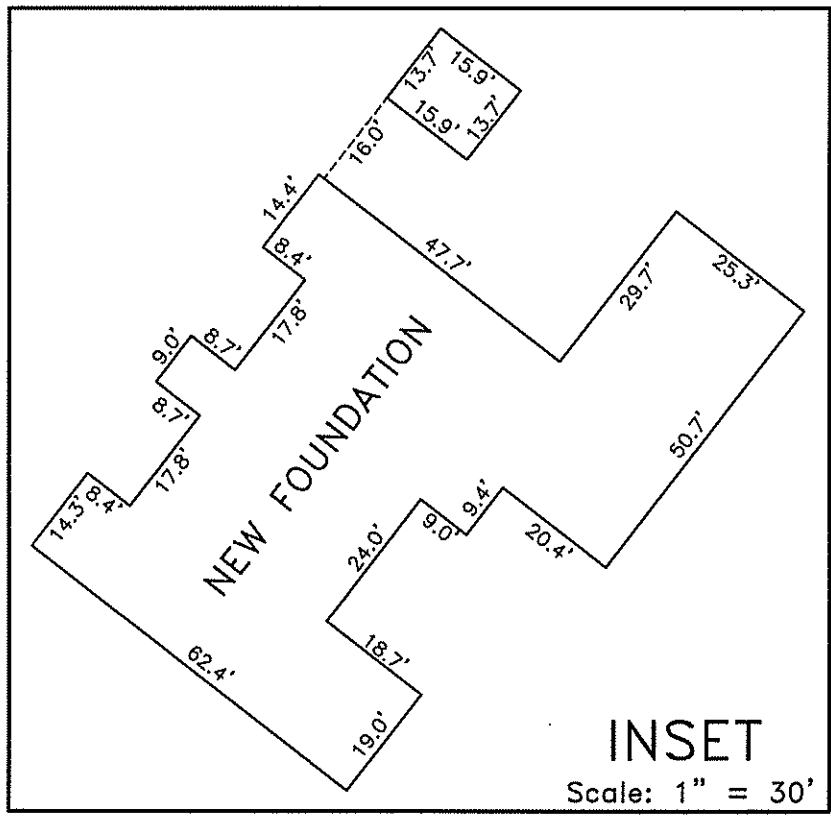

Revisions:

3/11/24: Add location of Proposed Septic System
11/21/24: Foundation Location

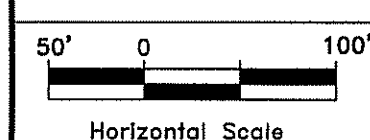

"FOUNDATION SURVEY - TRACT 1A"
 Survey For:
**Brittany Lynn Humbert
 and Jonathan Paul Humbert**
 Mailing Address: 1000 Warren Rd., Erwin, NC 28339
 Property Address: 5131 NC 55 E, Erwin, NC 28339
 DUKE TOWNSHIP - HARNETT COUNTY - NORTH CAROLINA
 ZONED: Erwin-R-15 - PID: 060598 0007 - PIN: 0597-89-3009.000

STREAMLINE LAND SURVEYING, Inc.
 NC FIRM C-1898
 870 NC 55 W, Coats, N.C. 27521
 Phone: 910-897-7715
 SURVEY DATE: November 21, 2024
 SCALE: 1" = 100' SURVEYED BY: REG DRAWN BY: MGG
 FILE: 0597\231106HU.dwg (Tract-1A-PlotPlan)

