

# Harnett County Department of Public Health

PERMIT # SFD 2403-0040

## Operation Permit

New Installation    Septic Tank    Nitrification Line    Repair    Expansion

PROPERTY LOCATION: 443 Thomas Gage

Name: (owner) KB Home Raleigh   SUBDIVISION Birchwood Grove   LOT # 27

System Installer: David Brantley

Basement with plumbing:  Garage  Number of Bedrooms 3

Type of Water Supply:  Community    Public    Well   Distance from well \_\_\_\_\_ feet

System Type: 25% Reduction Type III (g) EZ Flow   Types V and VI Systems expire in 5 years.

(In accordance with Table V a)   Owner must contact Health Department 6 months prior to expiration for permit renewal.

This system has been installed in compliance with applicable North Carolina General Statutes, Rules for Sewage Treatment and Disposal, and all conditions of the Improvement Permit and Construction Authorization.

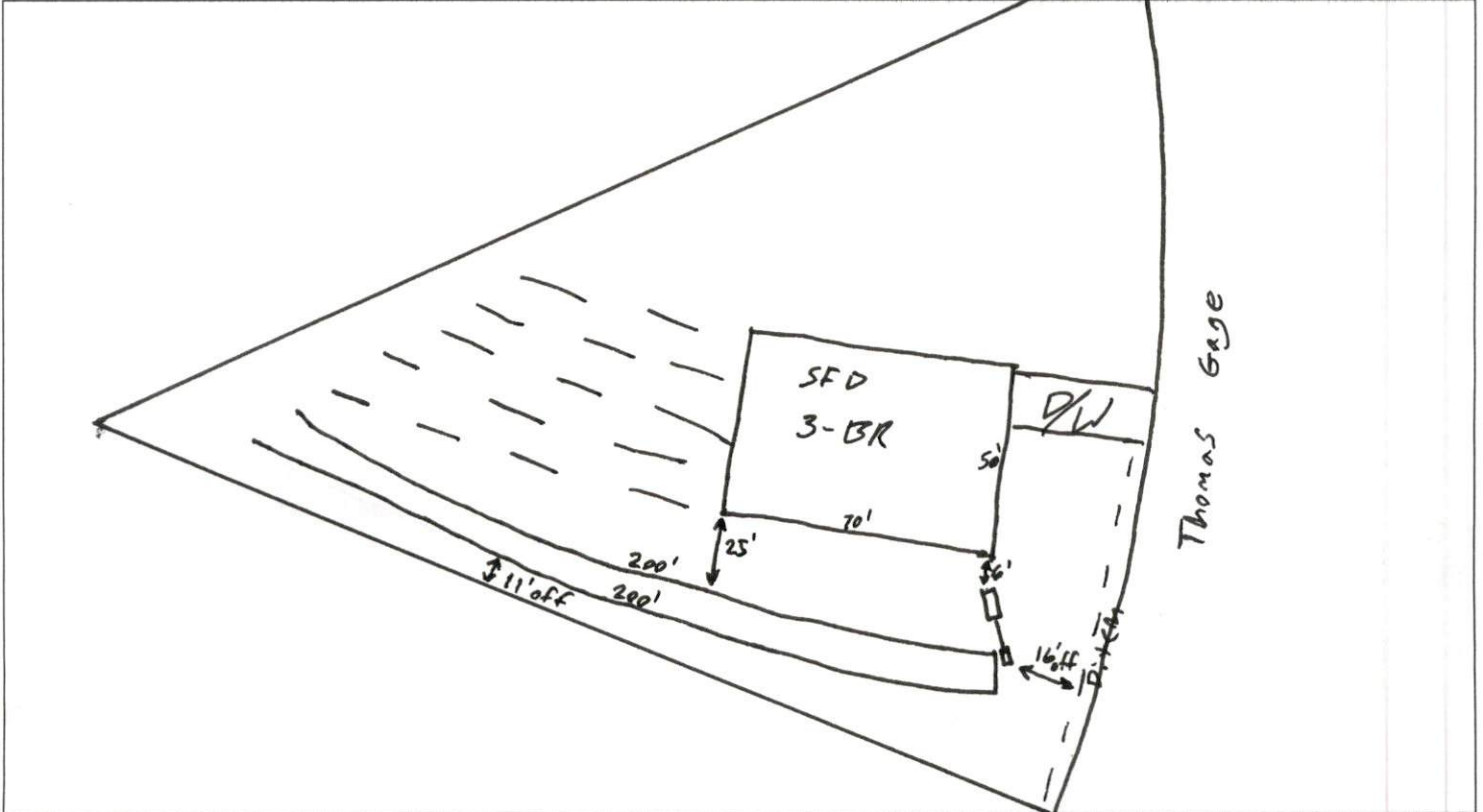

**PERMIT CONDITIONS:**

- I. Performance: System shall perform in accordance with Rule .1961.
- II. Monitoring: As required by Rule .1961.
- III. Maintenance: As required by Rule .1961. Other: \_\_\_\_\_  
Subsurface system operator required? Yes  No   
If yes, see attached sheet for additional operation conditions, maintenance and reporting.
- IV. Operation: \_\_\_\_\_
- V. Other: \_\_\_\_\_

\_\_\_\_\_ D-Box    \_\_\_\_\_ Pump    \_\_\_\_\_ Alarm    \_\_\_\_\_ H2O Line    \_\_\_\_\_ PWR Line

Following are the specifications for the sewage disposal system on the above captioned property.

Type of system:  Conventional    Other Type III (g) EZ Flow   Septic Tank: 1,000 gallons   Pump Tank: \_\_\_\_\_ gallons  
Subsurface Drainage Field   No. of ditches 2   exact length of each ditch 200'   width of ditches 3'   depth of ditches 24" inches  
French Drain Required: \_\_\_\_\_ Linear feet

Authorized State Agent REHS   Date 5-20-24