



ECS Southeast, LLC

6151 Raeford Road, Suite A
Fayetteville, NC 28304
9104013288
9103230539

LETTER OF TRANSMITTAL

March 27, 2024
Precision Custom Homes

Raeford, NC 28376
ATTN: Shaun Gardner

RE: **Liberty Meadows Lot 74**
ECS Job # **33:6442-Z**

Permits:
Location: **515 Solomon**
Cameron, NC 28326

Field Reports For your use As requested

CC: Precision Custom Homes - Allen Peterson Precision Custom Homes - Lauren Ceruti

ENCL: Field Report # 1 3/26/2024



MAR 27 2024

Jack Cowser, P.E.
Office Manager

Aaron Kyle Adair
CMT Senior Project Coordinator

Disclaimer

1. This report (and any attachments) shall not be reproduced except in full without prior written approval of ECS.
2. The information in this report relates only to the activities performed on the report date.
3. Where appropriate, this report includes statements as to compliance with applicable project drawings, and specifications for the activities, performed on this report date.
4. Incomplete or non-conforming work will be reported for future resolution.
5. The results of samples and/or specimens obtained or prepared for subsequent laboratory testing will be presented in separate reports/documents.



ECS Southeast, LLC
6151 Raeford Road, Suite A
Fayetteville, NC 28304
(910) 401-3288 [Phone]
(910) 323-0539 [Fax]

FIELD REPORT

Project **Liberty Meadows Lot 74**
Location **Cameron, NC**
Client **Precision Custom Homes**
Contractor **Precision Custom Homes**

Project No. **33:6442-Z**
Report No. **1**
Day & Date **Tuesday 3/26/2024**
Weather **60 °/ Cloudy**
On-Site Time **2.00**
Lab Time **0.00**
Travel Time* **0.00**
Total **2.00**
Re Obs Time **0.00**

Remarks

Trip Charges*	Tolls/Parking*	Mileage*	Time of Arrival	Departure
Chargeable Items			2:30P	4:30P

* Travel time and mileage will be billed in accordance with the contract.

Summary of Services Performed (field test data, locations, elevations & depths are estimates) & Individuals Contacted.

ECS arrived on site, as requested, to check the bearing capacity of soils via hand auger/DCP method (ASTM STP-399) for monolithic slab foundation. Please see the attached sketch and data sheet for details.

A total of 4 hand auger/DCP evaluations were performed to a depth of approximately 3 feet below the current footing sub grade elevation. Test results indicated that the materials in place (at the locations and elevations tested) did appear to be suitable to support the design bearing capacity of 2,000 psf.

ECS will return, as requested, for additional services.

George Oxendine
 3/26/2024
 Lib. Meadows 74
 Proj#: 6442-Z

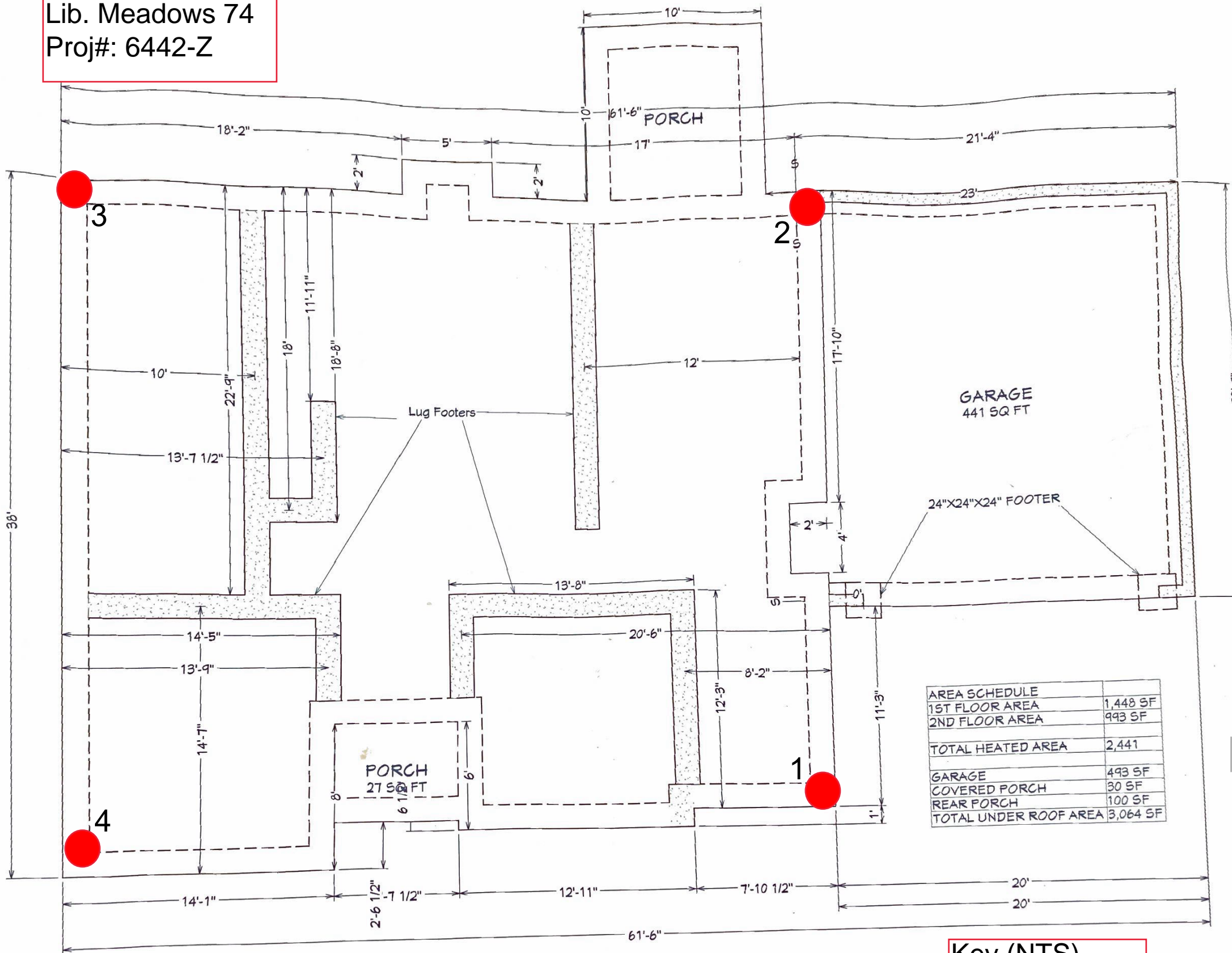

AREA SCHEDULE	
1ST FLOOR AREA	1,448 SF
2ND FLOOR AREA	993 SF
TOTAL HEATED AREA	2,441
GARAGE	493 SF
COVERED PORCH	30 SF
REAR PORCH	100 SF
TOTAL UNDER ROOF AREA	3,064 SF

Key (NTS)
 DCP Locations

FOUNDATION PLAN
 Transmittal Page 3/4
 Scale: 1/4" = 1'0"

Created with ScanWritr. To remove this watermark please use the upgrade options.



Report of Spread Footing - Foundation Observations

Project: Liberty Meadows Lot 74
 Location: 515 Solomon
Cameron - Moore - NC - 28326
 Contractor: Precision Custom Homes

Project No.: 33:6442-Z
 Day/Date: 3/26/2024

Footing Number	Location	Size (W x H x L)		Footing Bottom Elevation		Description of Steel Placed	Description of Subgrade Material	Required Blow Counts	Design Bearing Pressure
		Design	Actual	Design **	Depth of Undercut (in)			# of Blows / Increment	
1	S.E. Corner	x x	x x	N/A	N/A		(0)/-1 Orange Clay Sand(-2)/-3 Orange Tan Sand	6 (0)6,10,10(-1)11,11,13(-2)12,11,12(-3)14,14,12	2000
2	N.E. Corner	x x	x x	N/A	N/A		(0)/-3 Orange Clay Sand	6 (0)8,8,10(-1)7,10,9(-2)14,11,14(-3)8,8,10	2000
3	N.W. Corner	x x	x x	N/A	N/A		(0)/-2 Orange Clay Sand(-3) Brown Clay Sand	6 (0)6,10,12(-1)12,12,15(-2)17,18,21(-3)10,10,12	2000
4	S.W. Corner	x x	x x	N/A	N/A		(0)/-1 Orange Clay Sand(-2)/-3 Tan Sand	6 (0)8,13,15(-1)10,20,21(-2)7,7,8(-3)8,8,7	2000

** SGE: Subgrade Elevation to be determined by surveyor.

By: George Pate Oxendine Jr.

ECS Southeast, LLC

WO: 76954