

I, MELVIN A. GRAHAM, PLS. CERTIFY THAT THIS PLAT WAS DRAWN UNDER MY SUPERVISION FROM AN ACTUAL SURVEY MADE UNDER MY SUPERVISION (1:10,000 PROCEDURES) PLAT PREPARED IN ACCORDANCE WITH STANDARDS OF PRACTICE FOR LAND SURVEYING IN NORTH CAROLINA.

Melvin A. Graham 02/28/2024
 MELVIN A. GRAHAM, PLS. L-3471 DATE



SITE PLAN

NOT TO SCALE
VICINITY MAP

NOTE: THIS MAP IS NOT INTENDED FOR RECORDATION IN ACCORDANCE WITH G.S. 47-30 AS AMENDED.

NOTE: THIS SURVEY IS OF AN EXISTING PARCEL OR PARCELS OF LAND AND DOES NOT CREATE A NEW STREET OR CHANGE AN EXISTING STREET.

Melvin A. Graham 02/28/2024
 SURVEYOR DATE

NOTE: THIS PROPERTY IS SUBJECT TO ANY AND ALL EASEMENTS, RIGHT OF WAYS, AND AGREEMENTS OF RECORD PRIOR TO THIS PLAT.

MINIMUM BUILDING SETBACKS
 FRONT - 35'
 SIDELINES - 10'
 SIDE STREET - 20'
 REAR - 25'

THOMAS SCOTT HOLLOWELL
 TERESA PRINCE HOLLOWELL
 D.B. 4193, PG. 2707
 PLAT # 2020-55
 116.83 AC.

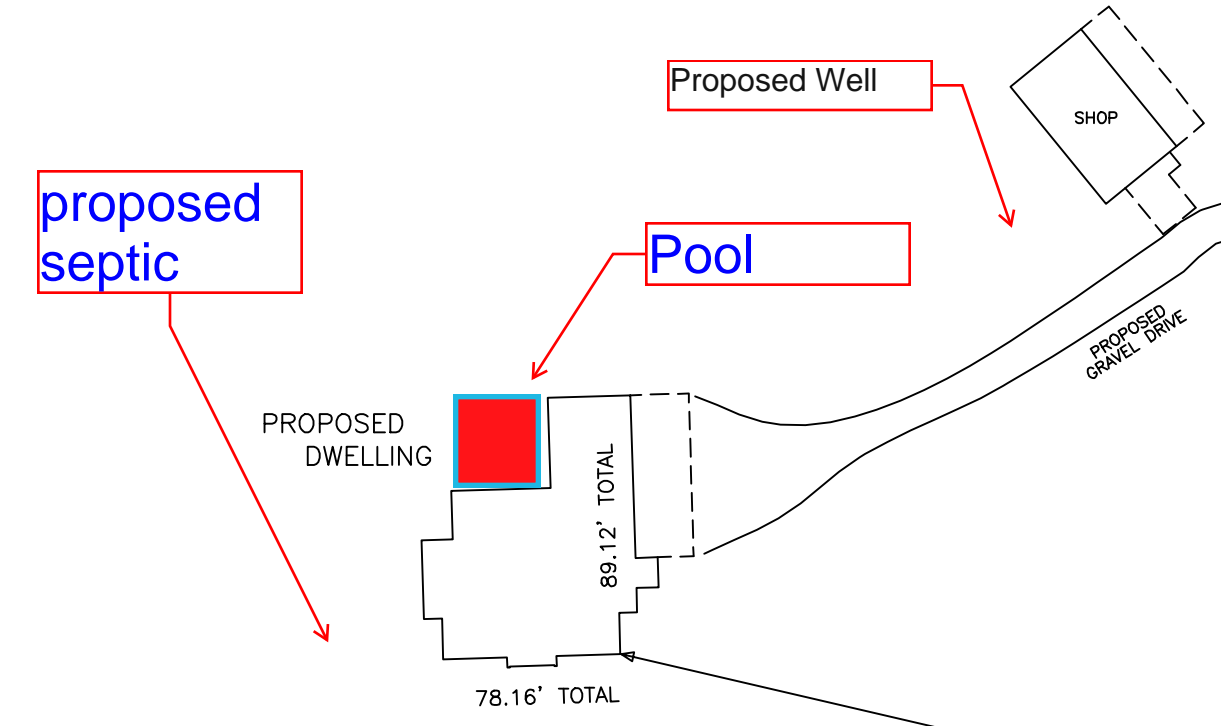

BARN

SHELTER

THOMAS SCOTT HOLLOWELL
 TERESA PRINCE HOLLOWELL
 D.B. 3870, PG. 182
 LOT 1
 PLAT # 2008-201

McDOUGALD ROAD S.R. 1229
 60' R/W (PAVED ROAD)

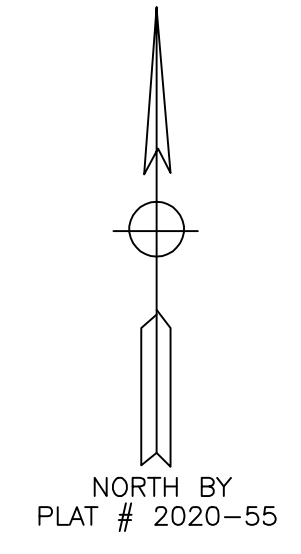

NOTES:
 THIS SURVEY IS A PARTIAL SURVEY OF THE THOMAS S. HOLLOWELL and TERESA P. HOLLOWELL PROPERTY AS RECORDED IN D.B. 4193, PG. 2707 HARNETT COUNTY REGISTRY.

ALL AREAS BY COORDINATE METHOD
 PROPERTY ZONED RA-20R
 PROPERTY NOT IN A WATERSHED
 PID # 130519 0132
 PIN # 0509-41-4760.000

THOMAS SCOTT HOLLOWELL
 TERESA PRINCE HOLLOWELL
 D.B. 4193, PG. 2707
 PLAT # 2020-55
 116.83 AC.

THIS PROPERTY IS NOT IN A SPECIAL FLOOD HAZARD AREA ACCORDING TO MAP NUMBER: 3720050800J OF THE FEDERAL EMERGENCY MANAGEMENT AGENCY. EFF. DATE: 10/03/2006

- LEGEND:
- EIP-EXISTING IRON PIPE OR IRON ROD
 - NIP-NEW IRON PIPE OR IRON ROD
 - NRRS-NEW RAILROAD SPIKE
 - ERRS-EXISTING RAILROAD SPIKE
 - NPK-NEW P.K. NAIL
 - EPK-EXISTING P.K. NAIL
 - ECM-EXISTING CONCRETE MONUMENT
 - C/L-CENTER LINE
 - PP-POWER POLE
 - LP-LIGHT POLE
 - R/W-RIGHT OF WAY
 - CP-CALCULATED POINT
 - E- ELECTRICITY
 - * - GROUND ELEVATION
 - X-X-X- FENCE
 - - - LINES NOT SURVEYED

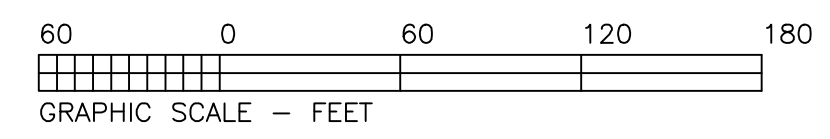

TOWNSHIP UPPER LITTLE RIVER	COUNTY HARNETT	STATE NC
SURVEY FOR (OWNER) THOMAS SCOTT HOLLOWELL TERESA PRINCE HOLLOWELL 8374 McDOUGALD ROAD BROADWAY, NC 27505		DATE: 02/20/2024
		SCALE: 1"=60'
		PROJECT: 3224
MELVIN A. GRAHAM, PLS. 3679 NICHOLSON ROAD CAMERON, NC 28326 PHONE(919)499-6174		REVISION:

