

# Harnett County Department of Public Health

PERMIT # SFD 2402-0114

## Operation Permit

New Installation    Septic Tank    Nitrification Line    Repair    Expansion

PROPERTY LOCATION: 303 Thistle Ct (SR 1229)

Name: (owner) Weaver Homes      SUBDIVISION WEST PINEVIEW      LOT # 13

System Installer: Yellow Dog

Basement with plumbing:     Garage     Number of Bedrooms 3 (6 people)

Type of Water Supply:  Community    Public    Well    Distance from well \_\_\_\_\_ feet

System Type: TYPE III g      Types V and VI Systems expire in 5 years.

(In accordance with Table V a)      Owner must contact Health Department 6 months prior to expiration for permit renewal.

This system has been installed in compliance with applicable North Carolina General Statutes, Rules for Sewage Treatment and Disposal, and all conditions of the Improvement Permit and Construction Authorization.

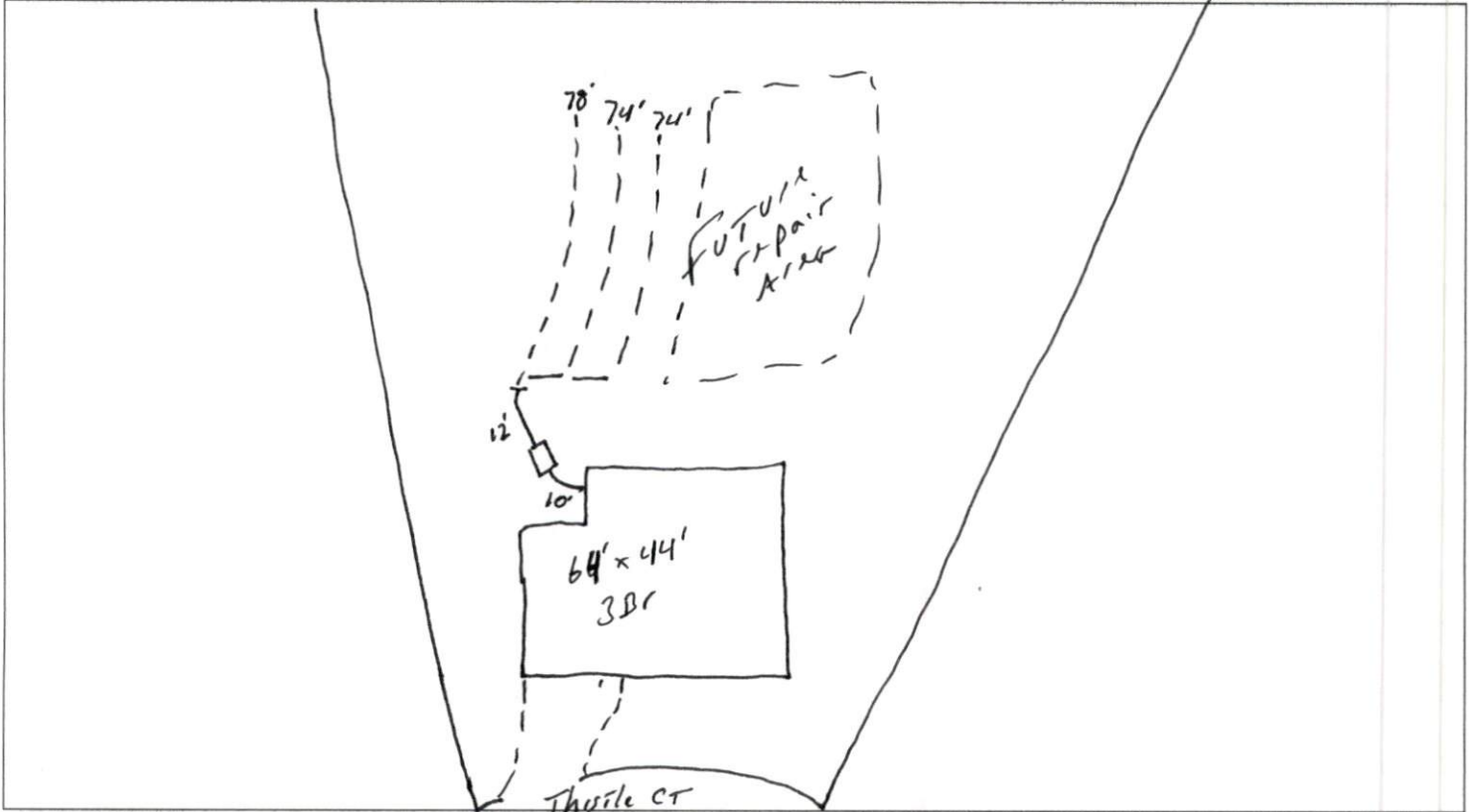

**PERMIT CONDITIONS:**

- I. Performance: System shall perform in accordance with Rule .1961.
- II. Monitoring: As required by Rule .1961.
- III. Maintenance: As required by Rule .1961. Other: \_\_\_\_\_  
Subsurface system operator required? Yes  No   
If yes, see attached sheet for additional operation conditions, maintenance and reporting.
- IV. Operation: \_\_\_\_\_
- V. Other: \_\_\_\_\_

D-Box    Pump    Alarm    H2O Line    PWR Line

Following are the specifications for the sewage disposal system on the above captioned property.

Type of system:  Conventional    Other 25% REDUCTION I/Q4    Septic Tank: 1000 gallons    Pump Tank: \_\_\_\_\_ gallons  
Subsurface    No. of    exact length    width of    depth of  
Drainage Field    ditches 1    of each ditch 226 feet    ditches 3 feet    ditches 25 inches  
French Drain Required: \_\_\_\_\_ Linear feet

Authorized State Agent M. A. REHS      Date 7-23-24