

- All bracing, blocking, beams, purlins @ 2'0" o.c., ledger, etc. provided by others.
- Roof truss to roof truss connections provided by Riverside Roof Truss.
- Truss to building connections provided by others.

Refer to Sealed drawings for connection detail of multiple ply trusses.

NOT ALL TRUSSES ARE SYMMETRICAL AND MAY NOT PERFORM CORRECTLY IF INSTALLED BACKWARDS. PLEASE REFER TO SEALS WHILE SETTING TRUSSES TO ENSURE TRUSSES ARE ORIENTED CORRECTLY

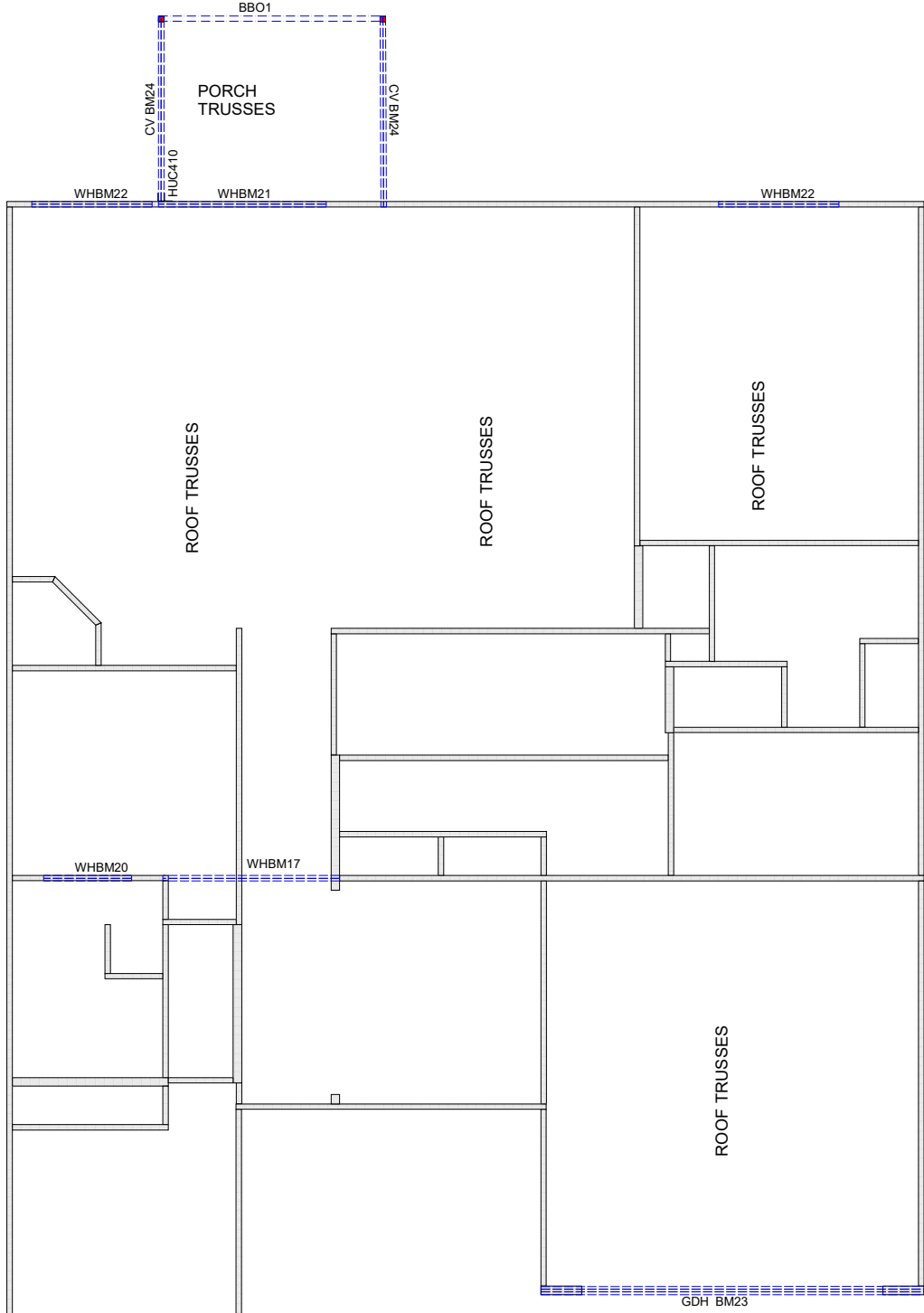
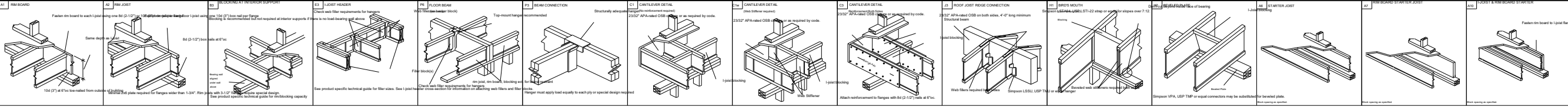

Products				
PlotID	Length	Product	Plies	Net Qty
CV BM24	12-00-00	1 3/4" x 9 1/4" (2.0E 3100) LVL	2	2
CV BM24	10-00-00	1 3/4" x 9 1/4" (2.0E 3100) LVL	2	2
WHBM22	8-00-00	1 3/4" x 9 1/4" (2.0E 3100) LVL	2	4
WHBM20	6-00-00	1 3/4" x 9 1/4" (2.0E 3100) LVL	2	2
GDH BM23	22-00-00	1 3/4" x 11 7/8" (2.0E 3100) LVL	3	3
WHBM21	10-00-00	1 3/4" x 11 7/8" (2.0E 3100) LVL	2	2
WHBM17	10-00-00	1 3/4" x 14" (2.0E 3100) LVL	2	2

Connector Summary		
Qty	Manuf	Product
1	HUC410	

THIS IS A TRUSS PLACEMENT DIAGRAM ONLY. These trusses are designed as individual building components to be incorporated into the building design at the specification of the building designer. See individual design sheets for each truss identified on the placement drawing. The building designer is responsible for temporary and permanent bracing of the roof and floor system and for the overall structure. The design of the truss support structure including headers, beams, walls, columns, and sufficient blocking in floor cavity under point loads is the responsibility of the building designer. For general guidance regarding bracing, consult "Bracing of Wood Trusses" available from the Truss Plate Institute, 583 D'Onofrio Drive, Madison, WI 53179.

SHOP DRAWING APPROVAL
THIS LAYOUT IS THE SOLE SOURCE FOR FABRICATION OF TRUSSES AND VOIDS ALL PREVIOUS ARCHITECTURAL OR OTHER TRUSS LAYOUTS. REVIEW AND APPROVAL OF THIS LAYOUT MUST BE RECEIVED BEFORE ANY TRUSSES WILL BE BUILT. VERIFY ALL CONDITIONS TO INSURE AGAINST CHANGES THAT WILL RESULT IN EXTRA CHARGES TO YOU.

REVIEWED BY: _____ APPROVED BY: _____ DATE: _____

Hanger Conversion Chart

USP	Simpson
JUS26	LUS26
THD26	HUS26
THD26-2	HHUS26-2
HJC26	THJA26
MSH422	THA422

Client: **MATTAMY HOMES**

Job Name: **CLEARWATER - COLONIAL**

Model: **1ST FLOOR HEADERS**

Lot #: **5**

Order #: **24-0819-B**

Subdivision: **HAMPTON RIDGE**

Sales Rep: **C Walden**

Designer: **R S**

Date: **2/12/2024**

733 RIVER PARK DRIVE
DANVILLE, VA 24540
(434) 793-0217
FAX: (434) 799-8767

RIVERSIDE ROOF TRUSS, LLC

Roof Surface Area: **0 ft²** Sq. Ft.
 Floor Surface Area: **3137 ft²** Sq. Ft.

