

PERMIT # SFD 2402-0013

☒ New Installation ☒ Septic Tank ☒ Nitrification Line ☐ Repair ☐ Expansion

PROPERTY LOCATION: 280 Hook Dr, Enguay

Name: (owner) Lilium Home

SUBDIVISION Cotton Farms

LOT #	13
-------	----

System Installer: True Works Inc

Basement with plumbing: ☐ Garage ☒ Number of Bedrooms 4

Type of Water Supply: ☐ Community ☒ Public ☐ Well Distance from well _____ feet

System Type: 25% Reduction System Type III(b) EZ Flow Types V and VI Systems expire in 5 years.

(In accordance with Table V a)

Owner must contact Health Department 6 months prior to expiration for permit renewal.

This system has been installed in compliance with applicable North Carolina General Statutes, Rules of Sewage Treatment and Disposal, and all conditions of the Improvement Permit and Construction Authorization.

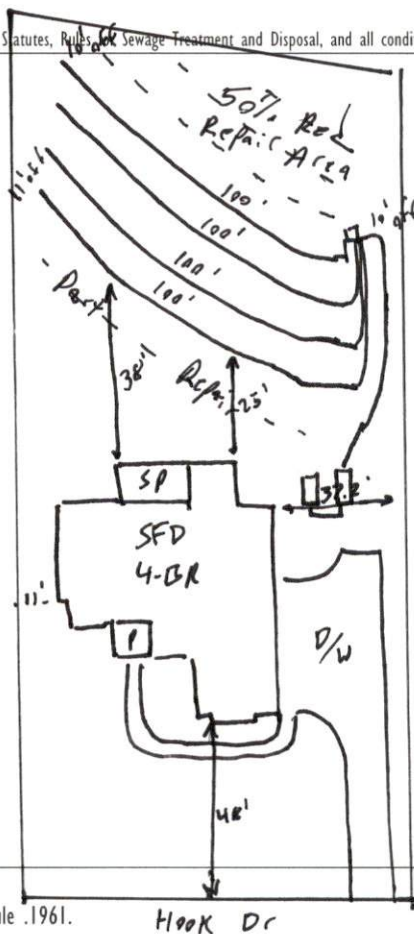
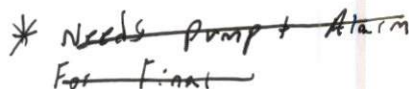

PERMIT CONDITIONS:

- I. Performance: System shall perform in accordance with Rule .1961. *Hook Dr*
- II. Monitoring: As required by Rule .1961.
- III. Maintenance: As required by Rule .1961. Other: _____
Subsurface system operator required? Yes ☐ No ☐
If yes, see attached sheet for additional operation conditions, maintenance and reporting.
- IV. Operation: _____
- V. Other: _____

<input type="checkbox"/>	D-Box	<input type="checkbox"/>	Pump	<input type="checkbox"/>	Alarm	<input type="checkbox"/>	H2OLine	<input type="checkbox"/>	PWR Line
--------------------------	-------	--------------------------	------	--------------------------	-------	--------------------------	---------	--------------------------	----------

Following are the specifications for the sewage disposal system on the above captioned property.

Type of system: ☐ Conventional ☒ Other Type III (6) EZ Flow Septic Tank: 1,000 gallons Pump Tank: 1,000 gallons

Subsurface Drainage Field	No. of ditches	4	exact length of each ditch	100'	feet	width of ditches	3'	feet	depth of ditches	18"	inches
------------------------------	-------------------	---	-------------------------------	------	------	---------------------	----	------	---------------------	-----	--------

French Drain Required: _____ Linear feet

Authorized State Agent Paul J. NEHS

Date 8-28-25