

APPENDIX G

DESIGN PROFESSIONAL INSPECTION FORM

RECORD OF THE INSPECTION OF A **COMPONENT OR ELEMENT** BY A NC LICENSED ARCHITECT OR ENGINEER

Project Information:

Residential Single-Family Project: Y N	Commercial Project: Y N
Code Enforcement Project No:	Permit No:
Project Name:	Owner:
Project Address:	Suite No:
Date Inspected:	Contractor Name:
Component Inspected:	

Responsible Licensed NC Architect or NC Engineer

Name:			
Firm Name:			
Phone Numbers:	Office:	Mobile:	
Email Address:			
Mailing Address:			

APPLICABLE CODE:

2018 NCBC = 2018 NC Building Code; 2018 NCRC = 2018 NC Residential Code

Describe Element/Component/Type of Inspection: *

*(subgrade form/letter may also be required)

Attestation/Signature:

By signing below, I certify that the component and/or element of the building as identified on this form has been inspected by me or someone under my direct supervision per G.S. 160D-11-6 and is in compliance with the Code or other proposal of the architect or engineer for the project. This inspection is in compliance with all of the requirements of the above referenced code. Attach any additional documents if needed.

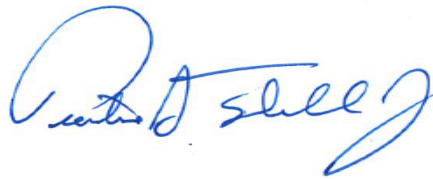

Licensed Architect or Engineer

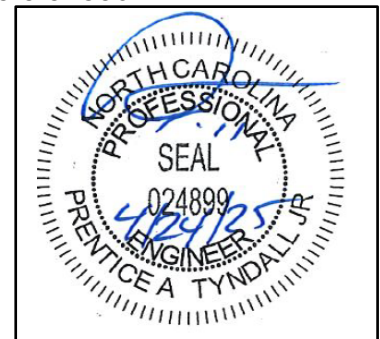

Inspection Department disclaimer:

Upon the receipt of a signed written document as required under subsection (a) of G.S. 160D-11-1, Code Enforcement shall be discharged and released from any liabilities, duties and responsibilities imposed by this article or in common law from any claim arising out of or attributed to the component or element in the construction of the building for which the signed written document was submitted. Be aware that this inspection will be noted in all inspection records including the Certificate of Occupancy or Certificate of Compliance. This inspection does not address any local ordinances or zoning requirements.



April 23, 2025

C & C Services
Chad Tyndall
3782 Tyndall Bridge Road
Salemberg, NC 28385

Reference: Engineering Services
173 Jones Creek Lane
Lillington, NC 27546
Project No.: 2501-020311

To Whom It May Concern:

- 1) 3RD party footing excavation observations.
- 2) Observe the materials/condition of the addition foundation bearing soils.

The following conclusions and recommendations were noted:

- 1) The existing excavated footings were visually observed with regard to compliance with the project plans and applicable provisions of the 2018 North Carolina Residential Building Code. Based on our visual observations and analysis, the existing footing was prepared in general accordance with the project plans and applicable provisions of the 2018 North Carolina Residential Building Code.
- 2) The materials/condition of the foundation bearing soils were visually observed, and qualitatively probed. Based on our observations and analysis, the in-situ soils were noted as being adequate to support the anticipated loading conditions (2000 PSF).

We appreciate being able to assist you during this phase of the project. If you need further assistance or require additional information, please do not hesitate to contact us.

Sincerely,
Tyndall Engineering & Design

Prentice A. Tyndall Jr., PE
PT III | 2501-020311









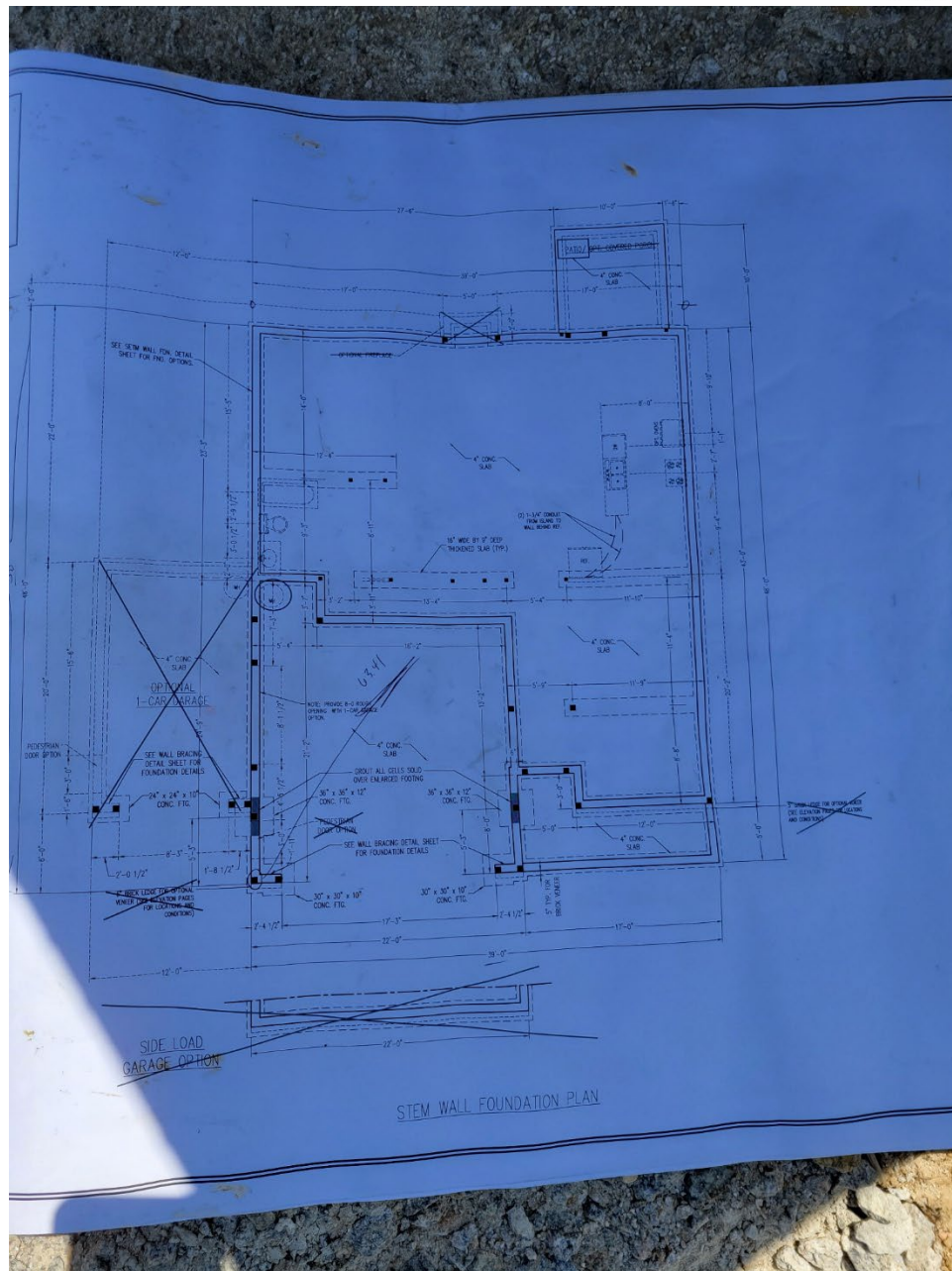



JNC009



SINGLE FAMILY DWELLING
910-893-7525
www.harnett.org

PERMIT NUMBER
SFD2401-0158

JOB ADDRESS: 173 JONES CREEK LN	PERMIT SUBTYPE: SFD STEM WALL	PARCEL NO: 0519-47-1205.000
DESCRIPTION: 37' x 58' SFD 3 Bed, 2 Bath	DATE ISSUED: 3/19/2025	DATE EXPIRED:
PLAN NAME: Rose GL	ZONING DISTRICT: RA-30 - 0.64 acres (100.0%)	

APPLICANT: A & G Residential LLC 2533 Raeford Rd, Suite C Fayetteville, NC 28305	PHONE: (910)779-0229 EMAIL: anastasia@agresidentialnc.com
CONTRACTOR: A & G Residential LLC 2533 Raeford Rd, Suite C Fayetteville, NC 28305	PHONE: (910)779-0229 EMAIL: anastasia@agresidentialnc.com
OWNER: BS LAND LLC 173 JONES CREEK LN LILLINGTON, NC 27546 ANGIER, NC 27501-8342	PHONE: EMAIL:

REQUIRED INSPECTIONS			
INSPECTION TYPE	APPROVAL	DATE	COMMENTS
ADDRESS			
FOOTING			
FOUNDATION			
GAS PIPING			
ROUGH IN			
SEWER CONNECTION			
SLAB			
TEMP POWER CERTIFICATION			
T-POLE			
UNDER SLAB TRADES			
WATER CONNECTION			
FOUNDATION SURVEY			
INSULATION			
ENVIR OPERATIONS PERMIT			
FINAL SFD STEMWALL**			

Harnett County Development Services
P.O. Box 65, 108 E Front St
Lillington NC 27546

