



ECS Southeast, LLC

6151 Raeford Road, Suite A
Fayetteville, NC 28304
9104013288
9103230539

LETTER OF TRANSMITTAL

August 21, 2024
Onsite Homes NC
2931 Breezewood Ave STE 202
Fayetteville, NC 28303
ATTN: Chris Greene

RE: **Lemuel Black Lot 2 3M**
ECS Job # **33:7012-B**
Permits:
Location: **2919 Lemuel Black Road**
Bunnlevel, NC 28323

Field Reports For your use As requested

CC: Onsite Homes NC - Scott Terry

ENCL: Field Report # 1 8/20/2024

Jack Cowsert, P.E.
Office Manager

Aaron Kyle Adair
CMT Senior Project Coordinator

Disclaimer

1. This report (and any attachments) shall not be reproduced except in full without prior written approval of ECS.
2. The information in this report relates only to the activities performed on the report date.
3. Where appropriate, this report includes statements as to compliance with applicable project drawings, and specifications for the activities, performed on this report date.
4. Incomplete or non-conforming work will be reported for future resolution.
5. The results of samples and/or specimens obtained or prepared for subsequent laboratory testing will be presented in separate reports/documents.



ECS Southeast, LLC
6151 Raeford Road, Suite A
Fayetteville, NC 28304
(910) 401-3288 [Phone]
(910) 323-0539 [Fax]

FIELD REPORT

Project **Lemuel Black Lot 2 3M**
Location **Bunnlevel, NC**
Client **Onsite Homes NC**
Contractor **Onsite Homes NC**

Project No. **33:7012-B**
Report No. **1**
Day & Date **Tuesday 8/20/2024**
Weather **76 °/ Sunny**
On-Site Time **1.75**
Lab Time **0.00**
Travel Time* **0.00**
Total **1.75**
Re Obs Time **0.00**

Remarks

Trip Charges*	Tolls/Parking*	Mileage*	Time of Arrival	Departure
Chargeable Items			11:45A	1:30P

* Travel time and mileage will be billed in accordance with the contract.

Summary of Services Performed (field test data, locations, elevations & depths are estimates) & Individuals Contacted.

ECS arrived on site, as requested, to check the bearing capacity of soils via hand auger/DCP method (ASTM STP-399) for monolithic slab. Please see the attached sketch and data sheet for details.

A total of 4 hand auger/DCP evaluations were performed to a depth of approximately 4 feet below the current footing sub grade elevation. Test results indicated that the materials in place (at the locations and elevations tested) did appear to be suitable to support the design bearing capacity of 2,000 psf.

ECS will return, as requested, for additional services.

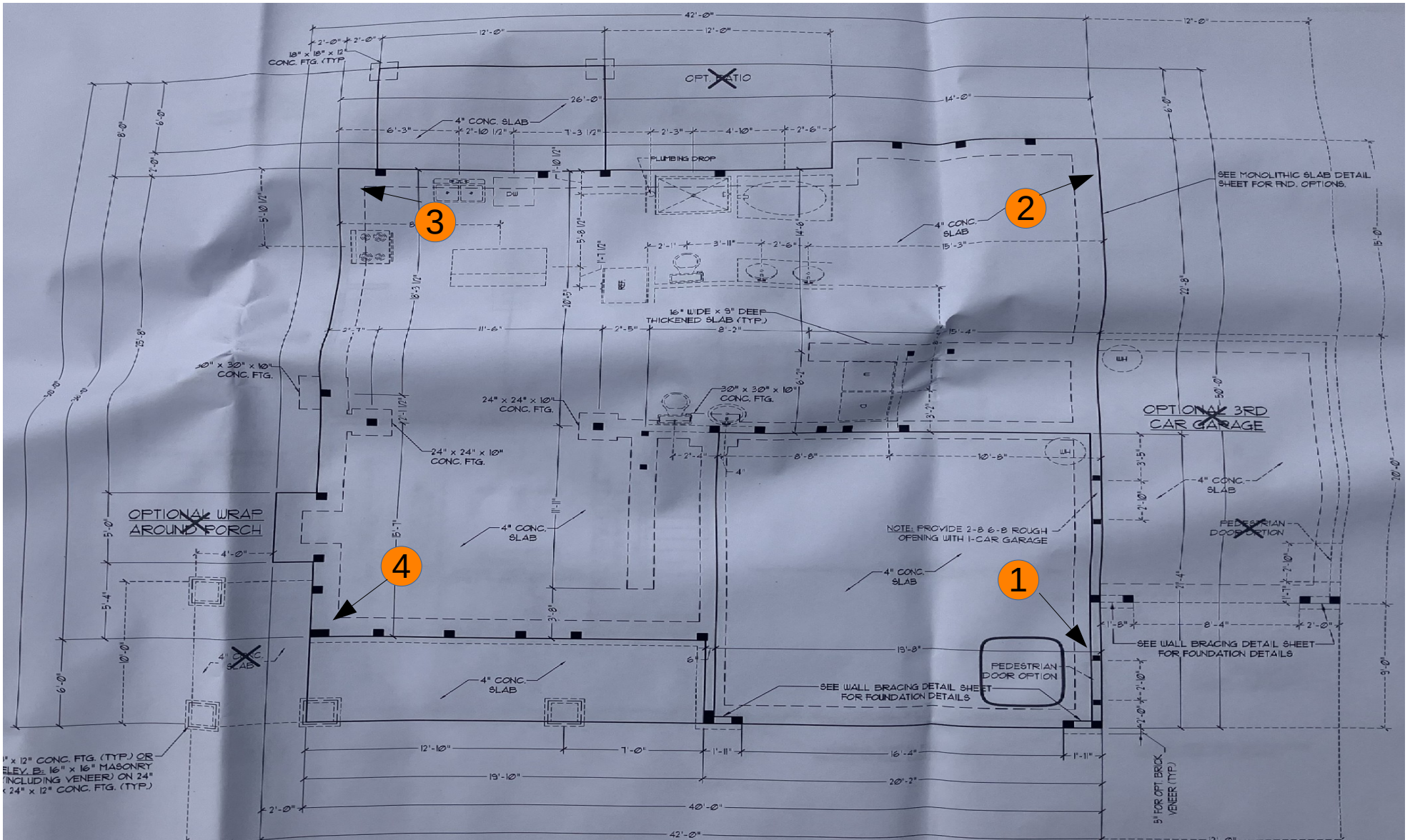

Izayah Rutledge
 August 20, 2024
 Lemuel Black Lot #2
 P: 7012-B
 WO: 79150

Key (NTS)
 DCP Locations

#

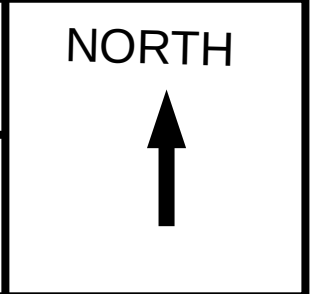



Report of Spread Footing - Foundation Observations

Project: Lemuel Black Lot 2 3M
 Location: 2919 Lemuel Black Road
 Bunnlevel - Harnett County - NC - 28323
 Contractor: Onsite Homes NC

Project No.: 33:7012-B
 Day/Date: 8/20/2024

Footing Number	Location	Size (W x H x L)		Footing Bottom Elevation		Description of Steel Placed	Description of Subgrade Material	Required Blow Counts	Design Bearing Pressure
		Design	Actual	Design **	Depth of Undercut (in)			# of Blows / Increment	
1	Southeast Corner	x x	x x	N/A	N/A		-1:Orange Clayey Sand - 2:Dark Brown Sand -3,- 4:Brown Clayey Sand (Moist & Groundwater)	6 -1:11,10,11 -2:6,4,3 - 3:10,9,10 -4:15+	2000
2	Northeast Corner	x x	x x	N/A	N/A		-1:Dark Brown Sand -2:Brown Clayey Sand (Moist) -3,- 4:Brown Clayey Sand (Moist & Groundwater)	6 -1:8,7,5 -2:7,6,6 - 3:14,13,13 -4:15+	2000
3	Northwest Corner	x x	x x	N/A			-1:Brown Sand - 2:Brown Clayey Sand (Moist) -3, -4:Brown Clayey Sand (Moist & Groundwater)	6 -1:7,4,7 -2:9,7,8 - 3:11,10,10 -4:15+	2000
4	Southwest Corner	x x	x x	N/A	N/A		-1:Orange Clayey Sand - 2:Dark Brown Sand -3:Brown Clayey Sand (Moist) - 4:Brown Clayey Sand (Moist & Groundwater)	6 -1:15+ -2:7,5,5 -3:9,7,7 - 4:7,8,8	2000



Report of Spread Footing - Foundation Observations

Project: Lemuel Black Lot 2 3M
Location: 2919 Lemuel Black Road
Bunnlevel - Harnett County - NC - 28323
Contractor: Onsite Homes NC

Project No.: 33:7012-B
Day/Date: 8/20/2024

** SGE: Subgrade Elevation to be determined by surveyor.

By: Izayah MoReil Rutledge

ECS Southeast, LLC

WO: 79150

Attachments



2024-Aug-20 (12)

Figure 1



2024-Aug-20 (13)

Figure 2

Attachments



2024-Aug-20 (14)

Figure 3



2024-Aug-20 (15)

Figure 4

Attachments



2024-Aug-20 (16)

Figure 5



2024-Aug-20 (17)

Figure 6

Attachments



2024-Aug-20 (18)

Figure 7



2024-Aug-20 (19)

Figure 8