

**WARNING!** Long span trusses, 60' or greater in length, require extreme care and experience for proper and safe handling and installation. For general handling and installation guidance, see the "Guide to Good Practice for Handling, Installing, Restraining & Bracing of Metal Plate Connected Wood Trusses" ("BCSI"), JOINTLY PRODUCED BY SBCA and TPI. For project specific guidance, consult with a registered design professional. ATLANTIC assumes no responsibility for the handling, installation or bracing of trusses.

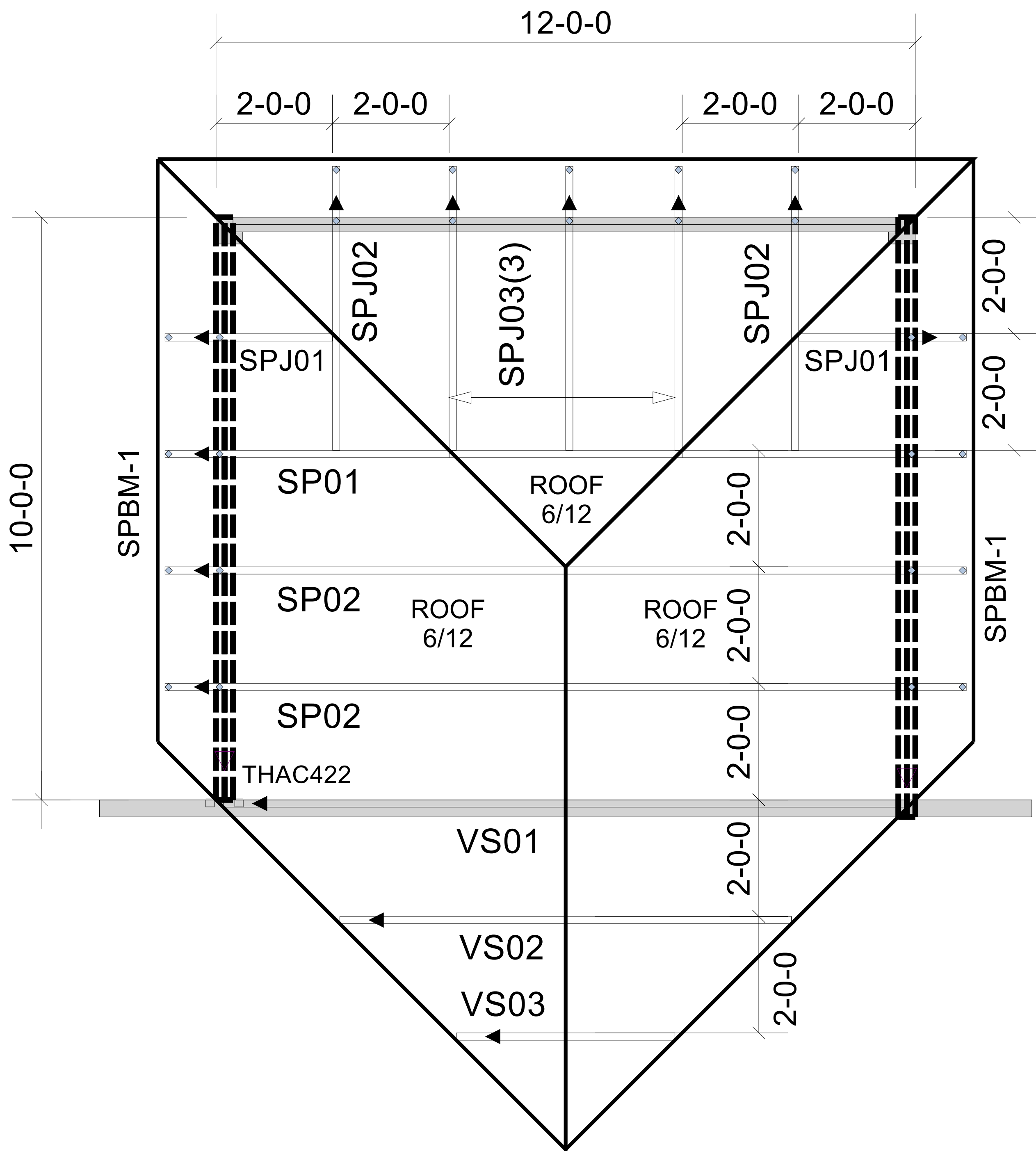

Products				
PlotID	Length	Product	Plies	Net Qty
SPBM-1	12-00-00	1-3/4" x 9-1/2" VERSA-LAM® 2.0 3100 SP	2	2
SPBM-1	10-00-00	1-3/4" x 9-1/2" VERSA-LAM® 2.0 3100 SP	2	2

Connector Summary			
Qty	Manuf	Product	Flange
1	Simpson	THAC422	None

TRUSS TO TRUSS CONNECTIONS  
ARE 3-10d TOE-NAILS U.N.O.

▲ = LEFT END OF TRUSS

**FOR PERMIT**



Moncks Corner/Easley, SC (800) 475-3999  
Sparta, NC (336) 372-2226

REVISIONS:

Client: MATTAMY HOMES-RALEIGH

Job: LOT 60 PROVIDENCE CREEK

Plan Information:  
CLEARWATER-CR

NOT TO SCALE

Date: 01/11/24

Drawn By: MBB

Job #: Sales Rep: KYLE GIBSON  
24-0288-R01 Phone:

ROOF