

AS-BUILT IMPROVEMENTS FOR  
**NEW HOME, INC.**  
 81 EAGLE CREST COURT  
 LOT 09, HERITAGE AT NEILL'S CREEK SUBDIVISION  
 NEILL'S CREEK TOWNSHIP, HARNETT COUNTY, NORTH CAROLINA

**LEGEND**

- ▲ AIR CONDITIONER
- BC BACK OF CURB
- BFP BACK FLOW PREVENTER
- CLEANOUT
- CURB INLET
- DHS DRILL HOLE SET
- ECM EXISTING CONCRETE MONUMENT
- EDH EXISTING DRILL HOLE
- EIS EXISTING IRON STAKE
- EIP EXISTING IRON PIPE
- EM ELECTRIC METER
- EPK EXISTING PK NAIL
- ES ELECTRIC STUB
- FLA FLARED END SECTION
- FH FIRE HYDRANT
- FOP FIBER OPTIC PEDESTAL
- GM GAS METER
- GUY GUY
- INVERT
- IPS IRON PIPE SET
- IRS IRON ROD SET
- LP LIGHT POLE
- MNS MAGNETIC NAIL SET
- MS MANHOLE SANITARY SEWER
- MSS MANHOLE STORM SEWER
- OHV OVERHEAD WIRES
- PKS PK NAIL SET
- PNS POINT NOT SET
- RSS RAIL ROAD SPIKE
- RTP TELEPHONE PEDESTAL
- TR TRANSFORMER
- CTV CABLE TV PEDESTAL
- UP UTILITY POLE
- WM WATER METER
- WV WATER VALVE
- YI YARD INLET
- ( ) FIELD MEASUREMENT

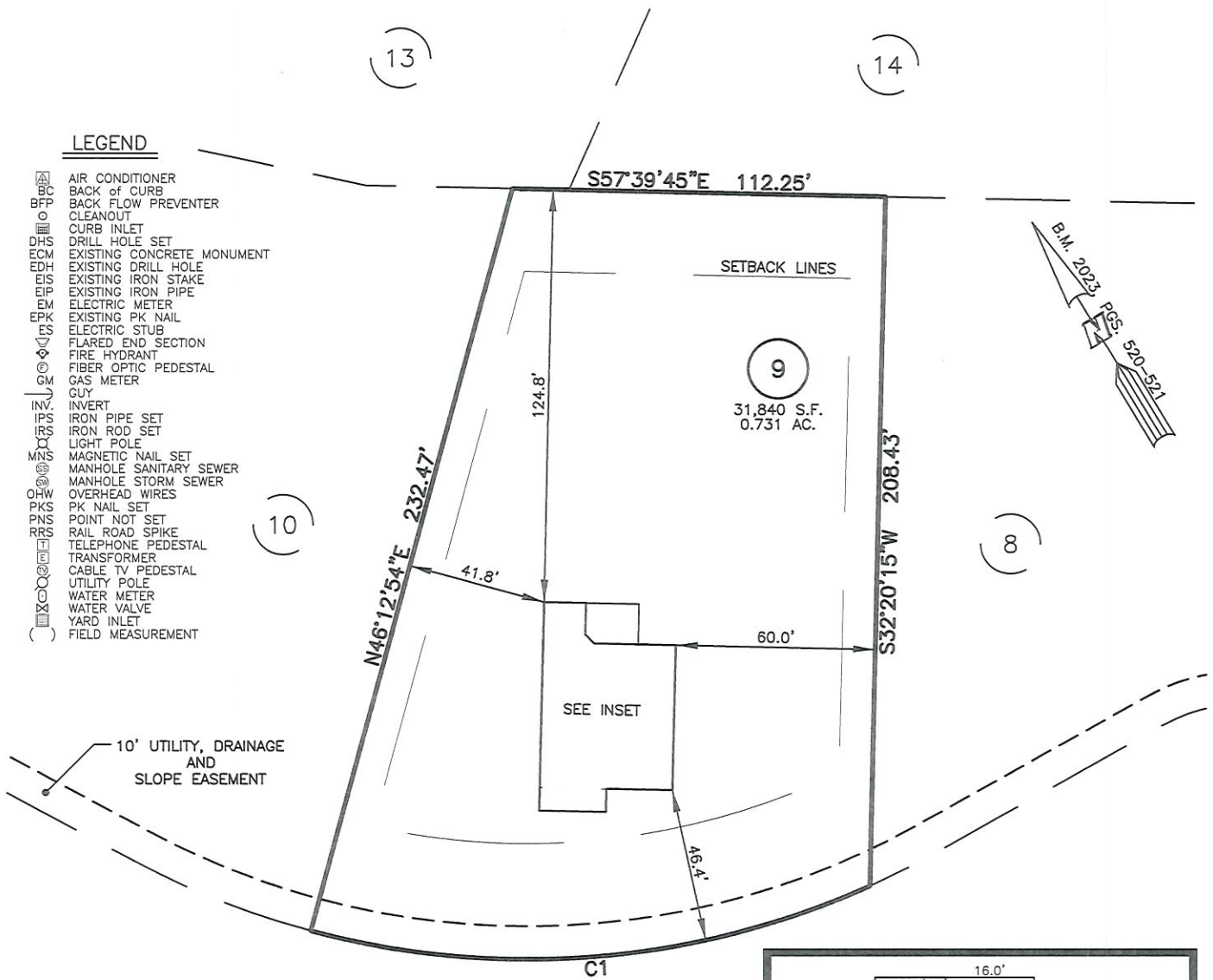

**REFERENCES:**

B.M. 2023, PGS. 520-521

**EAGLE CREST COURT**  
 50' PUBLIC R/W

**SETBACK INFO**

FRONT: 35'  
 REAR: 25'  
 SIDES: 10'  
 CORNER SIDE: 20'

NUM	RADIUS	ARC	DELTA	CHORD BRG	CHORD
C1	250.00'	172.28'	39°29'04"	N63°31'38"W	168.89'

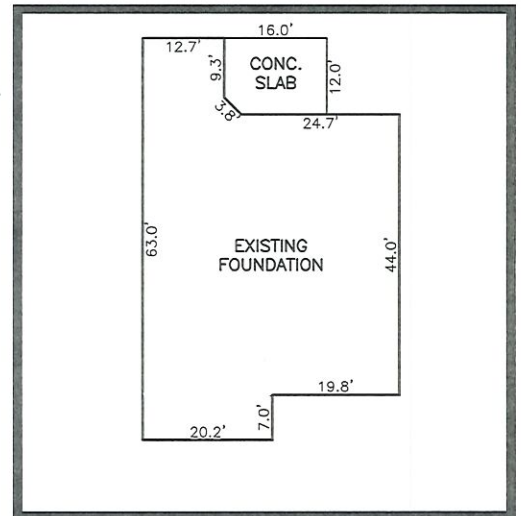

INSET SCALE: 1"=30'

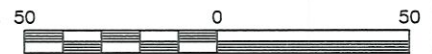

SCALE: 1" = 50'

THIS AS-BUILT IS  
 FOR CODE COMPLIANCE.  
 NOT FOR SALES OR  
 CONVEYANCE

WAKE COUNTY, NORTH CAROLINA

I CERTIFY THAT THIS MAP WAS DRAWN UNDER MY SUPERVISION FROM FIELDWORK DONE UNDER MY SUPERVISION; THAT THE IMPROVEMENTS LIE WHOLLY UPON THE LOT AND THAT THE PROPERTY SHOWN IS AN EXISTING PARCEL OR PARCELS OF LAND.

*Charles R. Piratzky*  
 CHARLES R. PIRATZKY, PROFESSIONAL LAND SURVEYOR  
 L-2813  
 SEAL  
 L-2813  
 CHARLES R. PIRATZKY

10-18-24  
 DATE

DATE: OCT. 09, 2024  
 F.B. \_\_\_\_\_

**NOTES**

- THIS SURVEY SUBJECT TO ANY FACTS THAT MAY BE DISCLOSED BY A FULL AND ACCURATE TITLE SEARCH.
- THIS MAP MAY NOT BE A CERTIFIED SURVEY AND HAS NOT BEEN REVIEWED BY A LOCAL GOVERNMENT AGENCY FOR COMPLIANCE WITH ANY APPLICABLE LAND DEVELOPMENT REGULATIONS AND HAS NOT BEEN REVIEWED FOR COMPLIANCE WITH RECORDING REQUIREMENTS FOR PLATS.

**RWK, PA**  
 ENGINEERING ~ SURVEYING  
 CORPORATE LICENSE: C-1771  
 101 W. MAIN ST., SUITE 202  
 GARNER, NC 27529  
 PHONE (919) 779-4854  
 FAX (919) 779-4056