

*House footprint to be field staked by surveyor and system verified prior to any construction

**Septic area must not be altered by construction activities.

***No cuts of 2' or greater within 15' of septic area

**** Recommend protective barrier around septic field during construction.

4-Bedroom Septic Plan
Lot #45 - Duncan's Crossing
Harnett County
Smith Douglas Homes

45

46,034 SF
(1.06 AC)

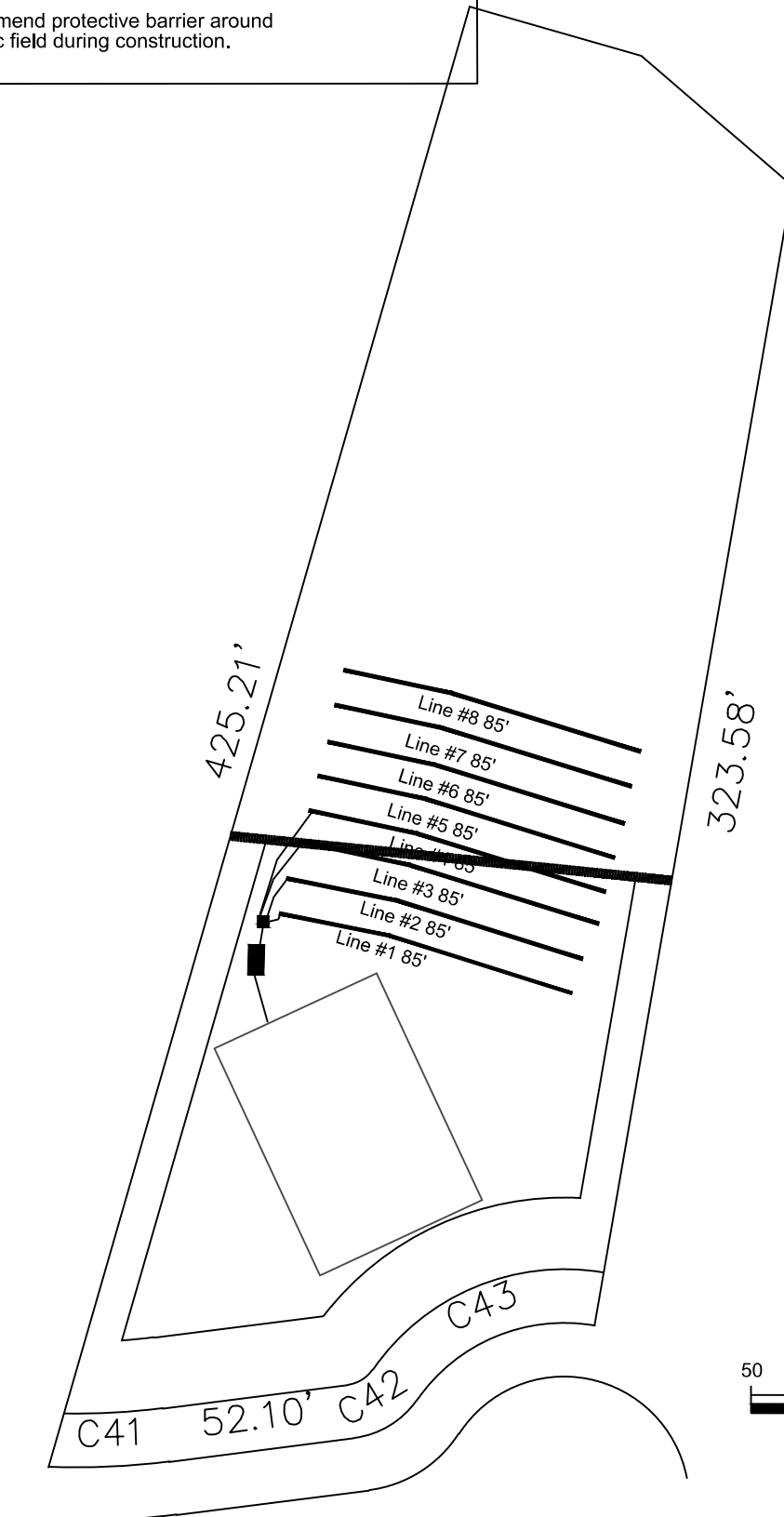

*If plumbing is not sufficient a pump tank will be required to septic field.

System: Pump to D-Box
Lines: Lines 1-4 (340')
0.4 LTAR
18" Max Trench Bottom
Accepted Status System
Repair: Pressure Manifold
Lines: Lines 5-8 (340')
0.4 LTAR
18" Trench Bottom
Accepted Status System

GRAPHIC SCALE

1" = 50'



DECOY SPREAD
50' R/W (PUBLIC
& UTILITY ACCESS)

Adams
Soil Consulting
919-414-6761
Job #1146