

SOIL/SITE EVALUATION for ON-SITE WASTEWATER SYSTEM

(Complete all fields in full)

OWNER: Richard William Gregory DATE EVALUATED: 2-6-24
 ADDRESS: 3040 Matthews Mill Road Lot 2, Anglet
 PROPOSED FACILITY: SFD PROPOSED DESIGN FLOW (.0400): 400 PROPERTY SIZE: _____
 LOCATION OF SITE: _____ PROPERTY RECORDED: _____
 WATER SUPPLY: Public Single Family Well Shared Well Spring Other _____ WATER SUPPLY SETBACK: _____
 EVALUATION METHOD: Auger Boring Pit Cut TYPE OF WASTEWATER: Domestic High Strength IPWW

P R O F I L E #	.0502 LANDSCAPE POSITION/ SLOPE %	HORIZON DEPTH (IN.)	SOIL MORPHOLOGY		OTHER PROFILE FACTORS				.0509 PROFILE CLASS & LTAR*	.0503 SLOPE CORRE CTION
			.0503 STRUCTURE/ TEXTURE	.0503 CONSISTENCE/ MINERALOGY	.0504 SOIL WETNESS/ COLOR	.0505 SOIL DEPTH	.0506 SAPRO CLASS	.0507 RESTR HORIZ		
1 / 2 / 3	2-3% LS	0-16	SL, gr	Fr, NS, NP, SE	7.5/1R 5/8 7/2 = 38"	48"			.35	
		16-38	SCL, SBK	Fr, SS, NP, SE						
		38-48	CL, wk SBK	Fr, SS, NP, SE						
2	2-3% LS	0-16	Sh, gr	Fr, NS, NP, SE	7.5/1R 5/8 7/2 = 36"	48"			.35	
		16-36	SCL, SBK	Fr, SS, NP, SE						
		36-48	CL, SBK	Fr, SS, NP, SE						
3	2-3% LS	0-14	SL, gr	Fr, NS, NP, SE	7.5/1R 5/8 7/2 = 28"	48"			.35	
		14-28	SCL, SBK	Fr, SS, NP, SE						
		28-48	CL, SBK	Fr, SS, NP, SE						
4										

DESCRIPTION	INITIAL SYSTEM	REPAIR SYSTEM	SITE CLASSIFICATION (.0509): <u>PS</u> EVALUATED BY: <u>RL/JM</u> OTHER(S) PRESENT: _____
Available Space (.0508)	✓	✓	
System Type(s)	<u>25% Fed</u>	<u>50% Men</u>	
Site LTAR	<u>.35</u>	<u>.35</u>	
Maximum Trench Depth	<u>15"</u>	<u>18-22"</u>	

Comments: _____

LEGEND

LANDSCAPE POSITION	SOIL GROUP	SOIL TEXTURE	CONVENTIONAL LTAR (gpd/ft ²)	SAPROLITE LTAR (gpd/ft ²)	LPP LTAR (gpd/ft ²)	MINERALOGY/ CONSISTENCE		STRUCTURE	
						MOIST	WET		
CC (Concave slope)	I	S (Sand)	0.8 - 1.2	0.6 - 0.8	0.4 - 0.6	MOIST	WET	SG (Single grain)	
CV (Convex Slope)		LS (Loamy sand)		0.5 - 0.7		Lo (Loose)	NS (Non-sticky)	M (Massive)	
D (Drainage way)	II	SL (Sandy loam)	0.6 - 0.8	0.4 - 0.6	0.3 - 0.4	VFR (Very friable)	SS (Slightly sticky)	GR (Granular)	
FP (Flood plain)		L (Loam)		0.2 - 0.4		FR (Friable)	S (Sticky)	SBK (Subangular blocky)	
FS (Foot slope)	III	SiL (Silt loam)	0.3 - 0.6	0.1 - 0.3	0.15 - 0.3	FI (Firm)	VS (Very sticky)	ABK (Angular blocky)	
H (Head slope)		SCL (Sandy clay loam)		0.05 - 0.15**		VFI (Very firm)	NP (Non-plastic)	PR (Prismatic)	
L (Linear Slope)		CL (Clay loam)		None		0.15 - 0.3	EFI (Extremely firm)	SP (Slightly plastic)	PL (Platy)
N (Nose slope)		SiCL (Silty clay loam)					P (Plastic)		
R (Ridge/summit)		Si (Silt)						VP (Very plastic)	
S (Shoulder slope)	IV	SC (Sandy clay)	0.1 - 0.4	0.05 - 0.2	SEXP (Slightly expansive)				
T (Terrace)		SiC (Silty clay)			EXP (Expansive)				
TS (Toe Slope)		C (Clay)							
		O (Organic)	None						

* Adjust LTAR due to depth, consistence, structure, soil wetness, landscape, position, wastewater flow and quality.

**Sandy clay loam saprolite can only be used with advanced pretreatment in accordance with 15A NCAC 18E .1200.

HORIZON DEPTH In inches below natural soil surface

DEPTH OF FILL In inches from land surface

RESTRICTIVE HORIZON Thickness and depth from land surface

SAPROLITE S(suitable) or U(unsuitable); Evaluation of saprolite shall be by pits.

SOIL WETNESS Inches from land surface to free water or inches from land surface to soil colors with chroma 2 or less - record Munsell color chip designation

CLASSIFICATION S (Suitable) or U (Unsuitable)

Show profile locations and other site features (dimensions, reference or benchmark, and North).

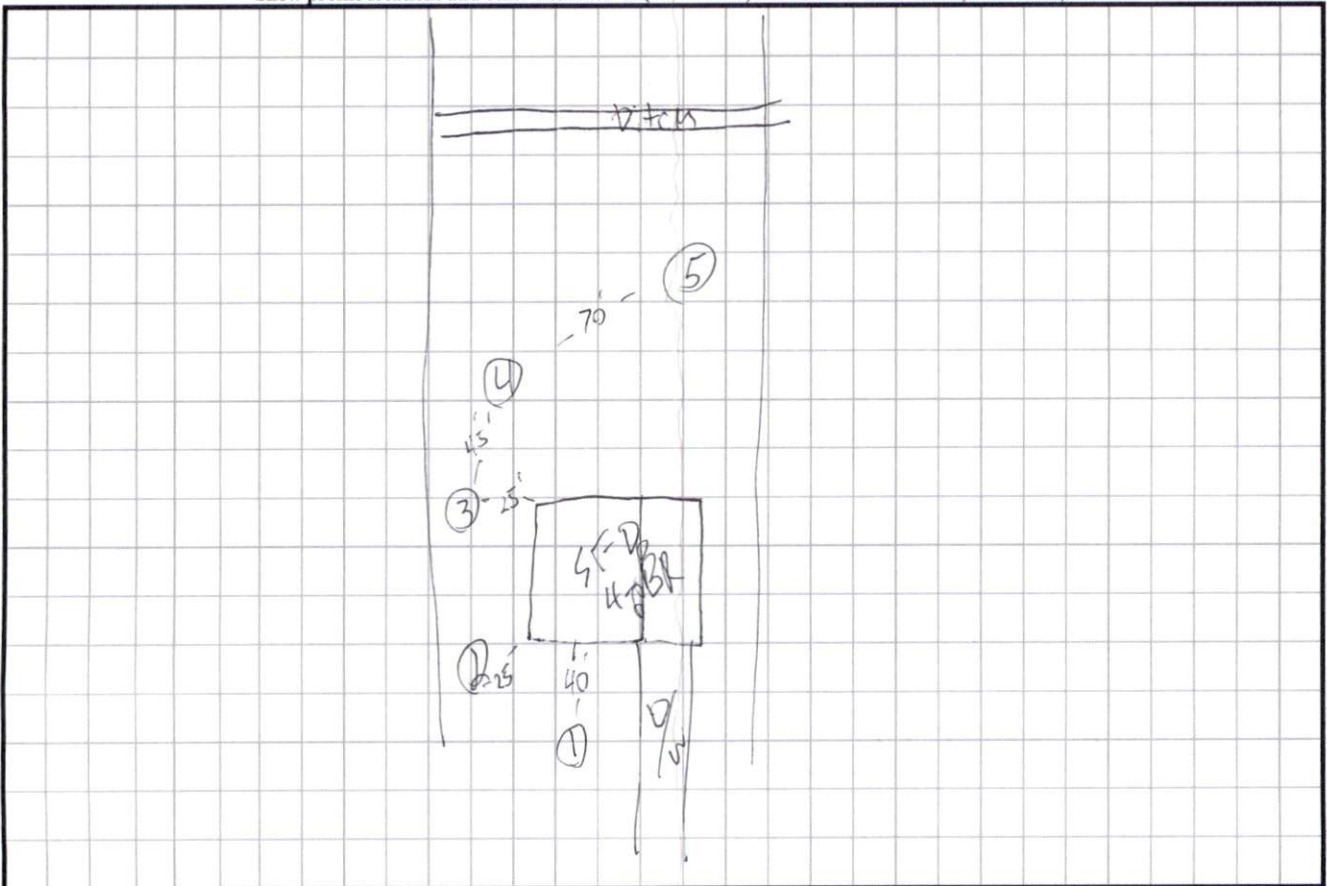



Plat, North
Plat Cabinet 2, Page 277

Plot Plan Only Not A Survey

3

William Harold Stamey
Julie Ann Stamey
Deed Book 4218, Page 1537
Map Number 2023-19

2

✓ 1.091 Ac. Total
0.086 Ac. Road R/W
1.005 Ac. Net

5

Richard William Gregory
Deed Book 3610, Page 593
Plat Cabinet 2, Slide 277
Map Number 2023-19

1

Richard William Gregory
Deed Book 3610, Page 593
Map Number 2023-19

Matthews Mill Pond Road
SR 1510
60' Public R/W



House Inset
1" = 30'

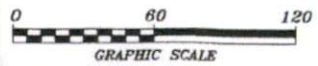

GRAPHIC SCALE

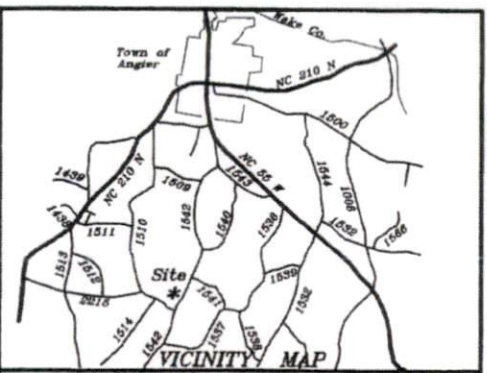

3440 Matthews Mill Pond Rd
Lot 2, Gregory Division
Map Number 2023-19
PIN: 0671-49-1919.000

Surveyed & Mapped for:
Triverse Builders
C/O William Stamey

Neill's Creek Twp. Harnett County
Scale: 1" = 60' Date: 1-15-2024

Surveyed & Mapped By
STANCIL & ASSOCIATES
Professional Land Surveyor, P.A. C-0831
P.O. Box 730, Angier, N.C. 27501
919-639-2133 stancilsurvey@gmail.com



NOT FOR RECORDATION

PAN
LHNC-1289/SHNC-1592