

4-Bedroom Septic Plan  
 Lot #44 - Duncan's Crossing  
 Harnett County  
 Smith Douglas Homes

196

431.17'

425.21'

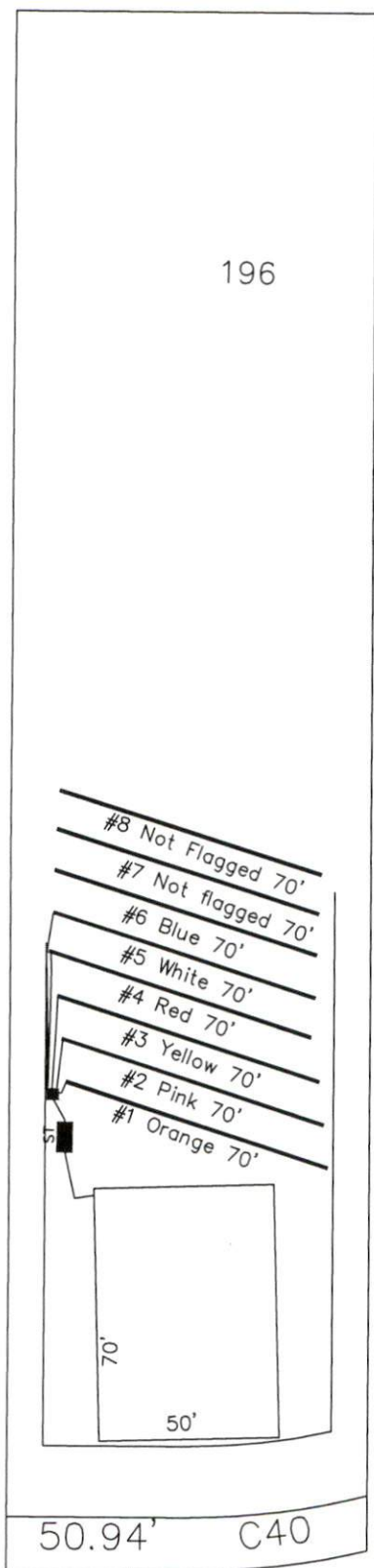

\*House footprint to be field staked by surveyor and system verified prior to any construction

\*\*Septic area must not be altered by construction activities.

\*\*\*No cuts of 2' or greater within 15' of septic area

\*\*\*\* Recommend protective barrier around septic field during construction.

44

43,020 SF  
 (0.99 AC)

\*If plumbing is not sufficient a pump tank will be required to septic field.

System: Gravity to D-Box.  
 Lines: Lines 1-5 (350')  
 0.4 LTAR  
 24" Max Trench Bottom  
 Accepted Status System  
 Repair: Gravity to serial dist.  
 Lines: Lines 6-8 (210')  
 0.4 LTAR  
 24" Trench Bottom  
 T&J Panel - 50% Reduciton

GRAPHIC SCALE  
 1" = 50'



**DECOY SPREAD**  
 50' R/W (PUBLIC  
 & UTILITY ACCESS)

Adams  
 Soil Consulting  
 919-414-6761  
 Job #1146