



March 25, 2024

Robert Barefoot
Attn: Stewart Smith
1115 Purfoy Rd.
Fuquay Varina, NC 27526
Ph: 910-980-3256
Email: Robert Barefoot <wrbarefoot@yahoo.com>

Reference: Engineering Services
Smith Garage
Project No.: DRB2301-0387-A

To Whom It May Concern.

As requested by the client, a representative of Tyndall Engineering & Design, PA (TE&D) reviewed the following items:

1. Stem wall foundation in-lieu of the plan specified monolithic slab.

The following conclusions and recommendations were noted:

1. Based on our plan review and analysis, the proposed stem wall foundation should be constructed in general accordance with the attached diagrams on sheet 2 and 3 of this report.

We appreciate being able to assist you during this phase of the project. If you need further assistance or require additional information, please do not hesitate to contact us.

Sincerely,
Tyndall Engineering & Design

Sean M. Holmes
SMH | DRB2301-0387-A

Prentice A. Tyndall, Jr., P.E.

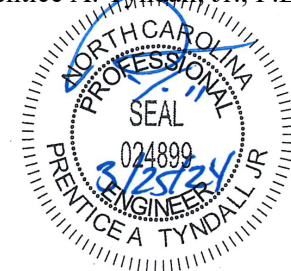

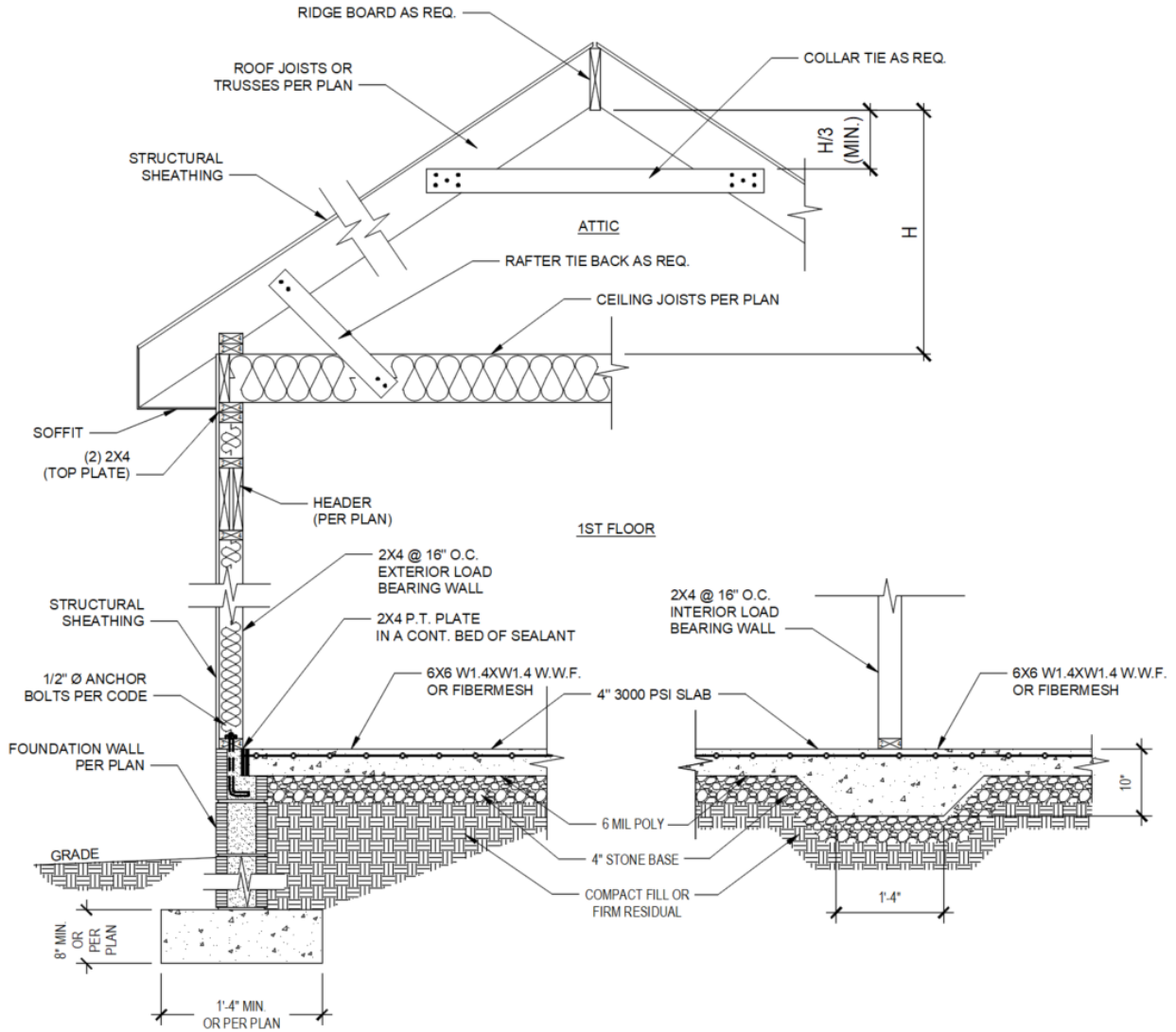

DESIGN LOADS

	LIVE LOAD (PSF)	DEAD LOAD (PSF)	DEFLECTION	
			LL	TL
FLOOR (primary)	40	10	L/360	L/240
FLOOR (secondary)	40	10	L/360	L/240
ATTIC (no storage)	20	10	L/240	L/180
ATTIC (no access)	10	5	L/240	L/180
EXTERNAL BALCONY	40	10	L/360	L/240
ROOF	20	10	L/240	L/180
ROOF TRUSS	20	20	L/240	L/180
WIND LOAD	BASED ON 120 MPH (EXPOSURE B)			
SEISMIC	BASED ON SEISMIC ZONES A, B & C			

STRUCTURAL NOTES:

- ALL CONSTRUCTION SHALL CONFORM TO THE LATEST REQUIREMENTS OF "NORTH CAROLINA STATE 2018 RESIDENTIAL BUILDING CODE", IN ADDITION TO ALL LOCAL CODES AND REGULATIONS.
- IT IS THE CONTRACTOR'S RESPONSIBILITY TO VERIFY ALL DIMENSIONS AND SQUARE FOOTAGE PRIOR TO CONSTRUCTION. TYNDALL ENGINEERING & DESIGN, PA IS NOT RESPONSIBLE FOR DIMENSIONS AND SQUARE FOOTAGE ERRORS ONCE CONSTRUCTION BEGINS.
- ALL LUMBER SHALL BE SYP #2 (UNO)
ALL LVL LUMBER TO BE 1.75" WIDE NOMINAL EACH SINGLE MEMBER AND Fb = 2800 PSI, E = 1.9M PSI
(I.E. LEVEL MICROLAM)
ALL LSL LUMBER IS TO BE 1.55E (Fb = 2325 PSI)
- ALL LOAD BEARING EXTERIOR WINDOW HEADERS ARE TO BE (2) 2x10 w/ (1) 2x4 JACK STUD (U.N.O.) AND KING STUDS PER TABLE R602.7.5, AND TOGETHER w/ (2) 10d NAILS @ 8" O.C., PROVIDED THAT THE TOP OF THE WINDOW HEIGHT IS 8'-0". MINIMUM BOTTOM OF THE WINDOW HEIGHT IS 4'-0". OTHERWISE REFER TO TABLES R602.7(1) AND R602.7(2).
- ALL INTERIOR LOAD BEARING HEADERS TO BE (2) 2x10 (U.N.O.) REFER TO TABLES R602.7(1) AND R602.7(2) FOR JACK STUD REQUIREMENTS FOR HEADER SPANS FOR INTERIOR AND EXTERIOR LOAD CONDITIONS (UNO)
- REFER TO 2018 NC BUILDING CODE SECTION R602 FOR CONSTRUCTION OF ALL WALLS OVER 10'-0" IN HEIGHT.
- ALL STRUCTURAL STEEL SHALL BE ASTM A992 GRADE 50
Fy = 50 KSI MIN. (UNO)
- ALL EXTERIOR LUMBER TO BE #2 SYP PT
- ALL CONCRETE, fc = 3000 PSI MIN.
- PRESUMPTIVE BEARING CAPACITY = 2000 PSF
- 1/2" ANCHOR BOLTS SPACED AT MAXIMUM OF 6'-0" O.C. AND NOT MORE THAN 12" FROM THE CORNER. THERE SHALL BE A MINIMUM OF (2) BOLTS PER PLATE SECTION. ANCHOR BOLTS SHALL BE SPACED AT 3'-0" O.C. FOR BASEMENTS. ANCHOR BOLT SHALL EXTEND 7" INTO CONCRETE OR MASONRY.
- PSL COLUMNS DESIGNED WITH MAX. HEIGHT OF 9'-0" (UNO)
- PROVIDE A MINIMUM OF 500# UPLIFT & LATERAL CONNECTION AT TOP AND BOTTOM OF PORCH COLUMNS. (U.N.O.)
- PROVIDE CONTINUOUS SHEATHING PER SECTION 602.10.3 OF THE 2018 NCR.
- MAXIMUM MASONRY PIER HEIGHT SHALL NOT EXCEED FOUR TIMES ITS LEAST HORIZONTAL DIMENSION.
- UPLIFT LOADS GREATER THAN 500# SHALL BE CONTINUOUSLY ANCHORED TO THE FOUNDATION.
- METAL HANGERS SHALL BE SIMPSON OR APPROVED EQUAL.

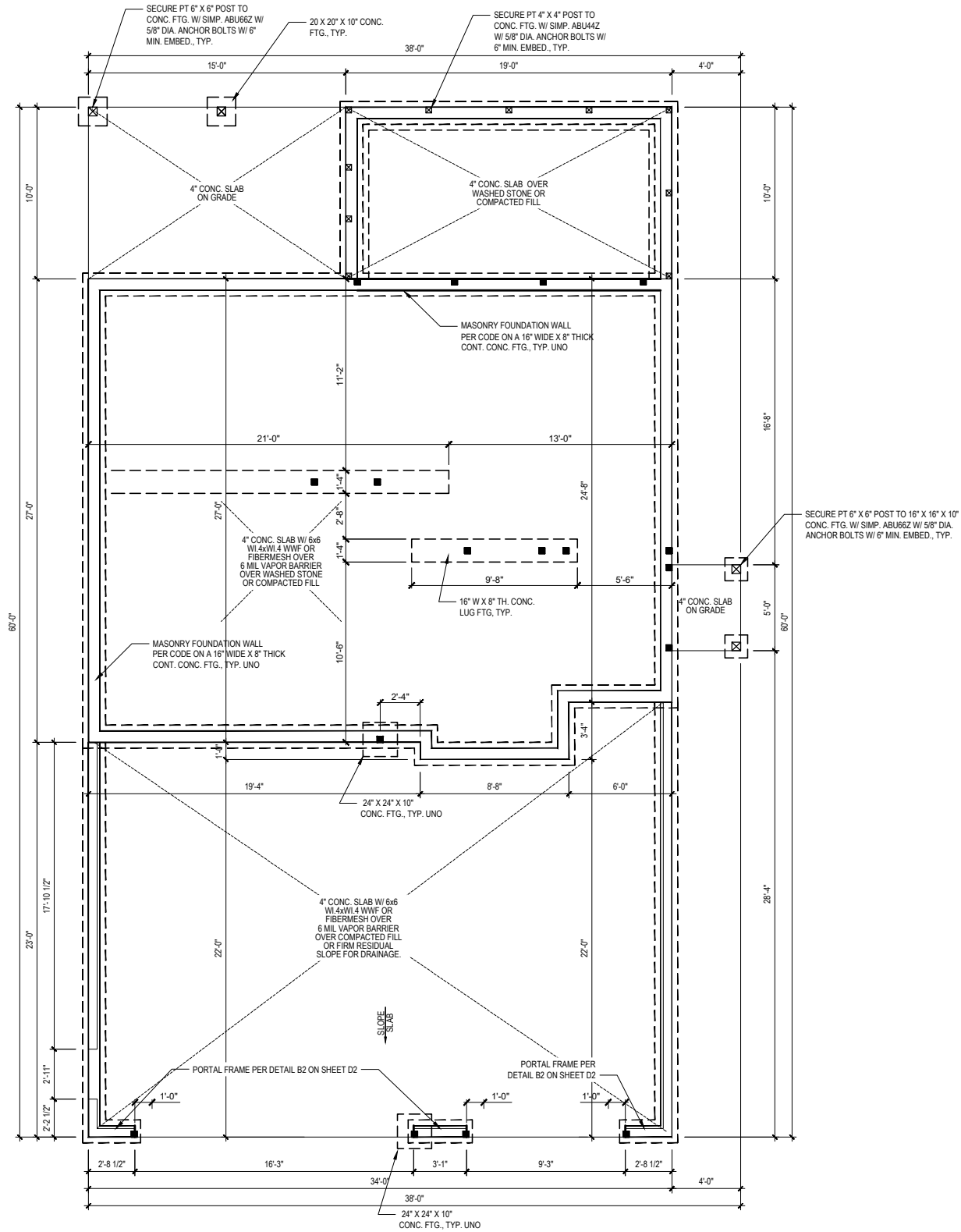

FOUNDATION PLAN

NTS

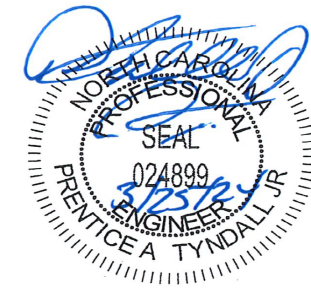

Engineers and architects do not include construction means, methods, techniques, sequences, procedures or safety precautions unless specifically stated in drawings or specifications. Plans are to be brought to the immediate attention of Tyndall Engineering & Design, P.A. Failure to do so will void Tyndall Engineering & Design, P.A. liability. Please review these documents carefully. Tyndall Engineering & Design, P.A. will not interpret that all dimensions were deemed acceptable once construction begins.



STEWART SMITH
 PRENTICEA TYNDALL JR
 ENGINEER

FOUNDATION PLAN

Project #: DRB2301-0387
 Date: 11-8-2023
 Engineer: SMH
 Designer/Checker: PAT
 Scale: SEE PLAN

REVISIONS		
No.	Date	Remarks
1	8-25-24	Stem wall Foundation

Sheet Number
S1
 3 of 3