



AUTHORIZATION TO OPERATE (ATO)

107 Gates Way, Sanford, NC 27332

PROPERTY ADDRESS

The system at the above referenced address was installed in accordance with applicable laws, rules and permit conditions.



9/6/24

DATE OF ATO

ELVIS FAIRCLOTH GRADING, INC.

INSTALLER

Thomas J. Boyce

THOMAS BOYCE, AOWE

Tony Toro

OWNER/REPRESENTATIVE



ELVIFA0

OP ID: CAS

CERTIFICATE OF LIABILITY INSURANCE

DATE (MM/DD/YYYY)
09/09/2024

THIS CERTIFICATE IS ISSUED AS A MATTER OF INFORMATION ONLY AND CONFERS NO RIGHTS UPON THE CERTIFICATE HOLDER. THIS CERTIFICATE DOES NOT AFFIRMATIVELY OR NEGATIVELY AMEND, EXTEND OR ALTER THE COVERAGE AFFORDED BY THE POLICIES BELOW.

IMPORTANT: If the certificate holder is an ADDITIONAL INSURED, the policy(ies) must have ADDITIONAL INSURED provisions or be endorsed. If SUBROGATION IS WAIVED, subject to the terms and conditions of the policy, certain policies may require an endorsement.

PRODUCER: INSURANCE SERV CTR -APEX, APEX BRANCH, 1111 PEMBERTON HILL RD, APEX, NC 27502-3958, JOHN M. MULCAHY
INSURED: ELVIS FAIRCLOTH GRADING, INC., 5104 COOL SPRINGS ROAD, BROADWAY, NC 27505
CONTACT NAME: CARRIE SAYERS, PHONE: 919-387-0560, FAX: 919-387-0570, E-MAIL ADDRESS: CSAYERS@iscfay.com
INSURER(S) AFFORDING COVERAGE: INSURER A: AUTO-OWNERS, INSURER B: STATE AUTO INSURANCE, NAIC #: 18988, 25127

COVERAGES CERTIFICATE NUMBER: REVISION NUMBER:

THIS IS TO CERTIFY THAT THE POLICIES OF INSURANCE LISTED BELOW HAVE BEEN ISSUED TO THE INSURED NAMED ABOVE FOR THE POLICY PERIOD INDICATED. NOTWITHSTANDING ANY REQUIREMENT, TERM OR CONDITION OF ANY CONTRACT OR OTHER DOCUMENT WITH RESPECT TO WHICH THIS CERTIFICATE MAY BE ISSUED OR MAY PERTAIN, THE INSURANCE AFFORDED BY THE POLICIES DESCRIBED HEREIN IS SUBJECT TO ALL THE TERMS, EXCLUSIONS AND CONDITIONS OF SUCH POLICIES. LIMITS SHOWN MAY HAVE BEEN REDUCED BY PAID CLAIMS.

Table with columns: INSR LTR, TYPE OF INSURANCE, ADDL INSD, SUBR WVD, POLICY NUMBER, POLICY EFF (MM/DD/YYYY), POLICY EXP (MM/DD/YYYY), LIMITS. Rows include Commercial General Liability, Automobile Liability, Umbrella Liab, Excess Liab, and Workers Compensation and Employers' Liability.

DESCRIPTION OF OPERATIONS / LOCATIONS / VEHICLES (ACORD 101, Additional Remarks Schedule, may be attached if more space is required)
FOR INFORMATIONAL PURPOSES ONLY

CERTIFICATE HOLDER: FOR INFORMATIONAL PURPOSES ONLY
CANCELLATION: SHOULD ANY OF THE ABOVE DESCRIBED POLICIES BE CANCELLED BEFORE THE EXPIRATION DATE THEREOF, NOTICE WILL BE DELIVERED IN ACCORDANCE WITH THE POLICY PROVISIONS. AUTHORIZED REPRESENTATIVE: JOHN M. MULCAHY



ATO 107 Gates Way 2024

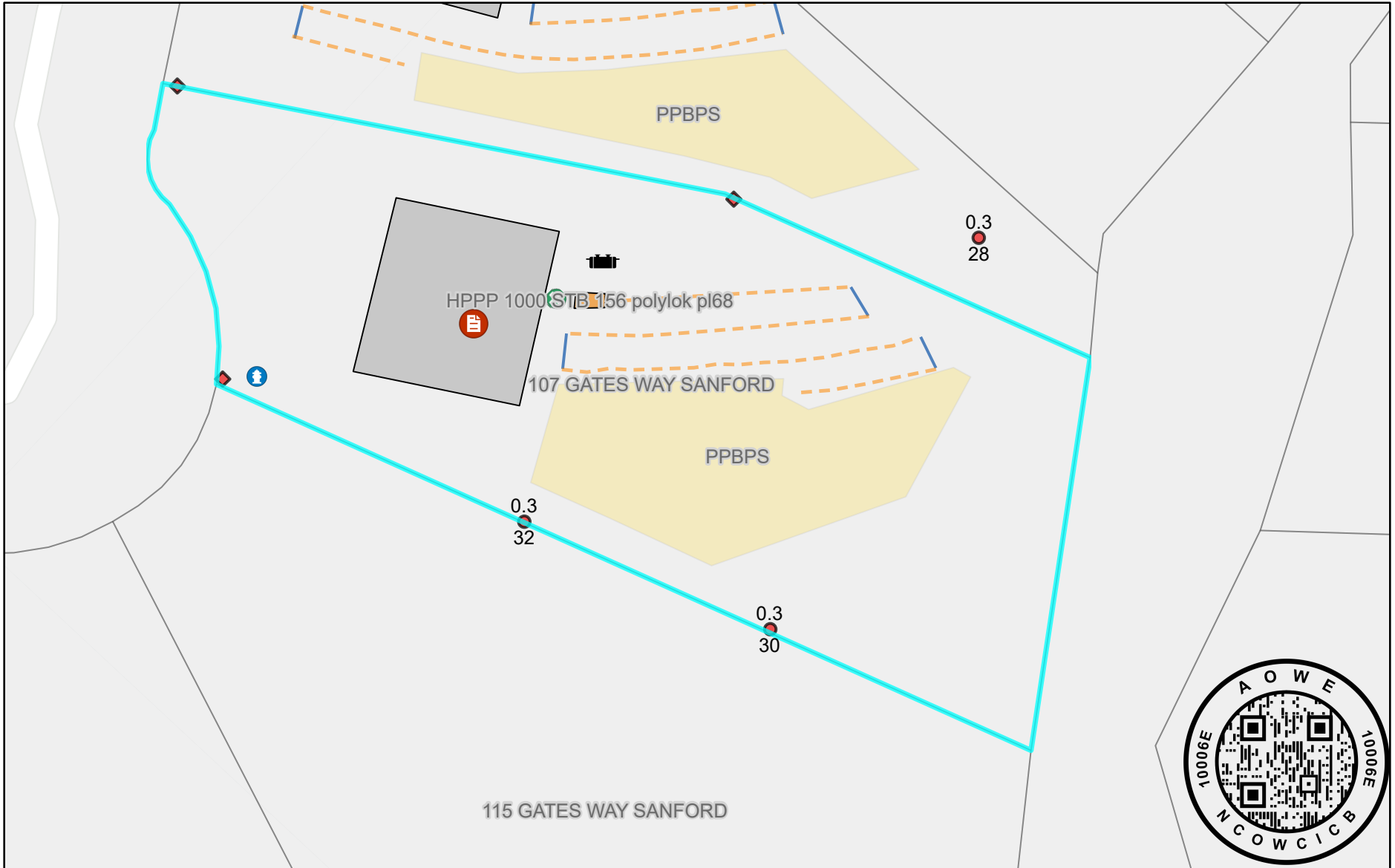

9/6/2024

- | | | | |
|--------------------------|----------------------|----------------------|-----------------|
| Conventional | Bad Topo | System Description | Polygon Generic |
| Property Boundary Marker | Existing Septic Tank | Existing Leach Lines | Line Generic |
| Water Meter | PPBPS | House Box | Parcels |

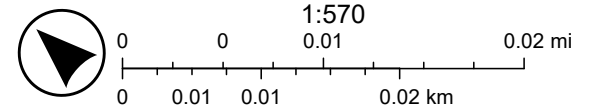

Esri Community Maps Contributors, Lee County NC, State of North Carolina DOT, © OpenStreetMap, Microsoft, Esri, TomTom, Garmin, SafeGraph,

Signature Certificate

Reference number: M4UG7-YDNMX-THPUY-GADSJ

Signer

Timestamp

Signature

Tony Toro

Email: tony@lamcohomes.com

Sent:

09 Sep 2024 15:44:03 UTC

Viewed:

09 Sep 2024 16:58:43 UTC

Signed:

09 Sep 2024 16:59:00 UTC



Recipient Verification:

✓ Email verified

09 Sep 2024 16:58:43 UTC

IP address: 107.15.160.221

Location: Apex, United States

Document completed by all parties on:

09 Sep 2024 16:59:00 UTC

Page 1 of 1



Signed with PandaDoc

PandaDoc is a document workflow and certified eSignature solution trusted by 50,000+ companies worldwide.

