

General Notes:
 - Per ANSI/TPI 1-2002 all "Truss to Wall" connections are the responsibility of the Building Designer, not the Truss Manufacturer.
 - Dimensions are Feet-Inches- Sixteenths.
 - Trusses are to be 24" o.c. unless noted otherwise (U.N.O.)
 - Trusses are not designed to support brick U.N.O.
 - Do not cut or modify trusses without first contacting Builders FirstSource.
 - Immediately contact Builders FirstSource if trusses are damaged.

Connection Notes:
 - All hangers are to be Simpson or equivalent U.N.O.
 - Use Manufacturer's specifications for all hanger connections U.N.O.
 - Use 10d x 1 1/2" Nails in hanger connections to single ply roof girder trusses.

Floor Notes:
 - Shift truss as required to avoid plumbing traps.
 - Installation Contractor and/or Field Supervisor are to verify all dimensions, trap locations, and options prior to installation

Dimension Notes:
 - Drawing not to scale. Do not scale dimensions

3D View 1st Level

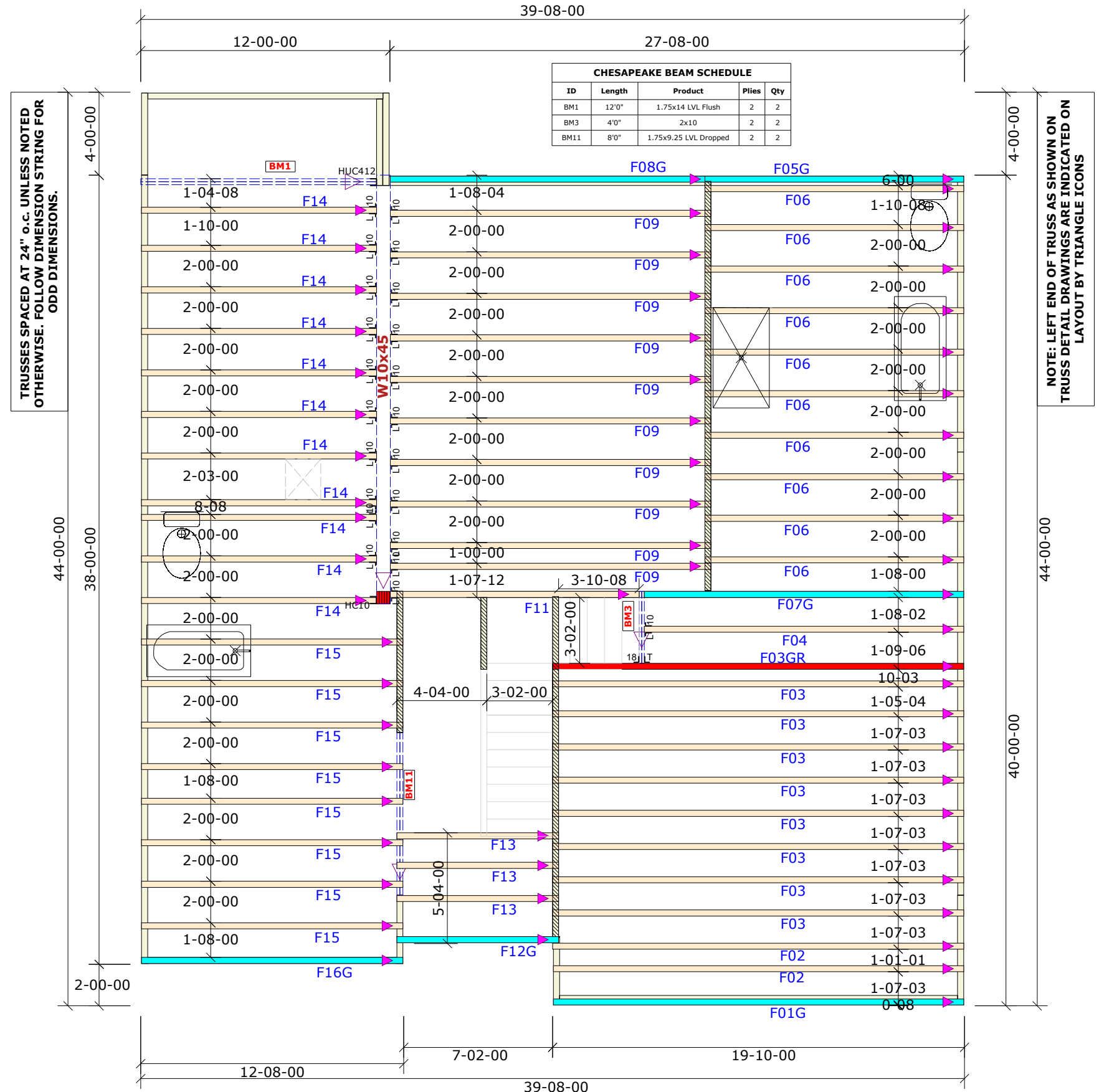

TRUSSES SPACED AT 24" o.c. UNLESS NOTED OTHERWISE. FOLLOW DIMENSION STRING FOR ODD DIMENSIONS.

NOTE: LEFT END OF TRUSS AS SHOWN ON TRUSS DETAIL DRAWINGS ARE INDICATED ON LAYOUT BY TRIANGLE ICONS

Hanger List		All Tie Downs H2.5T Unless noted
0	HHUS410	H ₂ U ₀
1	THA218-2	T ₁ U ₀
1	HUC410	LJ
0	HGUS414	G ₂ U ₀
22	LUS410	HJ U ₀

Special Items List	

Misc Material	

Chesapeake			
6260	Elev:	B	
Farm @ Neill's Point			
Wake	NC	Lot:	92
Appwright #			
Permit (3783714)			
Code:			
IRC 2015			
Loading:			
T.C.L.L.	40		
Designed By:	CFC	T.C.D.L.	10
Layout:	A.FL-R	B.C.L.L.	0
L/O Date:	12/02/2023	B.C.D.L.	5

Revision History		Wind:	
Rev1:	xx/xx/xx	M.P.H.	115
Rev2:	xx/xx/xx	Exposure Category	
Rev3:	xx/xx/xx	B (Wooded areas/other)	
Pick Ticket:	---	Job No.:	---
Sales No.:	---	Acct No.:	---

Hatch Legend	
	Attic Room
	Volume Ceiling
	Stick Framing