

Harnett County Department of Public Health

PERMIT # SFD2312-0012

Operation Permit

New Installation Septic Tank Nitrification Line Repair Expansion

PROPERTY LOCATION: 256 ROBERT HOWE

Name: (owner) KB HOME RALEIGH SUBDIVISION BIRCHWOOD GROVE LOT # 56

System Installer: BRANTLEY

Basement with plumbing: Garage Number of Bedrooms 5

Type of Water Supply: Community Public Well Distance from well _____ feet

System Type: IIIb Types V and VI Systems expire in 5 years.

(In accordance with Table V a)

Owner must contact Health Department 6 months prior to expiration for permit renewal.

This system has been installed in compliance with applicable North Carolina General Statutes, Rules for Sewage Treatment and Disposal, and all conditions of the Improvement Permit and Construction Authorization.

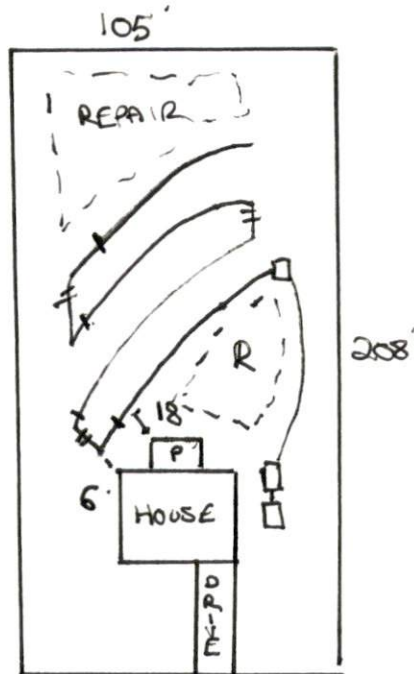

PERMIT CONDITIONS:

- I. Performance: System shall perform in accordance with Rule .1961.
- II. Monitoring: As required by Rule .1961.
- III. Maintenance: As required by Rule .1961. Other: _____
Subsurface system operator required? Yes No

If yes, see attached sheet for additional operation conditions, maintenance and reporting.

IV. Operation: _____

V. Other: THIS IS A FLOW REDUCTION SYSTEM

D-Box Pump Alarm H2O Line PWR Line

Following are the specifications for the sewage disposal system on the above captioned property.

Type of system: Conventional Other Pump To EZ Flow Septic Tank: 1250 gallons Pump Tank: 1250 gallons

Subsurface Drainage Field: No. of ditches 1 exact length of each ditch 405 feet width of ditches 3 feet depth of ditches 18 inches

French Drain Required: _____ Linear feet

Authorized State Agent _____

REHS

Date 2/9/24