

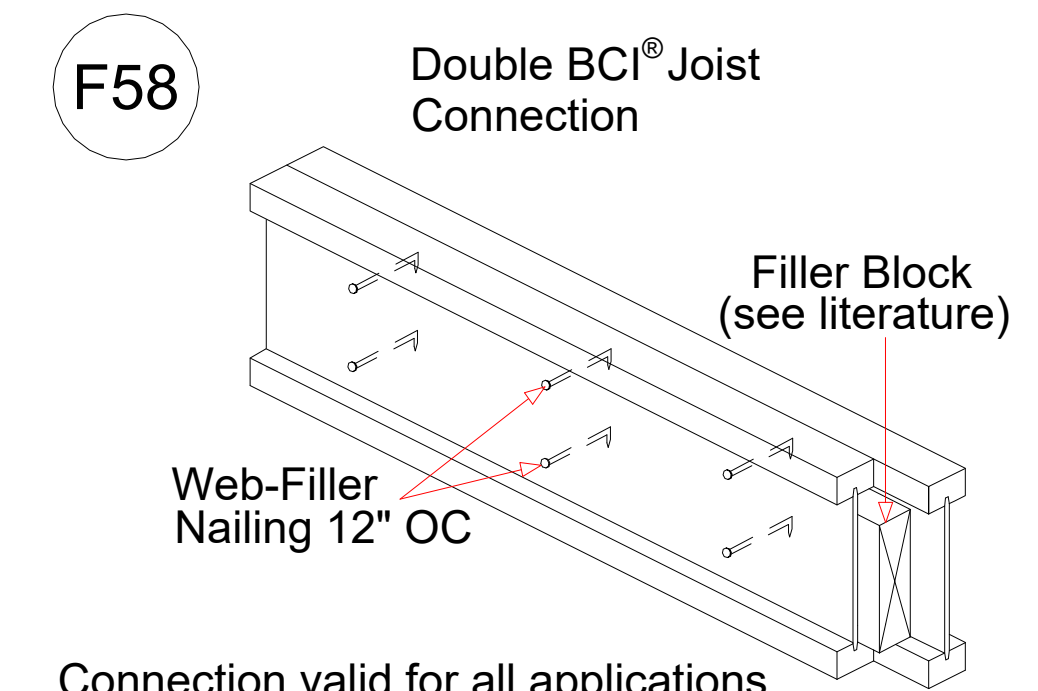

Connector Summary			
Qty	Manuf	Product	Flange
1	Simpson	HHUS410	None
3		HUC3514	None
13	Simpson	IUS2.37/14	None
3	Simpson	MIT3514-2	None

Products				
PlotID	Length	Product	Plies	Net Qty
J2-1	27'-00'-00	14" BCI® 6000s-1.8	1	3
J2-2	27'-00'-00	14" BCI® 6000s-1.8	2	4
J2-3	21'-00'-00	14" BCI® 6000s-1.8	1	5
J2-4	21'-00'-00	14" BCI® 6000s-1.8	2	2
J2-5	18'-00'-00	14" BCI® 6000s-1.8	1	31
J2-6	13'-00'-00	14" BCI® 6000s-1.8	1	4
J2-7	9'-00'-00	14" BCI® 6000s-1.8	1	2
J2-8	6'-00'-00	14" BCI® 6000s-1.8	1	7
J2-9	6'-00'-00	14" BCI® 6000s-1.8	2	2
BM2-1	8'-00'-00	1-3/4" x 9-1/2" VERSA-LAM® 2.0 3100 SP	2	2
BM2-2	10'-00'-00	1-3/4" x 11-7/8" VERSA-LAM® 2.0 3100 SP	2	2
BM2-3	10'-00'-00	1-3/4" x 14" VERSA-LAM® 2.0 3100 SP	2	2
BM2-4	8'-00'-00	1-3/4" x 14" VERSA-LAM® 2.0 3100 SP	2	2
BM2-5	22'-00'-00	1-3/4" x 18" VERSA-LAM® 2.0 3100 SP	3	3
Rim1	12'-00'-00	1-1/8" x 14" BC RIM BOARD OSB	1	17
Blk1	2'-00'-00	14" BLOCKING	1	35

Connect all 2-ply joists in the field per detail F58.



Connection valid for all applications. Contact Boise EWP Engineering for specific conditions.

FOR PERMIT

Client: **MATTAMY HOMES-RALEIGH**
 Job: **LOT 11 PROVIDENCE CREEK**
 Plan Information: **SHENANDOAH-CR**
 OPTIONS

Date: DATE
 Job #: 23-8202-J02
 Sales Rep: KYLE GIBSON
 Phone:

▲ = LEFT END OF TRUSS

REVISIONS:



Moncks Corner/Easley, SC (800) 475-3999
 Sparta, NC (336) 372-2226