

#62

Sheet:
 Property ID:
 Lot #:
 File #:
 Code:

**SOIL/SITE EVALUATION
 for ON-SITE WASTEWATER SYSTEM**

Owner: GALT Applicant:

Address: 83 Rush Ln
 Proposed Facility: SFD

Date Evaluated: 12-15-23
 Design Flow (.1949): 480 GPD
 Property Recorded:

Property Size:

Location of Site:
 Water Supply: Public Individual Well Spring Other
 Evaluation Method: Auger Boring Pit Cut
 Type of Wastewater: Sewage Industrial Process Mixed

P R O F I L E #	.1940 Landscape Position/ Slope %	Horizon Depth (In.)	SOIL MORPHOLOGY		OTHER PROFILE FACTORS				Profile Class & LTAR
			.1941		.1942 Soil Wetness/ Color	.1943 Soil Depth (IN.)	.1956 Sapro Class	.1944 Restr Horiz	
			.1941 Structure/ Texture	.1941 Consistence Mineralogy					
1	L	0-20	LS	Fc/NSP/NXP	10YR 7/1	>48"	-	-	PS.4
	5-7%	20-48	SC1	Fc/SSP/SP	≥36"				
2	L	0-20	LS	Fc/NSP/NXP	10YR 7/2	>48"	-	-	PS.4
	5-7	20-49	SC1	Fc/SSP/SP	≥32"				

Description	Initial System	Repair System	Other Factors (.1946): Site Classification (.1948): <u>PS</u> Evaluated By: <u>M. H. REHS</u> Others Present:
Available Space (.1945)	<input checked="" type="checkbox"/>	<input checked="" type="checkbox"/>	
System Type(s)	<input checked="" type="checkbox"/>	<input checked="" type="checkbox"/>	
Site LTAR	<u>.4</u>	<u>.4</u>	

COMMENTS: _____

LANDSCAPE POSITIONS	GROUP	TEXTURES	.1955 LTAR	CONSISTENCE MOIST	WET
R-RIDGE	I	S-SAND	1.2 - 0.8	VFR-VERY FRIABLE	NS-NON-STICKY
S-SHOULDER SLOPE		LS-LOAMY SAND			
L-LINEAR SLOPE	II	SL-SANDY LOAM	0.8 - 0.6	FI-FIRM	S-STICKY
FS-FOOT SLOPE		L-LOAM			
N-NOSE SLOPE	III	SI-SILT	0.6 - 0.3	VFI-VERY FIRM	VS-VERY STICKY
H-HEAD SLOPE		SIL-SILT LOAM			
CC-CONCLAVE SLOPE		CL-CLAY LOAM			
CV-CONVEX SLOPE		SCL-SANDY CLAY LOAM			
T-TERRACE	IV	SIC-SILTY CLAY	0.4 - 0.1	EFI-EXTREMELY FIRM	NP-NON-PLASTIC
FP-FLOOD PLAN		C-CLAY			
		SC-SANDY CLAY			SP-SLIGHTLY STICKY
					P-PLASTIC
					VP-VERY PLASTIC

STRUCTURE

- SG-SINGLE GRAIN
- M-MASSIVE
- CR-CRUMB
- GR-GRANULAR
- SBK-SUBANGULAR BLOCKY
- ABK-ANGULAR BLOCKY
- PL-PLATY
- PR-PRISMATIC

MINERALOGY

- SLIGHTLY EXPANSIVE
- EXPANSIVE

Show profile locations and other site features (dimensions, references or benchmark, and North)

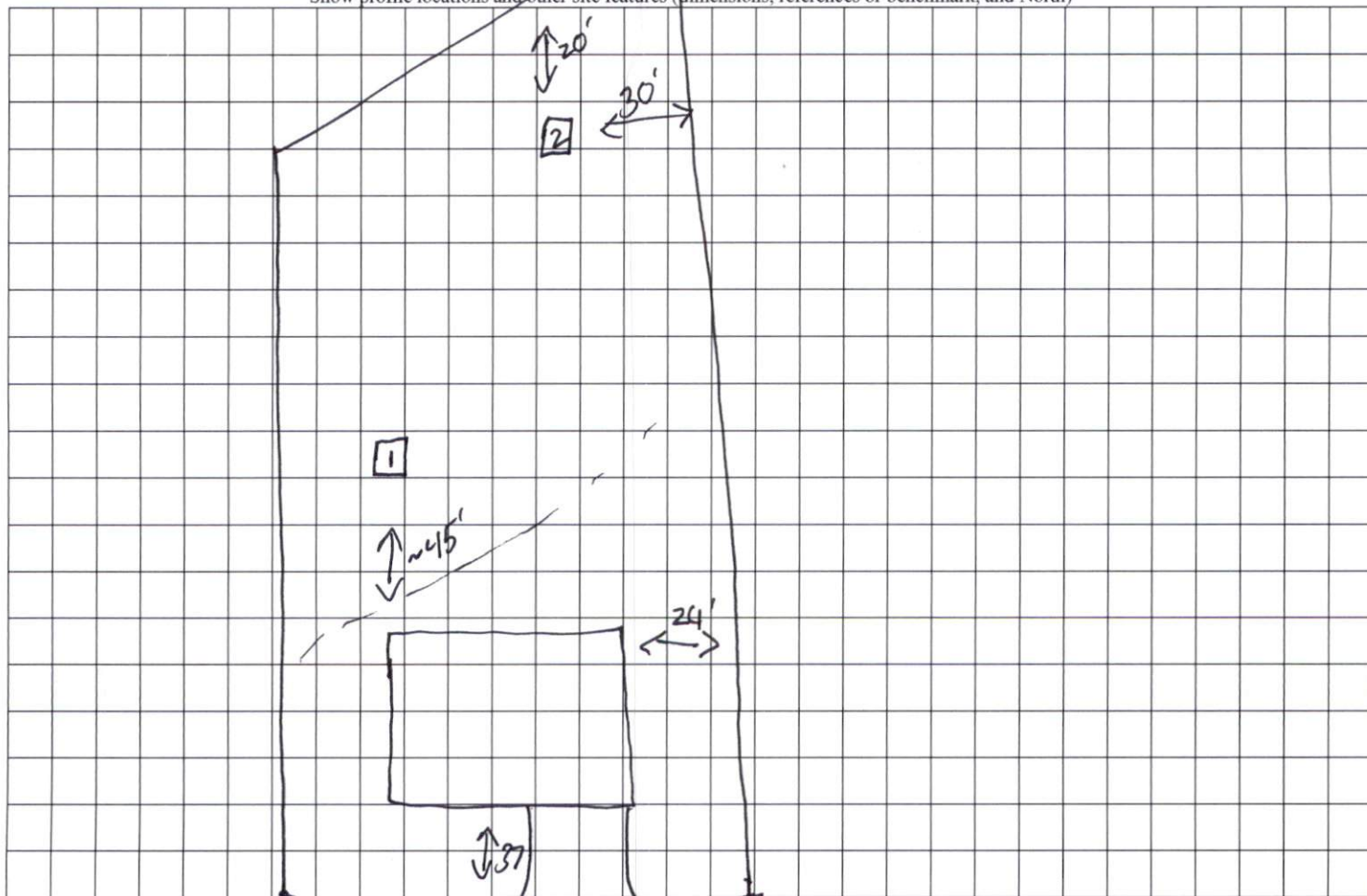

Sears Dr